

KITCHEN - EXTRA STORAGE

Ideas for More Storage - More Freedom!



Technik für Möbel

Hettich



MORE
STORAGE

MORE
CONVENIENCE



Kitchens are called upon to store everything from food and cooking equipment to pots, pans, small appliances, and more. Cabinet accessories, which can be implemented upon installation or after, work wonders in organizing the kitchen clutter.



Significance of storage spaces in your kitchen

Kitchen is the heart of a home. A good amount of time is spent in the kitchen. From cooking to dining, if one has a dining table in the kitchen, many things need to be handled. Crockery, food supplies, appliances etc. need to be organized and placed perfectly. This indicates the importance of storage space.

Below are the five significant points for importance of storage spaces in kitchen:



Ease in cooking

It is extremely stressful to cook in a cluttered kitchen. With utensils and kitchen ingredients in different places, it takes that much more effort and time to cook one's favourite meal. A good storage space will ensure that everything is organised and available at an arm's length. The counter top will remain clutter-free and cooking will be easier and faster.

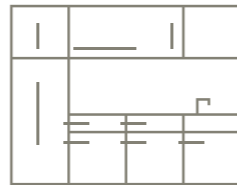

Effective utilization of limited space

Every inch of space matters in a small kitchen. Hence creating storage spaces in such kitchens requires smart thinking and smart fittings. This can help in optimum utilization of the available kitchen space.

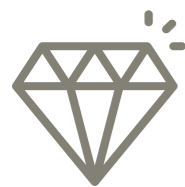

Space equals status quotient

Having a well-designed & organized space is a sign of a luxurious home. A good kitchen cabinet space helps store all kitchen supplies leaving outer kitchen space to be free of clutter. More the space, higher the rank on status quotient.



Increase the value of your home

A well-laid out and intelligently designed kitchen makes it look spacious and clutter-free. This helps to improve the overall appeal of the house and its value as well.



Security

Apart from the basic function of storing kitchen supplies, kitchen storage also provides security for all goods. Proper storage ensures that goods last long. Moreover, kitchen remains accident-free, caused otherwise due to cluttered kitchen.



Storage Patterns

Stories from everyday kitchen life...



Food storage



Preparing food



Storage containers

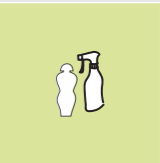

Cleaning agents & waste

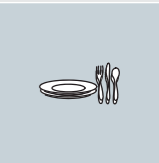

China and cutlery

'Intelligent Kitchens' is a revolutionary concept that provides one with a well-organised kitchen along with benefits of short distances and efficient, ergonomic work flows. This IdeaBook showcases how this concept can be implemented using a variety of kitchen layouts.



<https://intelligentkitchens.hettich.com/en/intelligent-kitchens.html>

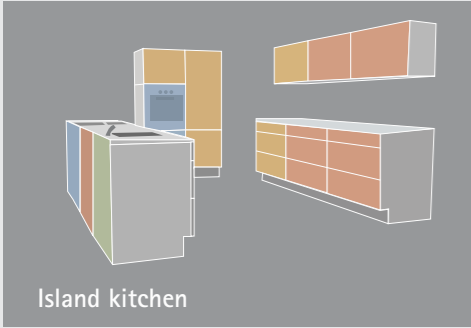

Island kitchen



Gallery kitchen

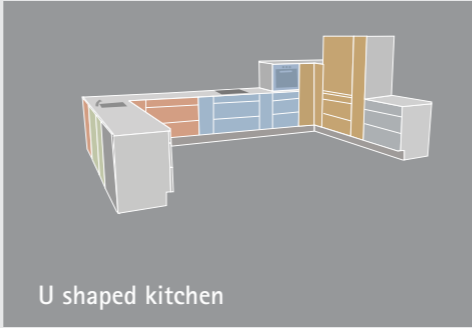

U shaped kitchen

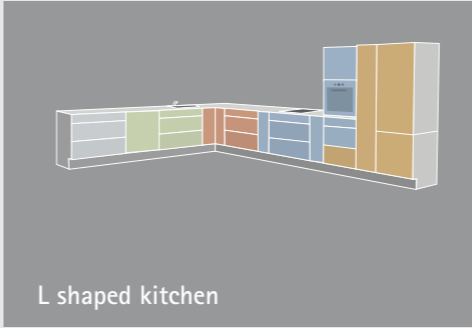

L shaped kitchen



Straight kitchen

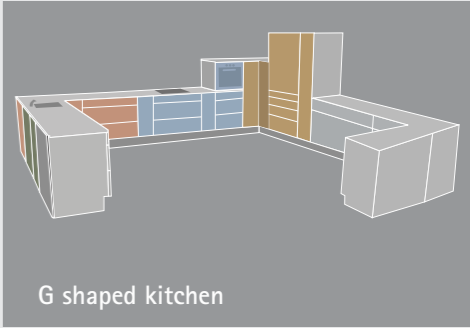

G shaped kitchen





SEMPlice

Simple yet effective

Keep it simple..
Pamper yourself with maximum storage
with premium fittings and easy functioning,
making it hassle-free.



BELOW COUNTER STORAGE

Furniture featuring glass elements bring a breath of elegance to any kitchen. With its narrow bonding surfaces, Sensys hinges create a perfect look for glass applications.

FITTINGS USED

- ArciTech Drawer System
- Sensys Hinge
- Lift Advanced HF (Folding flap fitting)

CMF USED

Ivory & Emerald Green
Matte finish



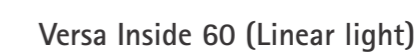
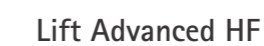
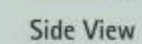
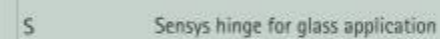
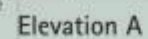

LUMINA

Highlight what matters

Simple lines and effective storage designed with best suited Hettich fittings, making working in kitchen joy throughout the day!



PANTRY CUPBOARD

Spices, dry goods, and other cooking essentials are stored in a pull-out pantry. This keeps them tucked away, but still provides easy access.

FITTINGS USED

- Atira Drawer System
- CargoMan Corner Solution
- Cargo IQ 200 Bottle Pull-Out

CMF USED

Black, Yellow & Oak Wood
Matte finish



ATPU

600

600

Extra Storage

S	Sensys Hinge for Shutter
ATS	Innotech Atira powder coated steel-Silver (70/470mm)
ATSR	Innotech Atira powder coated steel-Silver with Railing(144/470mm)
ATSD	Innotech Atira powder coated steel-Silver with DesignSide(144/470mm)
ATS-I	Innotech Atira powder coated steel-Silver Internal Drawer (70/470mm)
ATSD	Innotech Atira powder coated steel-Silver Internal Drawer (144/470mm)
OT610	OrgaTray 610
OT240	OrgaTray 240
OS240	OrgaStore 240
OS400	OrgaStore 400
OFGB	OrgaFlag Basic Set
US	Under Sink Drawer
OC	Open Cabinet
CM-LH	Cargoman-450mm (LH) with Blind Corner Hinge
MC-RH	Moving Corner Cargo Series-RH
C200	Cargo IQ200-150mm (Bottle P/Out) with Quadro Runner
NBU	Narrow Base Unit-150mm (70 & 144/470)mm
OC	Open Cabinet
P20	Push to Open

ATPU	Innotech Atira Pantry Unit-600mm with Wide Angle Hinge
ATS-I	Innotech Atira powder coated steel-Silver Internal Drawer(70/470)mm
ATSR-I	Innotech Atira powder coated steel-Silver Internal Drawer with Railing (144/470)mm
LEG	Lano SQ 30 (100 mm)

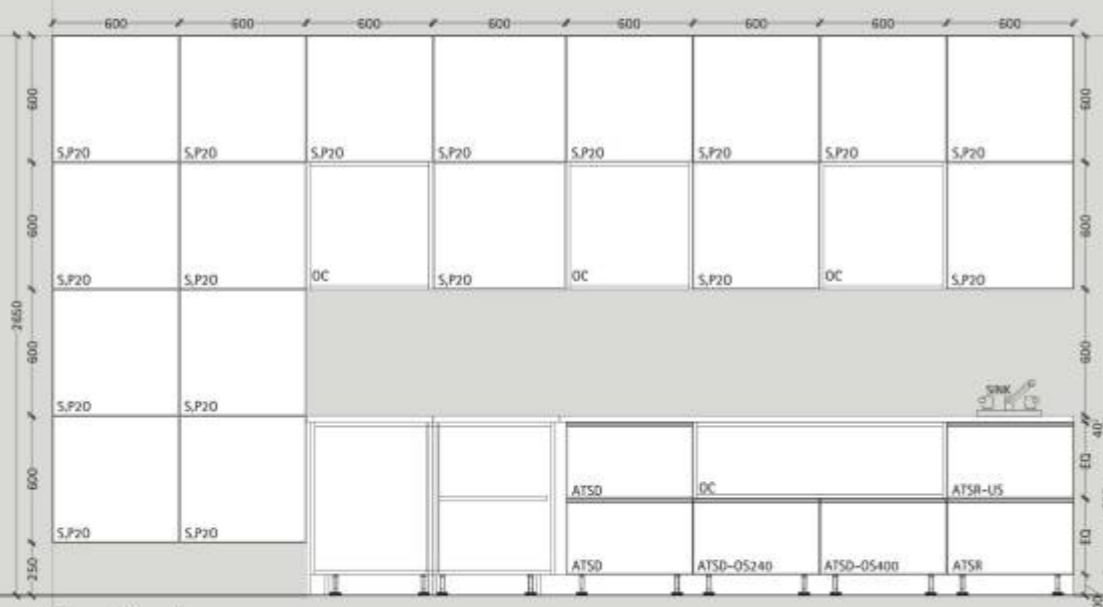

Side View



A pull-out cabinet containing various bottles of cooking oil and vinegar. The cabinet is white and has two shelves. The top shelf holds several bottles of cooking oil and vinegar. The bottom shelf holds more bottles, including some with red labels. The cabinet is open, showing the contents.



Lano SQ 30 (Leg)



BORDO

Bold and loud

Making your experience last a lifetime with huge storage options coupled with proper detailing for smooth functioning.



PULLOUT ORGANIZER

Storage space in perfection. Optimum use of the available storage space is assured; all supplies and utensils are stored in well organized fashion and with in easy reach.

FITTINGS USED

- CargoTech Drawer System
- Sensys Hinge
- Cargo Duo Pantry Unit

CMF USED

White & Beige
Matte finish

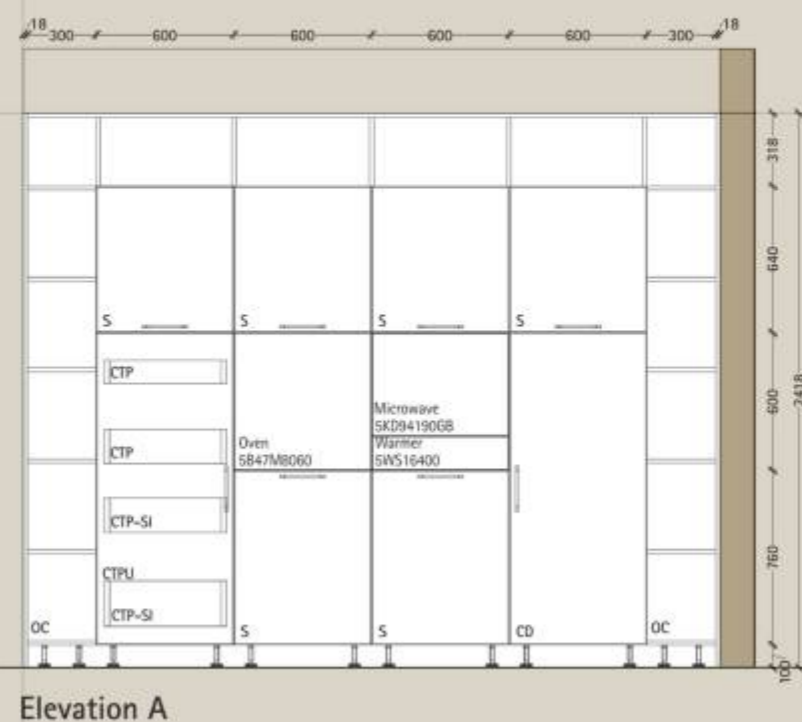

S	Sensys Hinge for Shutter
CTP	CargoTech Plain (536wX500dX100ht)mm with Quadro Runner
CTP-CT	CargoTech Plain with Cutlery Inlet (536wX500dX100ht)mm with Quadro Runner
CTP-CSI	CargoTech Plain with Cup Et Saucer Inlet (536wX500dX150ht)mm with Quadro Runner
CTP-SI	CargoTech Plain with Seperator Inlet (536wX500dX150ht)mm with Quadro Runner
CTP-TI	CargoTech Plain with Thali Inlet (536wX500dX200ht)mm with Quadro Runner
CTP-PI	CargoTech Plain with Plate Inlet (536wX500dX200ht)mm with Quadro Runner
QT440	OrgaTray 440
RBH	Round Bin Holder 200 Series
M/U	Microwave Tall Unit-600mm
O/U	Oven Tall Unit-600mm
CTPU	CargoTech Pantry Unit-600mm with Wide Angle Hinge
CTP-SI	CargoTech Plain with Seperator Inlet (536wX500dX200ht)mm with Quadro Runner
CD	Cargo Duo-600mm (4-Tier) with Wide Angle Hinge
OC	Open Cabinet

CTPU	CargoTech Pantry Unit-600mm with Wide Angle Hinge
CTP-SI	CargoTech Plain with Separator Inlet (536wX500dX200ht)mm with Quadro Runner
CTP	CargoTech Plain (536wX500dX100ht)mm with Quadro Runner
LEG	Lano SQ 30 (100 mm)

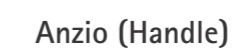

Drawers and Hinges

You'll love it when all of the drawers and hinges close gently, effortlessly and quietly in your kitchen. Hettich's extensive range of Drawer Systems and Hinges provide just the right blend of functionality and aesthetics.





PRIMO

Eternal silence

Having a premium touch to your space with top notch fittings and a beautiful sense of style.



SIDE STORAGE

Utilise spaces with side storage. Next to the island always keep whole space neat and tidy.

FITTINGS USED

- ArciTech Drawer System
- Wicker Basket
- Bin-It Classic

CMF USED

Green & White
Matte finish

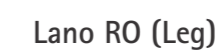
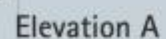



FINESSE

Personal touch

Make it your own through a combination of innovative Hettich fittings for corner storage and other kitchen spaces coupled with elegant profile handles.



SEATING CUM STORAGE

A seating arrangement that adds extra capacity and storage space to your kitchen, seating cum storage unit is the perfect solution for your kitchen space.

FITTINGS USED

- InnoTech Drawer System
- CargoMan Corner Solution
- Lift Advanced HK (Upward opening flap fitting)

CMF USED

Black & Oak Wood
Matte finish



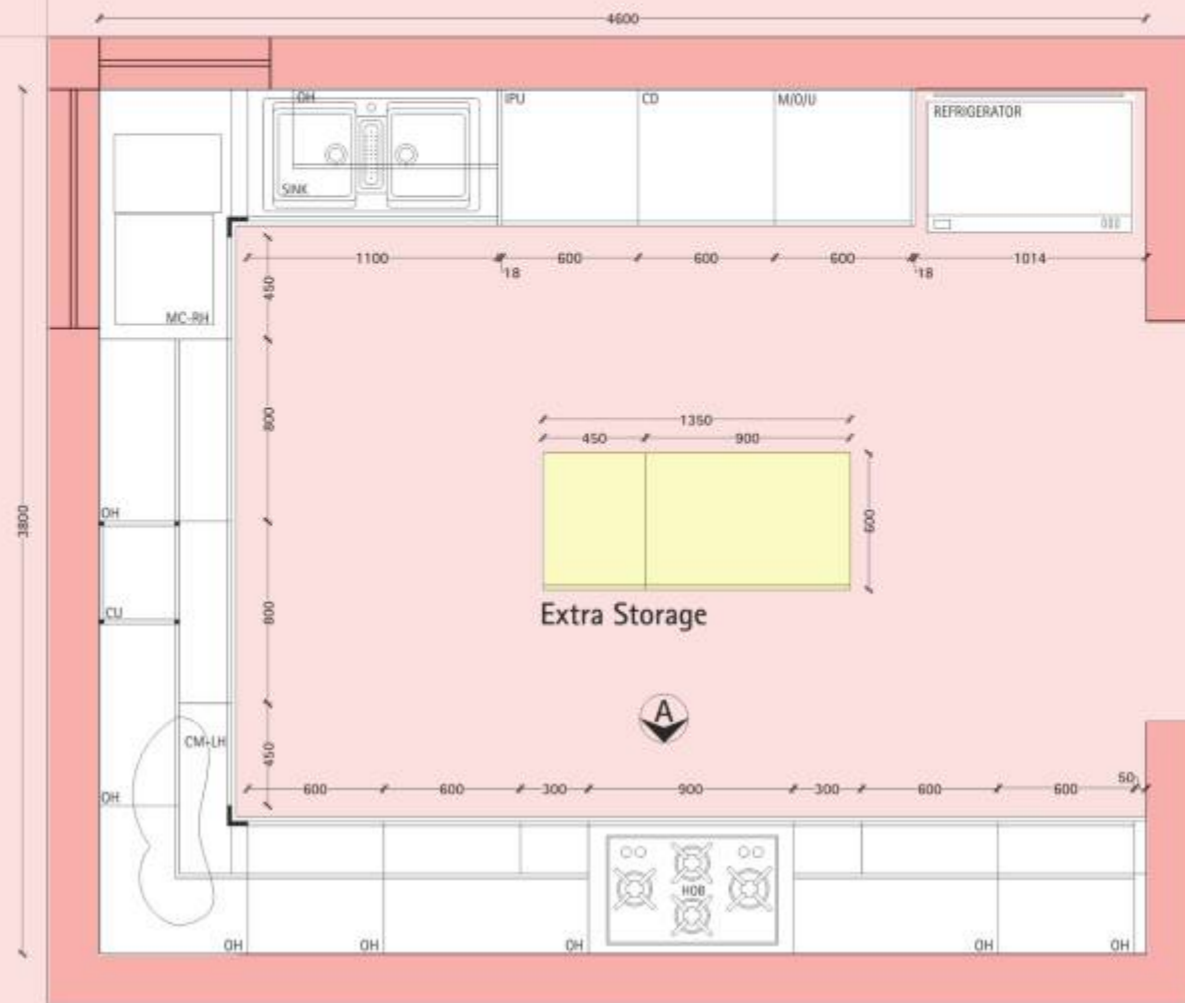

Plan

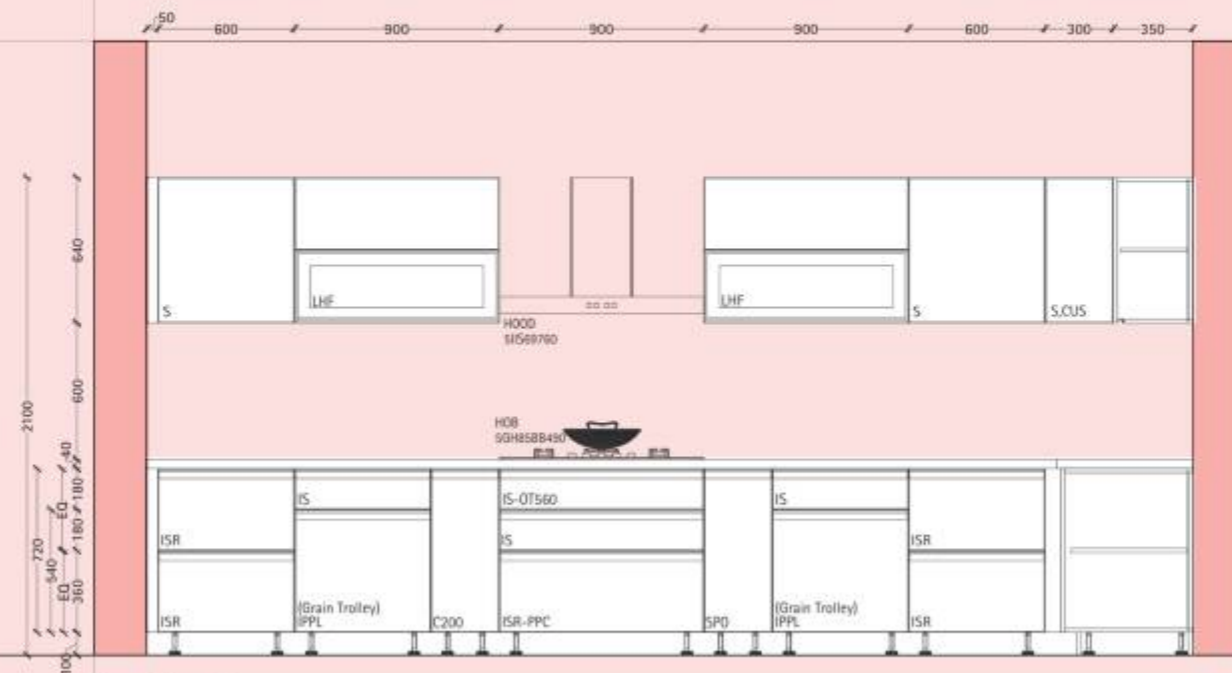

Elevation A

Legend

S	Sensys Hinge for Shutter
IS	Innotech powder coated steel-Silver (70/470mm)
ISR	Innotech powder coated steel-Silver with Railing(144/470mm)
IPPL	Innotech powder coated steel-Silver with Lengthwise Railing
IPPC	Innotech powder coated steel-Silver with Crosswise Railing
Ot560	OrgaTray 560
C200	Cargo IQ200-200mm (Bottle P/Out) with Quadro Runner
SPO	Spice P/Out-200mm with KA Runner
CM-LH	Cargoman-450mm(LH) with Blind Corner Hinge
MC-RH	Moving Corner Cargo Series-RH
BTC	Bin It Classic-13L (Waste Bin P/Out)
DH	Detergent Holder Cargo Series
WB	Wicker Basket-600mm (300mm)
IPU	Innotech Pantry Unit-600mm with Wide Angle Hinge
IS-I	Innotech powder coated steel-Silver Internal Drawer(70/470)mm
ISR-I	Innotech powder coated steel-Silver Internal Drawer with Railing (144/470)mm
CD	Cargo Duo-600mm (6-Tier) with Wide Angle Hinge
M/O/U	Microwave & Oven Tall Unit-600mm
OH	Overhead Storage
LHF	Folding Flap Fitting-Lift Advanced HF
LHK	Upward Opening Flap Fitting-Lift Advanced HK
CU	Cube-Black Matt with Wooden Shelf
CUS	Corner Unit with Shelf with Wide Angle Hinge

Extra Storage

ISD	Innotech powder coated steel-Silver with DesignSide(144/470mm)
S	Sensys Hinge for Shutter
Castor	Swivel castor with brake

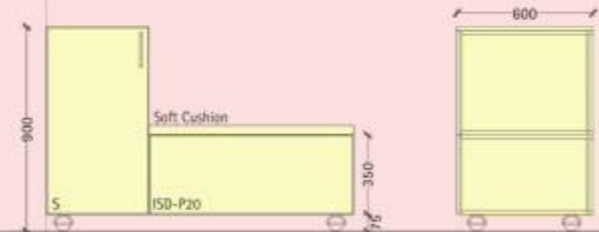

Front View

Side View



InnoTech Pot & Pan Drawer



Moving Corner



Sensys Hinge



Swivel Castor



LINEA

Keep it simple

Make your kitchen simple in design and high on aesthetics. Along with being highly functional and big on storage space made possible by smart Hettich kitchen fittings.



PORTABLE DISHWASHER CABINET

Portable Dishwasher Cabinet is just the ideal solution to ensure that washing up of the dishes does not become a hassle, especially during these Covid times.

FITTINGS USED

- CargoTech Drawer System
- Sensys Hinge
- Moving Corner

CMF USED

Black
Matte finish



Plan

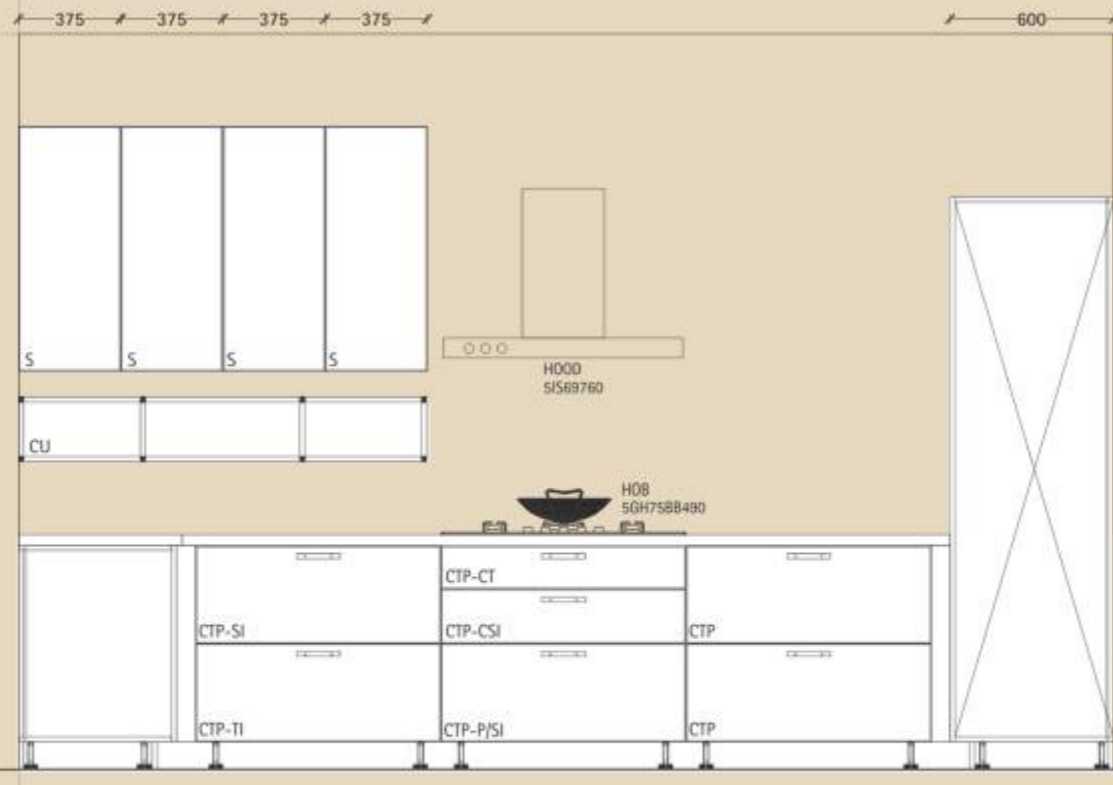

Elevation A

Legend

S	Sensys Hinge for Shutter
CTP	CargoTech Plain (836wX500dX200ht)mm with KA Runner
CTP-CT	CargoTech Plain with Cutlery Inlet (836wX500dX100ht)mm with KA Runner
CTP-CSi	CargoTech Plain with Cup & Saucer Inlet (836wX500dX150ht)mm with KA Runner
CTP-Si	CargoTech Plain with Separator Inlet (836wX500dX200ht)mm with KA Runner
CTP-Ti	CargoTech Plain with Thali Inlet (836wX500dX200ht)mm with KA Runner
CTP-P/Si	CargoTech Plain with Plate & Separator Inlet (836wX500dX200ht)mm with KA Runner
DH	Detergent Holder Cargo Series
RBH	Round Bin Holder 200 Series
M/U	Microwave Tall Unit-600mm
O/U	Oven Tall Unit-600mm
C500	Cargo500 Wire Basket Larder Unit-600mm with wide angle hinge
CM-RH	CargoMan-450mm (RH) with Blind Corner Hinge
MC-LH	Moving Corner Cargo Series-LH
OH	Overhead Storage
CUS	Corner Unit with Shelf with Blind Corner Hinge
CU	Cube-White with Wooden Shelf

Extra Storage

Dishwasher (with multiplug on top)



CargoTech Thali Inlet



Lemans



Apua (Handle)

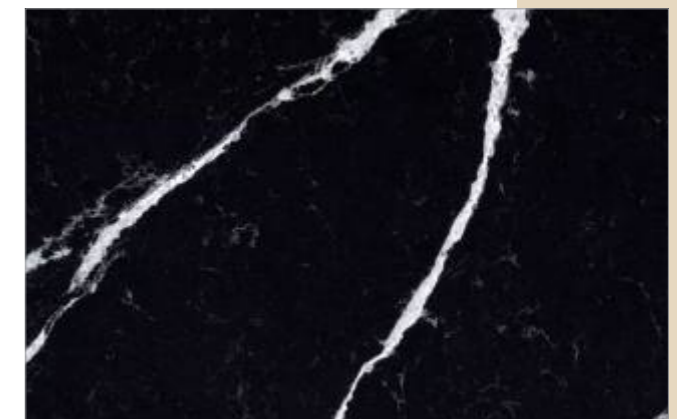

ET Marquina (Stone)

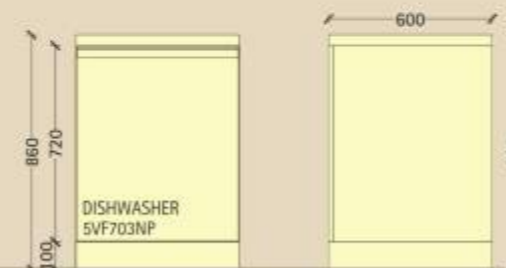

Front View

Side View

Wire Products



Hettich Cargo Wire Products help to organise your kitchen and give it an uncluttered look. The range consists of multiple products which help to create storage space out of dead spaces in kitchen. Made with stainless steel, these products come with a 10 year replacement warranty against rusting.





TATVA

Calmness identified

Creates an instant connection with the user with a perfect placid environment which allows you to make that perfect cup of morning tea.



ISLAND STORAGE

Easy to move when necessary, and get the most out of a kitchen island by adding shutter on sides for extra storage space.

FITTINGS USED

- ArciTech Drawer System
- WingLine L Sliding Folding Fitting
- CargoTech Drawer System

CMF USED

Black & Wood
Matte finish

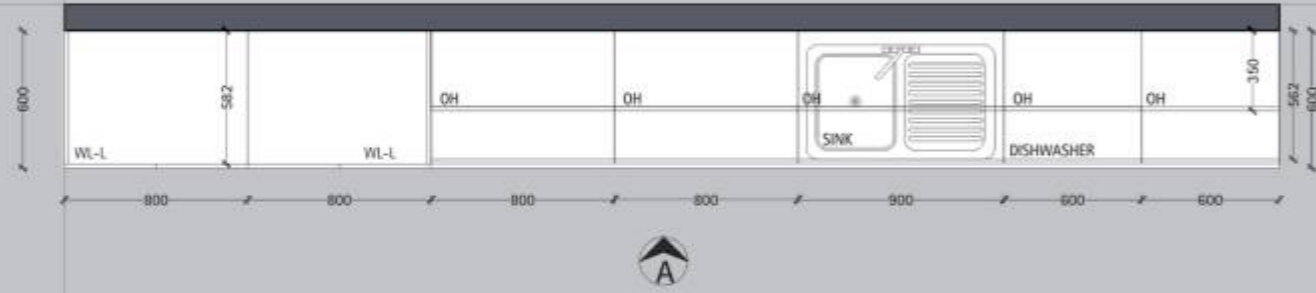

Extra Storage

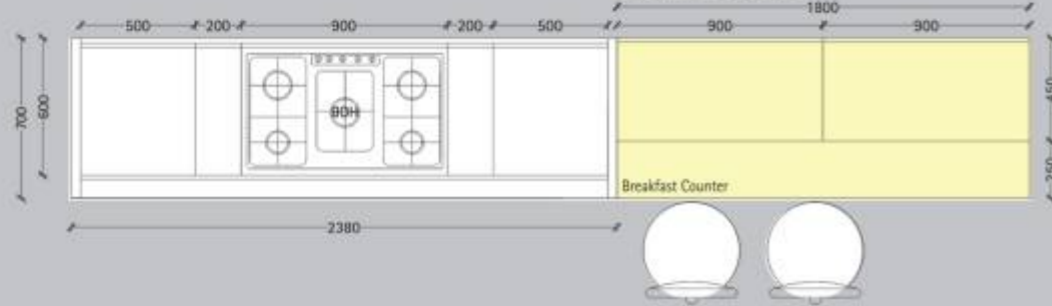

Plan

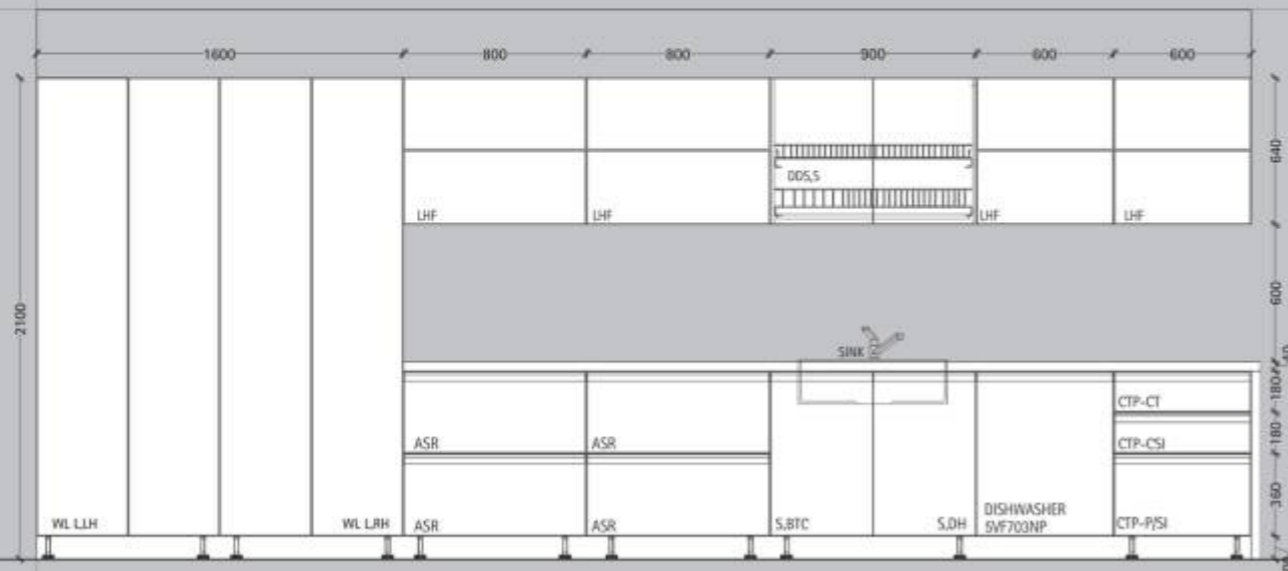

Elevation A

Legend

- S Sensys Hinge for Shutter
- AS ArciTech powder coated steel-Silver (94/500mm)
- OT570 OrgaTray 570
- ASR ArciTech powder coated steel-Silver with Railing(186/500mm)
- NBU Narrow Base Unit-300mm(94 & 186/500mm)
- CTP-CT CargoTech Plain with Cutlery Inlet (536wX500dX100ht)
- CTP-CSI CargoTech Plain with Cup & Saucer Inlet (536wX500dX150ht)
- CTP-P/SI CargoTech Plain with Plate & Separator Inlet (536wX500dX200ht)
- LHF Folding Flap Fittings-Lift Advanced HF
- WL-L WingLine L, Push to open

Extra Storage

- S Sensys Hinge for Shutter

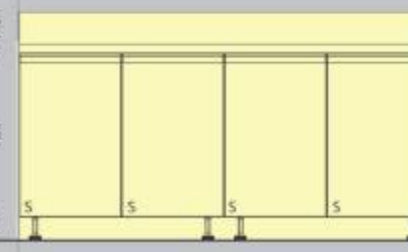

Front View

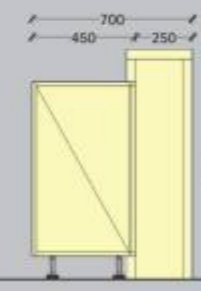

Side View



ArciTech Pot & Pan Drawer



Lift Advanced HF



Built-in dishwasher, fully integrated (5VF 703NP)

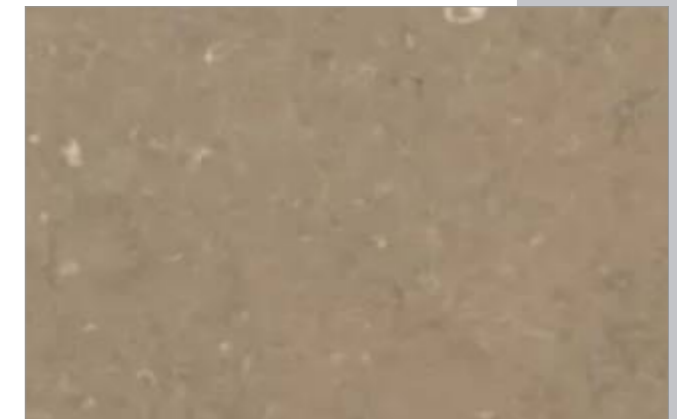

Coral Clay (Stone)





MINCHIN

Simple yet bold

Well balanced act between aesthetics and functionality. This concept revolves around minimalistic workflow with optimal space for storage.



MOVEABLE LARDER

Elevate your kitchen with a free-standing style. It's the perfect storage add-on to your kitchen space.

FITTINGS USED

- Atira Drawer System
- Moving Corner
- Sensys Hinge

CMF USED

Wood
Matte finish

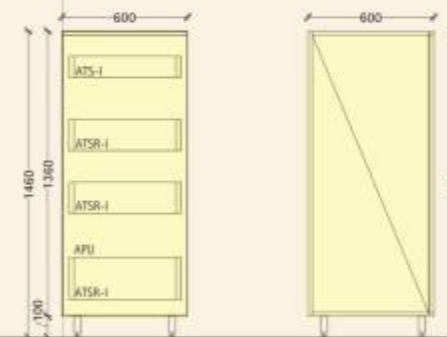
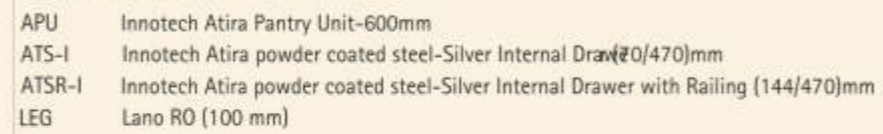

Built-in dishwasher, integrated (5VI 702XP)

ALTO

Classic and elegant

The amalgamation of classic design and expert aesthetics crafted with Hettich fittings is what defines this kind of kitchen. The kitchen is designed to have ample storage space without impinging on its elegance.



ISLAND BOX

Get the most out of a kitchen island by adding drawers on sides for extra storage space. The backless stools help transition the kitchen to the dining room and are easy to move when necessary.

FITTINGS USED

- ArciTech Drawer System
- Cargo Carousel M Corner Solution
- Sensys Hinge

CMF USED

Black & Wood
Matte finish

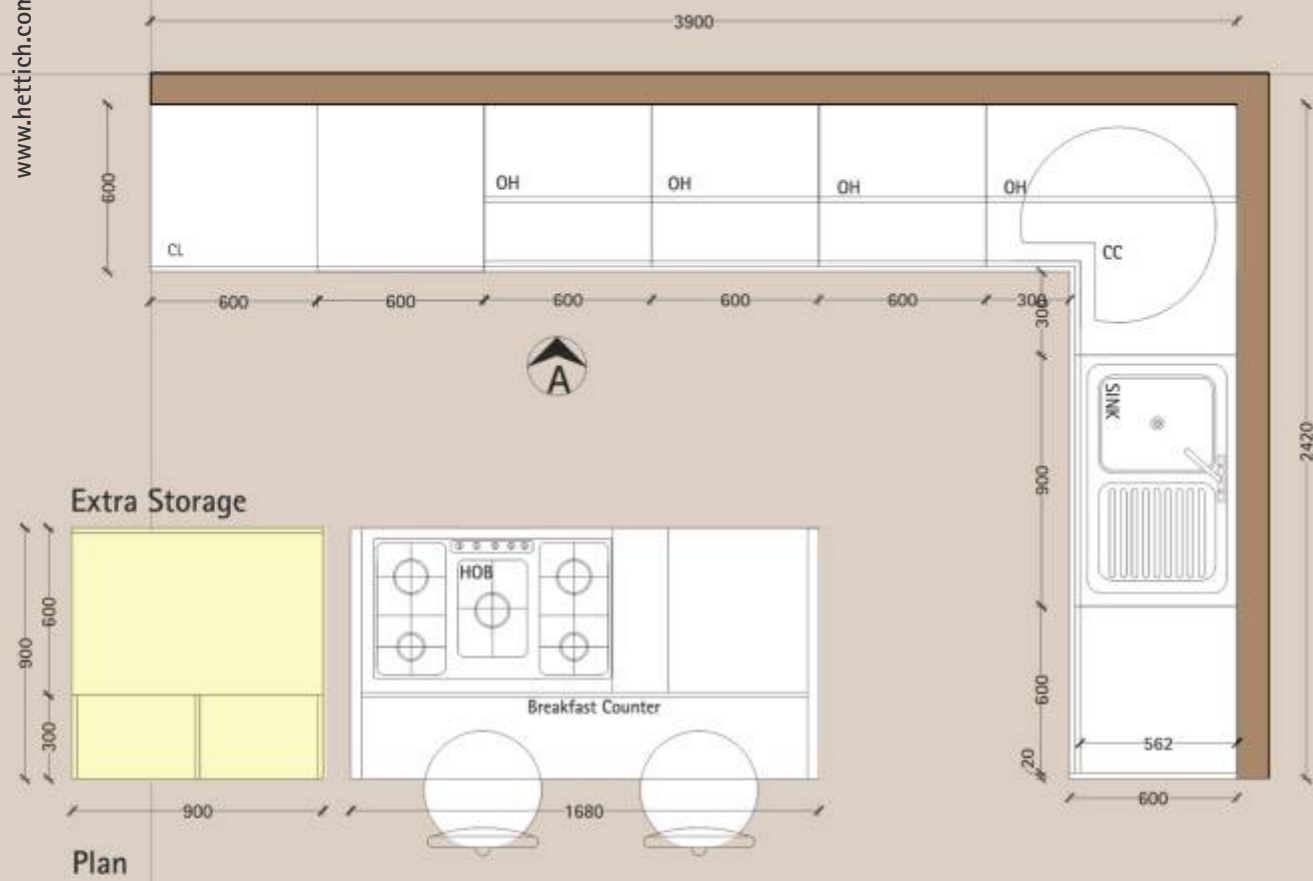

Plan

Legend

S	Sensys Hinge for Shutter
AS	ArciTech powder coated steel-Silver (94/500mm)
OT570	OrgaTray 570
ASR	ArciTech powder coated steel-Silver with Railing(186/500mm)
SPO	Spice Pullout
C200	Cargo IQ 200
CC	Cargo Carousel (900x900mm)
WB	Wicker Basket- 210/600 mm
DDS	Dish Drainer Set- 900 mm with 165 degree hinge
LHF	Lift Advance HF (Folding Flap Fitting)
M/O/U	Microwave Et Oven Tall Unit

Extra Storage

ASR	ArciTech powder coated steel-Silver with Railing(186/500mm)
OC	Open cabinet



Cargo Carousel



Cargo Portable Dish Drainer



Versa Plus 60 (Linear light)

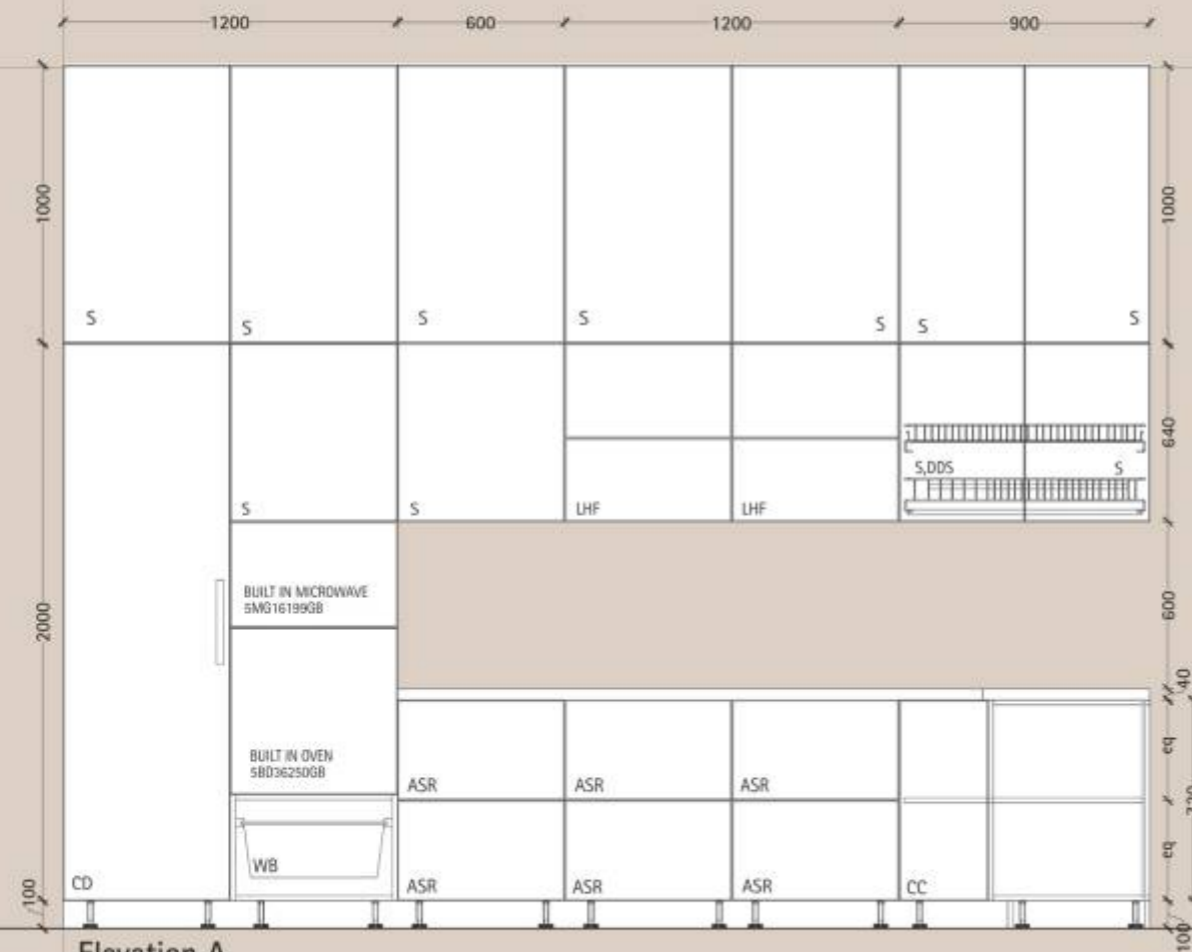

Elevation A

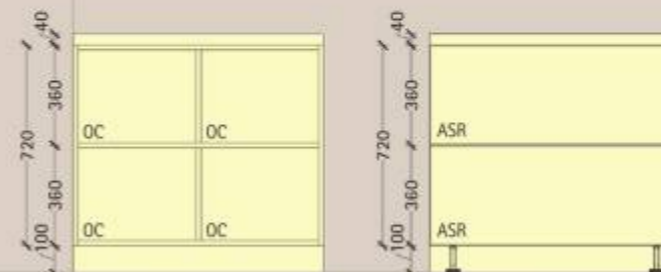

Front View

Back View



ArciTech Pot & Pan Drawer

Appliances & Stones

Built-in-Appliances and Stones marketed by Hettich help to contemporarize the kitchen and bring it to life. Blaupunkt built-in appliances balance looks and functionality to create unique appliances concepts to power kitchens.

Silestone characterizes the bold yet sophisticated look with the finest quality of quartz stones for luxurious counter-tops in kitchen.

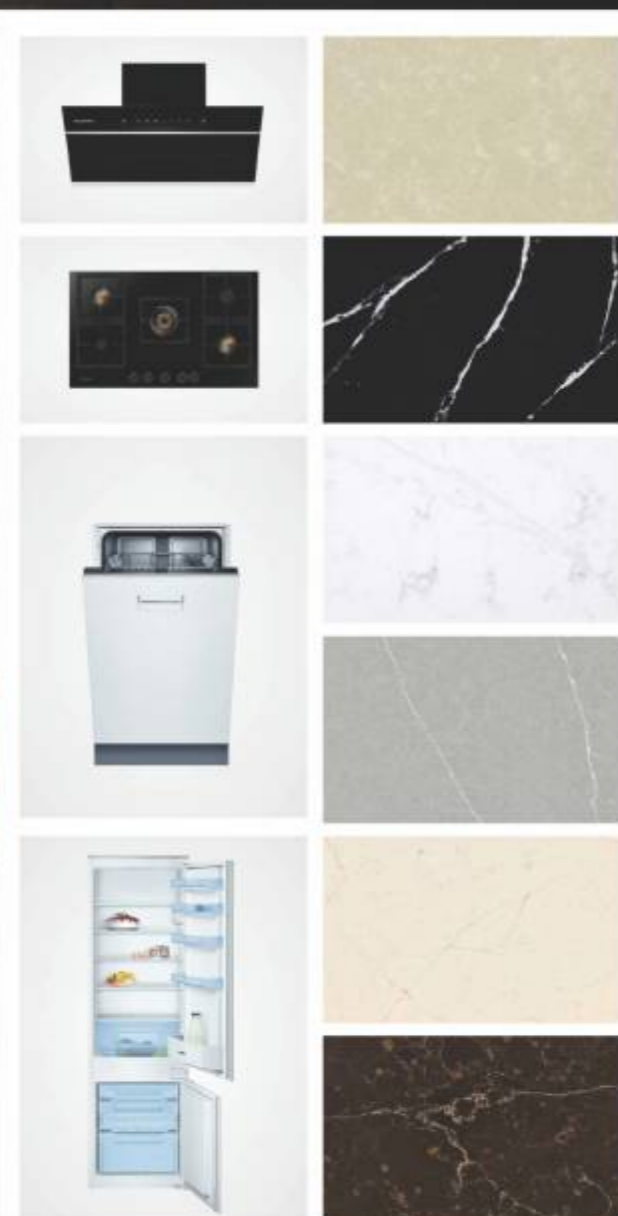



KOSMOS

A fondest memory

With earthy tones of slabs and shutters, free-flowing wind, area for natural light and ignition for cooking, Kosmos combines the five elements making it the ideal kitchen for everyone.



CUBE SHELVING CABINET

Cube on. Clutter gone.
Good height storage unit, which makes for a far less bulky appearance.

FITTINGS USED

- ArciTech Drawer System
- WingLine L Sliding Folding Fitting
- Dish Drainer Set

CMF USED

Brown & White
Matte finish



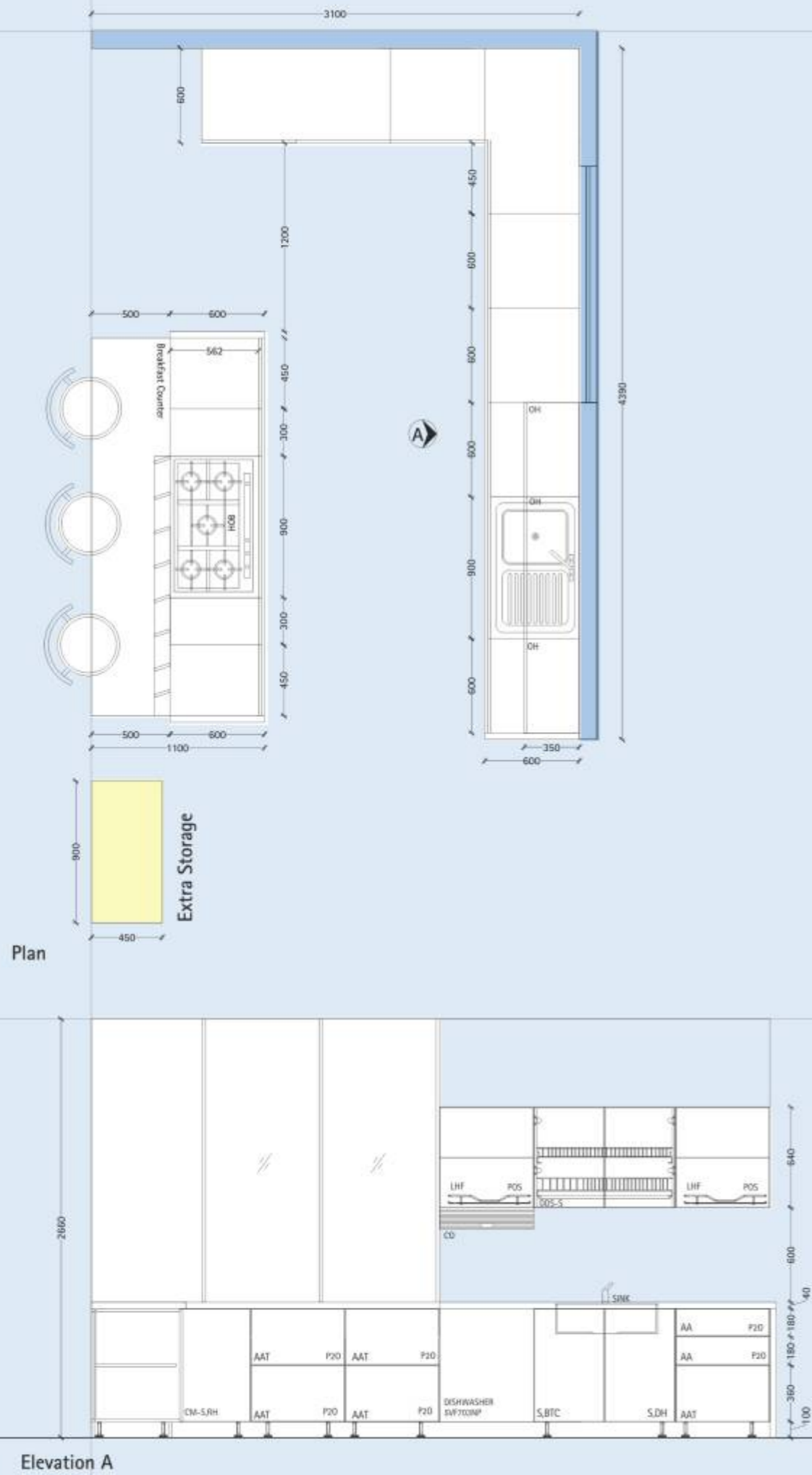

Legend

- AA ArciTech powder coated steel-Anthracyte (94/500mm)
- AAT ArciTech powder coated steel-Anthracyte with TopSide (186/500mm)
- BTC Bin IT. Classic - 13L (Waste bin p/out)
- DH Detergent Holder Cargo Series
- M/O/U Microwave & Oven Tall Unit
- OH Overhead Cabinet
- LHK Flap Fittings-Lift Advanced HK
- LHF Folding Flap Fittings-Lift Advanced HF
- CO Carousel - 600mm
- WL-L WingLine L Pantry Unit
- SLM SlideLine M
- P20 Push To Move

Extra Storage

- CU Cube-Black Matt with Glass Shelf
- S Sensys Hinge for Shutter



ArciTech Pot & Pan Drawer



Moving Shelf



Cosario



Cadro - Black Finish



TRANSIENT

Ever changing lifestyle

Immerse yourself in the spacious and ever changing kitchen, with time and sounds of waves hitting the shore, making the space dramatic and adding depth to your surrounding. Made with Hettich's most prime fittings, this kitchen gives a huge storage success.



SIDE CABINET

For storage solutions for the side of your island. it may be worth thinking of sides of the island as equally important work stations.

FITTINGS USED

- ArciTech Drawer System
- Obsidian Hinge
- ArciTech Pantry Unit

CMF USED

Black
Matte finish

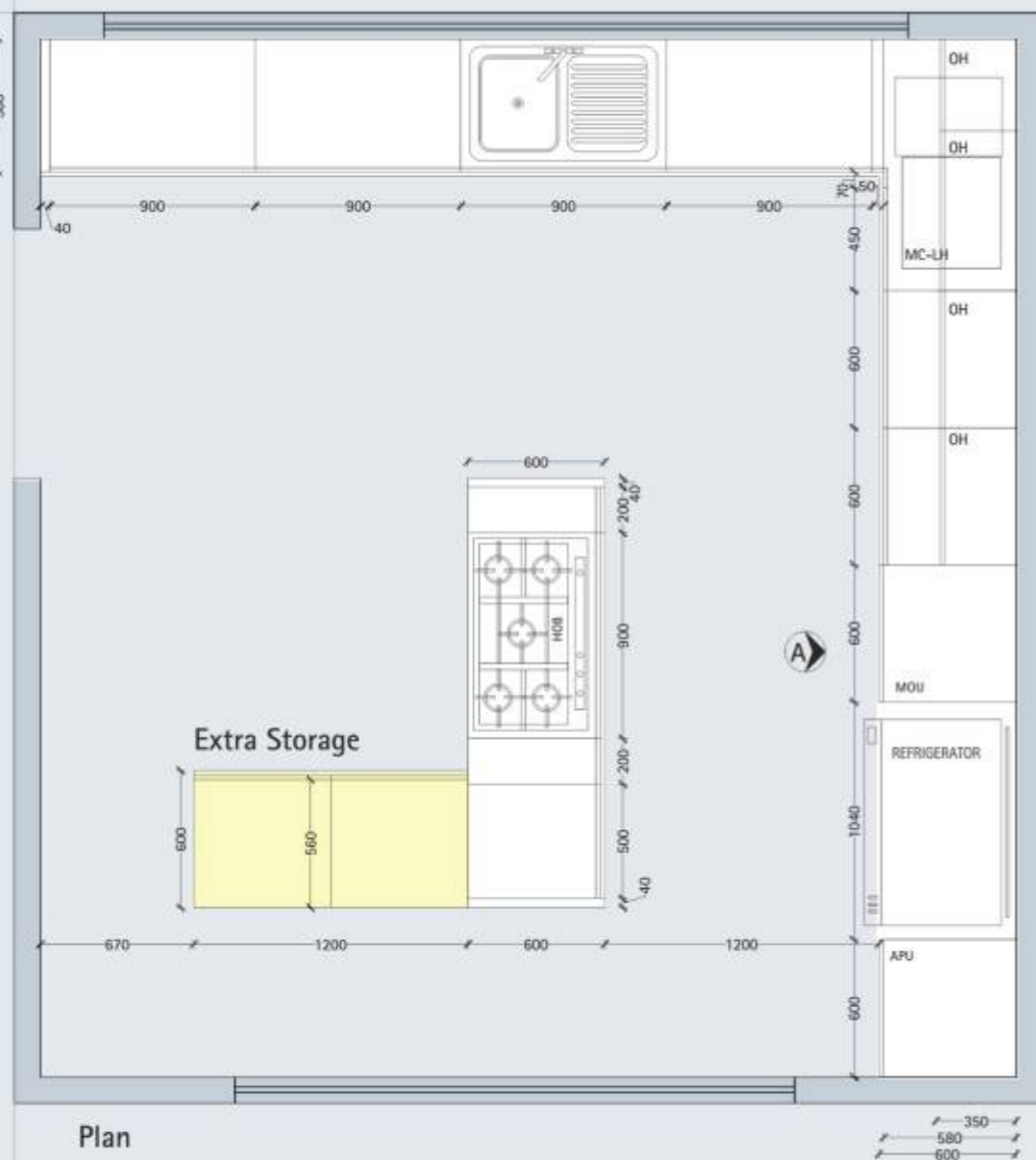

Legend

- P20 Push To Move
- AA ArciTech powder coated steel-Anthracite (94/500mm)
- OT230 OrgaTray 230
- AAT ArciTech powder coated steel-Anthracite with TopSide (186/500mm)
- APU ArciTech Pantry Unit -600mm with Internal front
- NBU Narrow Base Unit-300mm(94 & 186/500mm)
- MC Moving Corner -450mm, Right Hand
- OH Overhead Cabinet
- OB Obsidian Hinge for Shutter
- M/O/U Microwave & Oven Tall Unit

Extra Storage

- S Sensys hinge for shutter
- AAT ArciTech powder coated steel-Anthracite with TopSide (186/500mm)



ArciTech Pot & Pan Drawer



Comfort Spin



Gas Hob (5GH 85BB590)



Euro (Leg)

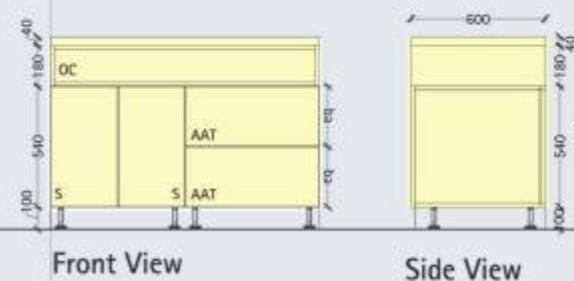
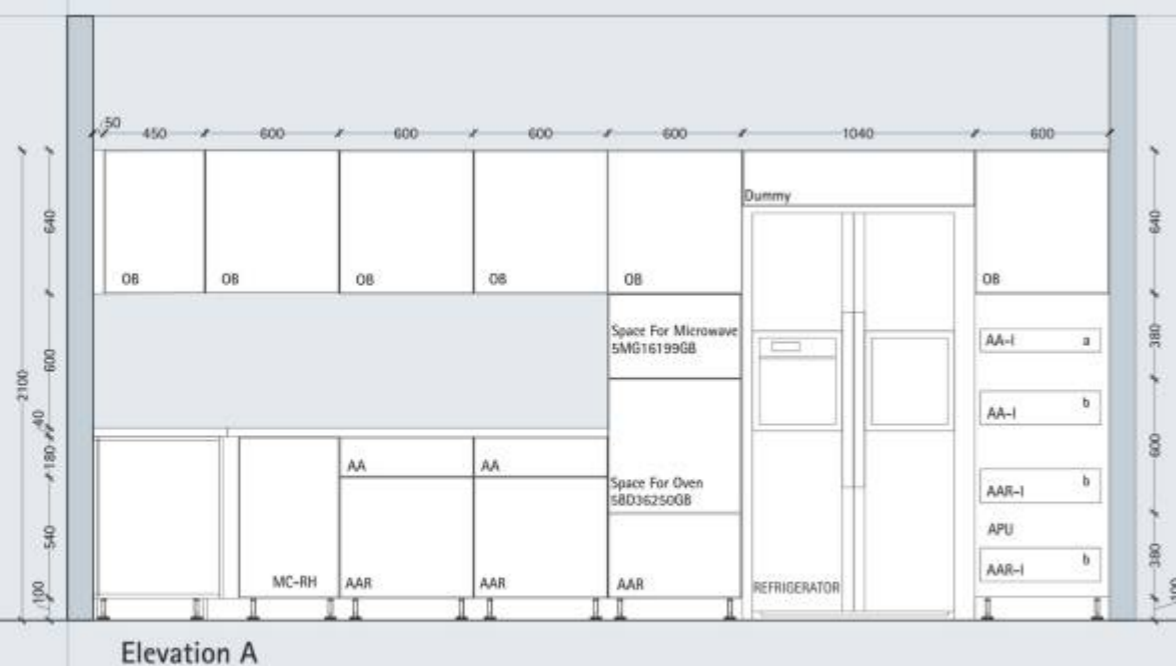



CALDO

A contrasting outlook

Engage yourself with a pragmatic experience of duality and premium fittings, which in turn captures your creative self.



SHELVING STYLE

Shelving unit are perfect for organizing kitchen. Storage shelves make the most of space while providing easy access.

FITTINGS USED

- Atira Drawer System
- Cadro Shelving System
- Cargo IQ 200 Bottle Pull-Out

CMF USED

Grey & Wood
Matte finish

Handles

Express your personality with the wide range of handles which come in different finishes and shapes. Make every touch count.





MARCHIO

Ecstasy re-defined

Small spaces lead to huge possibilities. Make your space come alive with premium Hettich fittings and surreal countertop designs, which makes your space stand out.



CONSOLE STORAGE

Whatever be the size of your kitchen, every little thing matters when it comes to storage. A simple console increases display space for plates, bowls and art.

FITTINGS USED

- InnoTech Drawer System
- Cargo Duo Pantry Unit
- Lift Advanced HF (Folding flap fitting)

CMF USED

White & Wood
Matte finish

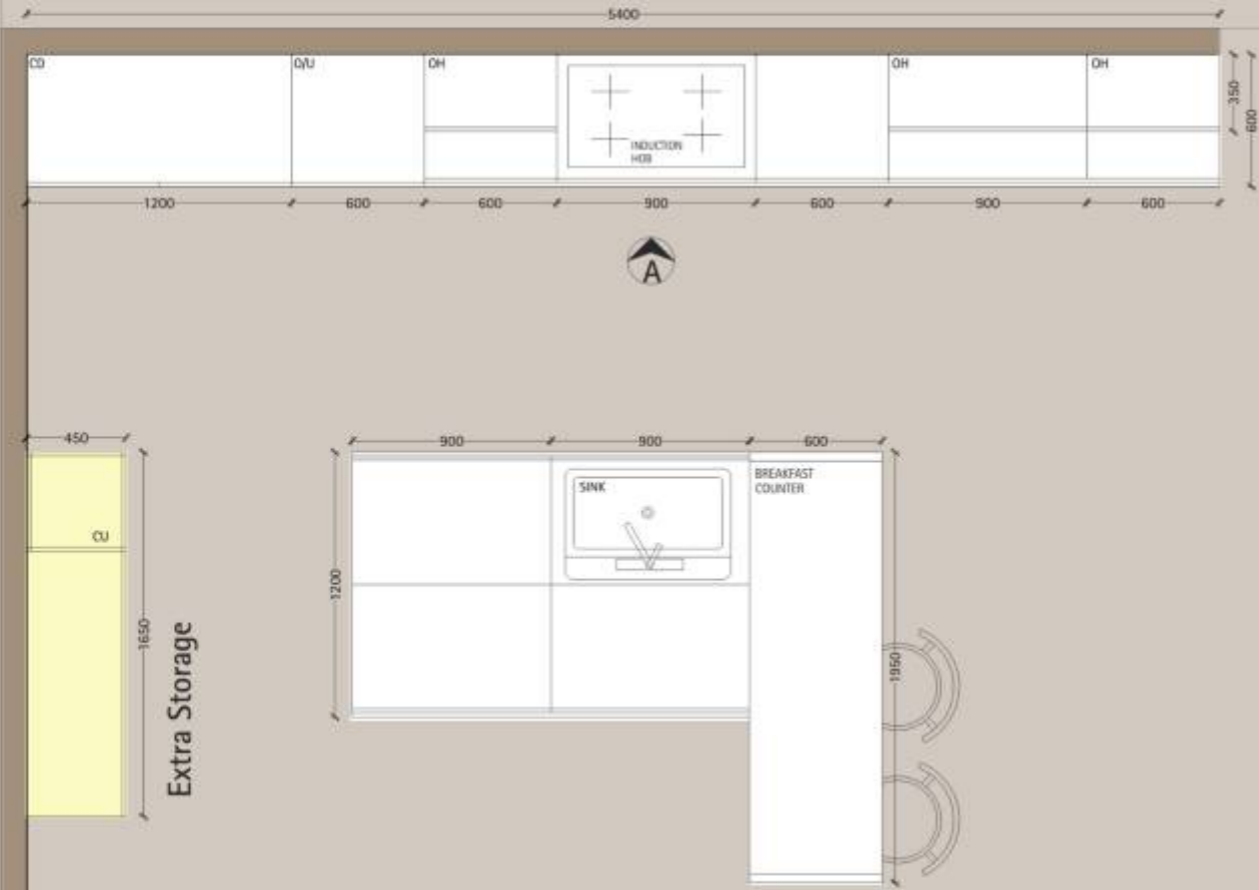

Plan

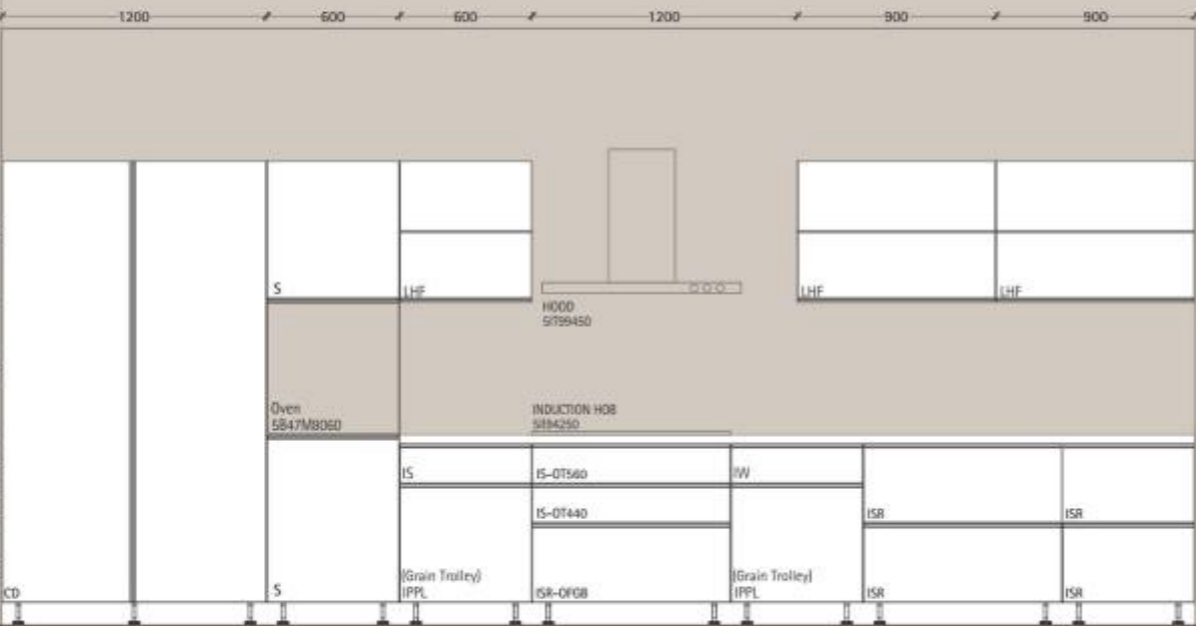

Elevation A

Legend

- S Sensys Hinge for Shutter
- IS Innotech powder coated steel-Silver (70/470mm)
- ISR Innotech powder coated steel-Silver with Railing(144/470mm)
- IPPL Innotech powder coated steel-Silver with Lengthwise Railing
- Ot560 OrgaTray 560
- OT440 OrgaTray 440
- OFGB OrgaFlag Basic Set
- W300 Pull Out Bin Holder W300
- W600 Pull Out Bin Holder W300
- CD Cargo Duo-600mm with 165 degree hinge
- O/U Oven Tall Unit-600mm
- OH Overhead Storage
- LHF Folding Flap Fitting-Lift Advanced HF

Extra Storage

- AC Actro 5d runner for darwers
- CU Cube with Black Matt Finish



Front View

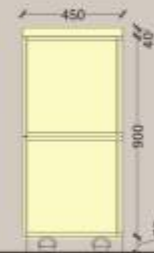

Side View



OrgaTray 560



OrgaFlag



Cargo Duo



Actro Runner





GREZZO

Simplicity defined

Creating a unique play of elements, which intermingle with high quality and space saving fittings which makes your work a pleasure!



KITCHEN DIVIDER

The prettiest items are displayed on open shelves and other essentials can be tucked away in the cabinets. The colour matching adds a sense of rhythm to the kitchen.

FITTINGS USED

- CargoTech M Drawer System
- CargoMan M Corner Solution
- Spice Pull Out

CMF USED

Sea Green & White
Matte finish

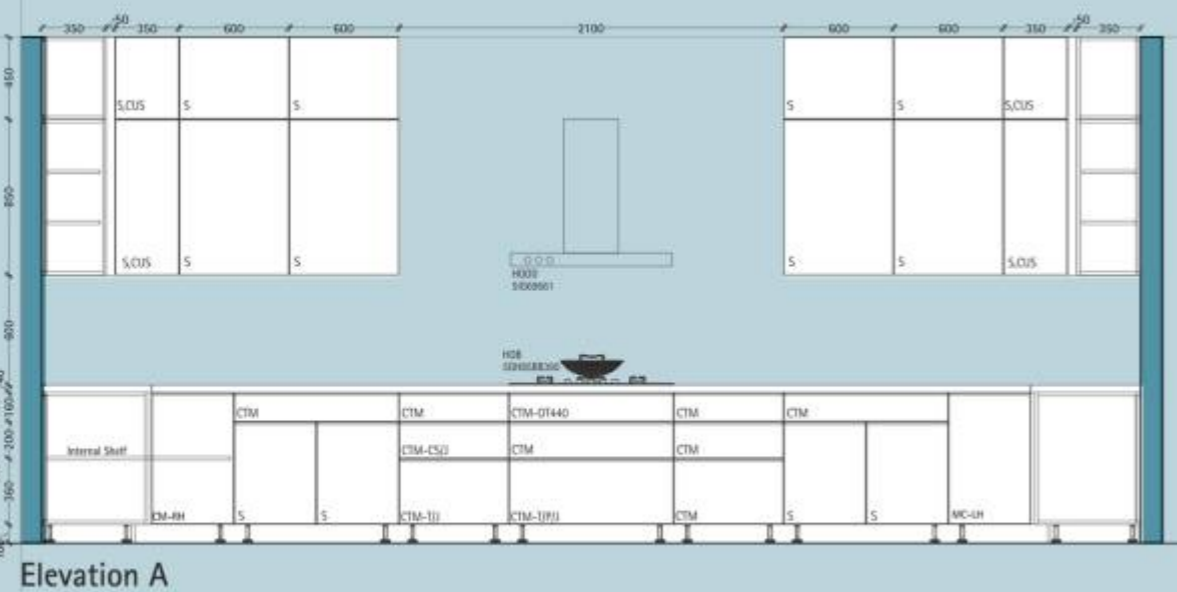

Legend

- S Sensys Hinge for Shutter
- CTM CargoTech M Plain Basket(536 & 836wX500dX100ht)mm with KA Runner
- CTM-CS/J CargoTech M Cup & Saucer/Jar Basket (536wX500dX100ht)mm with KA Runner
- CTM-T/J CargoTech M Thali/Jar Basket (536wX500dX200ht)mm with KA Runner
- CTM-T/P/J CargoTech M Thali/ Plate/ Jar Basket (836wX500dX200ht)mm with KA Runner
- OT440 OrgaTray 440
- CMM-RH CargoMan M-450mm (RH) with Blind Corner Hinge
- MC-LH Moving Corner Cargo Series-LH
- RBH Round Bin Holder 200 Series
- DH Detergent Holder Cargo Series
- M/O/U Microwave & Oven Tall Unit-600mm
- SPO Spice P/Out-300mm with KA Runner
- C300 Cargo IQ300-300mm (Bottle P/Out) with KA Runner
- WB Wicker Basket-600mm (120/210/300)mm
- OH Overhead Storage
- CUS Corner Unit with Shelf with Blind Corner Hinge

Extra Storage

- TDC Telescopic Drawer Channel
- SL56 SlideLine 56, Sliding fitting
- H Glass Hinge with 8mm thk glass
- GS Glass Shelf

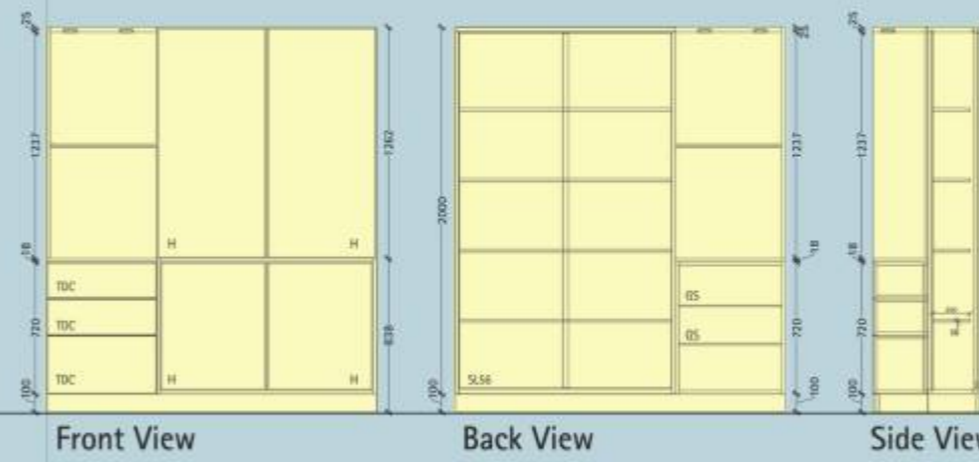

CargoTech M Cup & Saucer/Jar Basket



Cargo IQ 300



Telescopic Runner



SlideLine 56 (Sliding Fitting)





PREMIO

Simple yet dynamic

Equipped with high-end furniture fittings allowing you to perform various functions simultaneously without any hindrance, enhancing your work style.



TALL UNIT

In the modern monochrome kitchen, the tall unit stored dinnerware on sleek shelf embellished with sensory lights enhances the whole kitchen with extra storage.

FITTINGS USED

- ArciTech Drawer System
- Sensys Hinge
- WorkTop Extension

CMF USED

Grey & Wood
Matte finish



AA-I	Arcitech Anthracite -Internal drawer
OT	Orga tray 570
AAR	Arcitech Anthracite with Railing -Pot & Pan drawer
AAD	Arcitech Anthracite with DesignSide -Pot & Pan drawer
APU	Arcitech Pantry Unit Anthracite with Internal Drawers
W600	Pull Out Bin Holder W 600
S	Sensys Hinge
P20	Push To open
C200	Cargo IQ 200 with Quadro -450mm
OC	Open Cabinet
WTE	WorkTop Extension

H	Glass Hinge with 8mm thk glass
AAR-I	ArciTech -Anthracite Internal Drawer with Railing
LEG	Lano SQ 30 (100 mm)
S,P20	Sensys Hinge with push to open

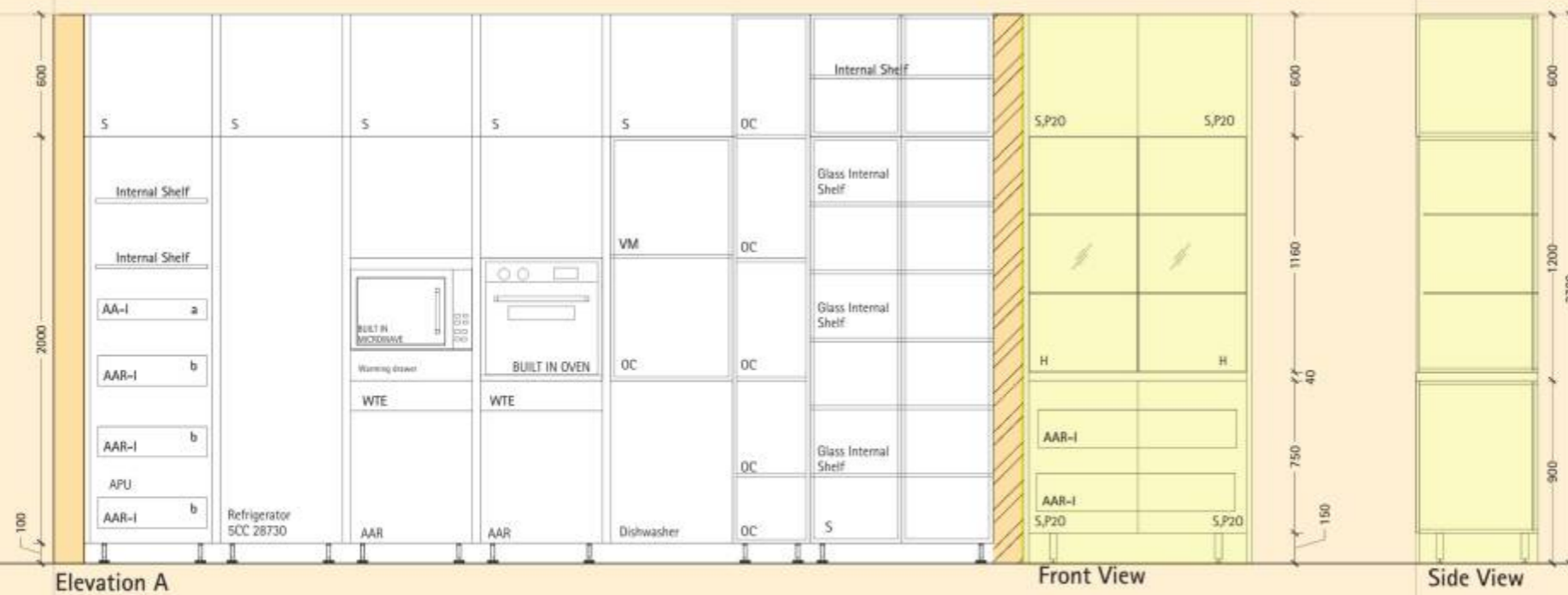
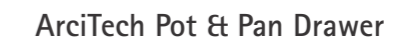

Lighting

A lot of your time is spent in the kitchen and hence HALEMEIER has designed lights that allow you to simply switch over – from functional work light to cosy ambience lighting around the dinner table.

HALEMEIER Lighting Solutions can be installed wherever good lighting is needed – in ceilings, under cupboards, over worktops, in pull-out kitchen units and even along plinths, turning your kitchen into the favourite room in the home, full of atmosphere and life.

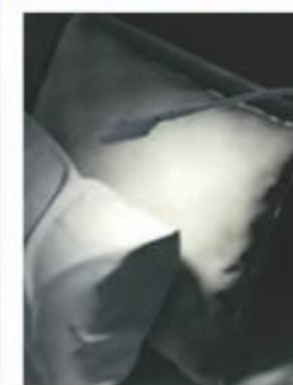

LEGNA

Consumed with passion

Let your passion speak and create magic with Hettich's spacious and effective fittings, utilizing all nooks and corners while making it user-friendly.



SPACE SAVER
Cabinets aren't limited to bedrooms. Add one in your kitchen for massive storage which functionally organizes your things.

FITTINGS USED

- InnoTech Drawer System
- Crago Larder Pantry Unit
- CargoMan Corner Solution

CMF USED
Grey & Wood
Matte finish



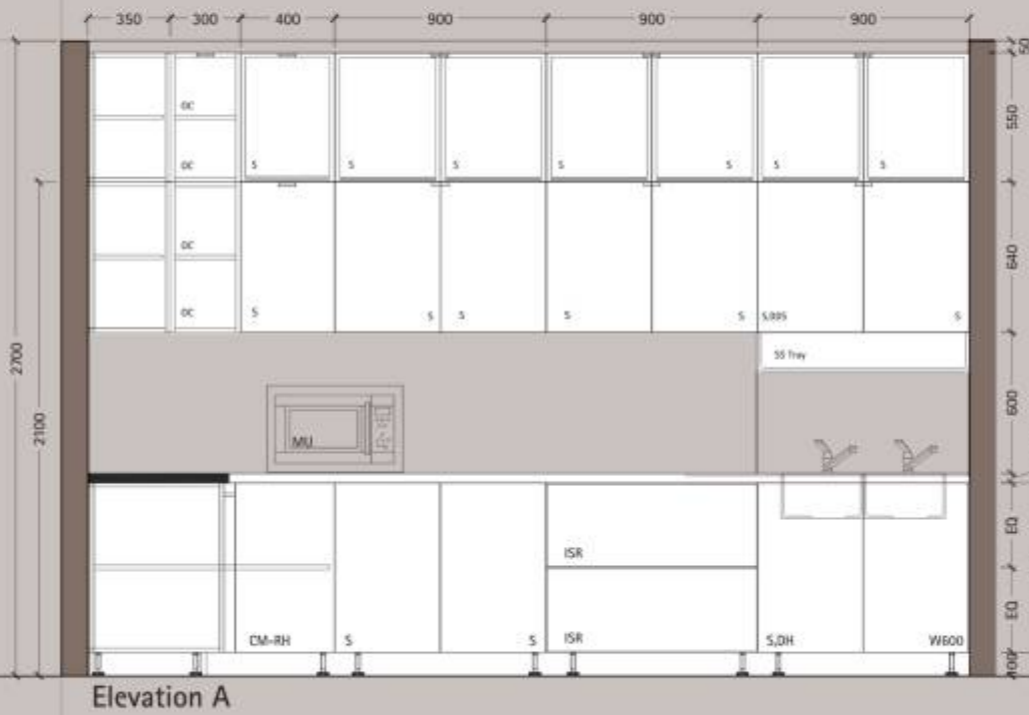
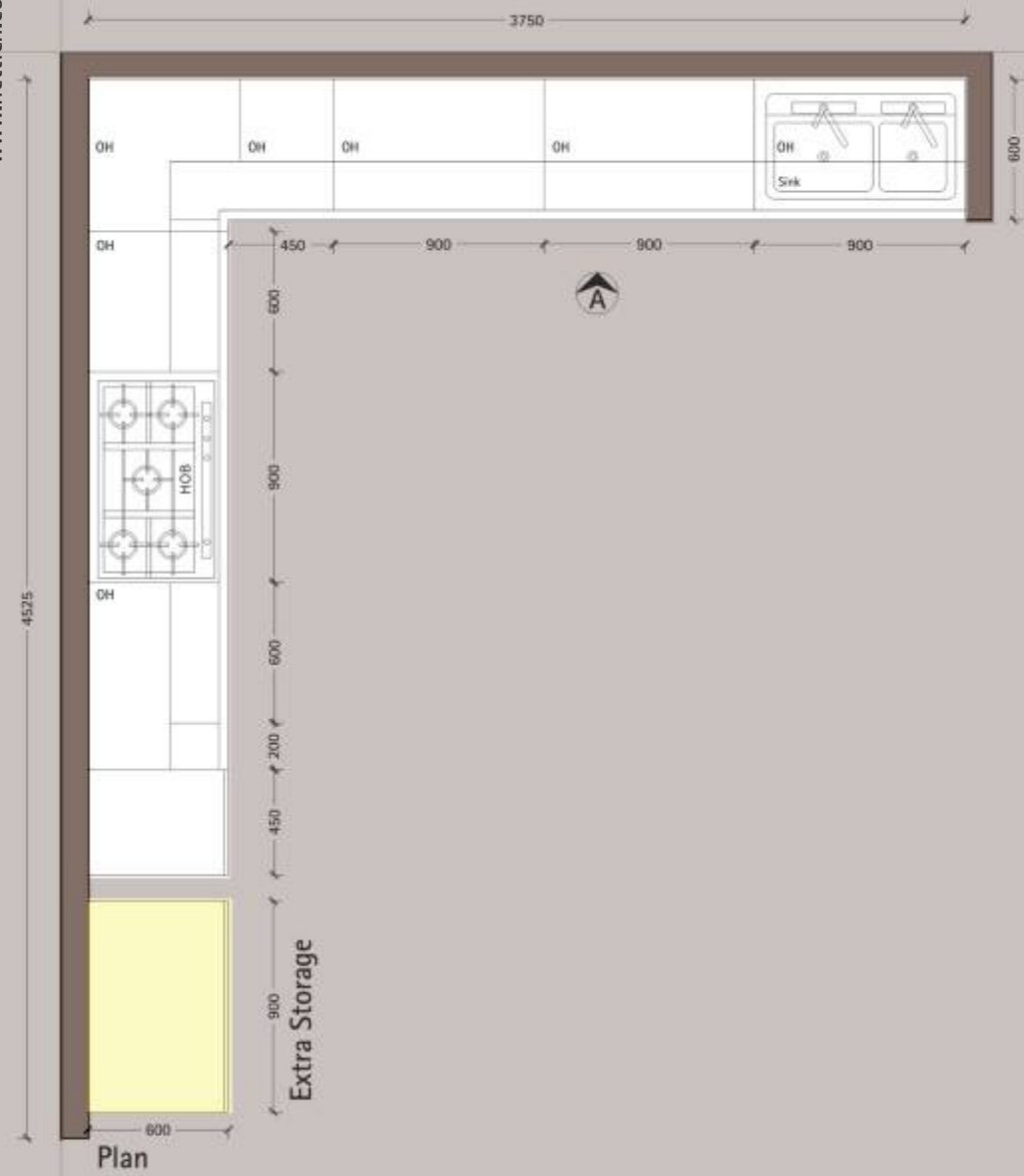

Legend

- IS Innotech Preassembled Internal Pot & Pan Drawer-Basic
- OT Innotech OrgaTray 440 Cutlery Tray
- ISR Innotech powder coated steel-Silver-with railing
- IPPL Innotech drawer system org-Lengthwise railing
- CM CargoMan Corner solution,Right Hand
- CL Interior fitting for pantry units-Cargo Larder
- MU Microwave Unit
- S Sensys Hinge
- DP Detergent Holder
- W600 Waste Bin- 600 Pullout
- CUS Corner Unit with Shutter
- C200 Cargo IQ 200 with Quadro -450mm
- OC Open Cabinet

Extra Storage

- WB Wicker Basket
- QDC Quadro Drawer Channel
- OS Onsys Hinge for shutter

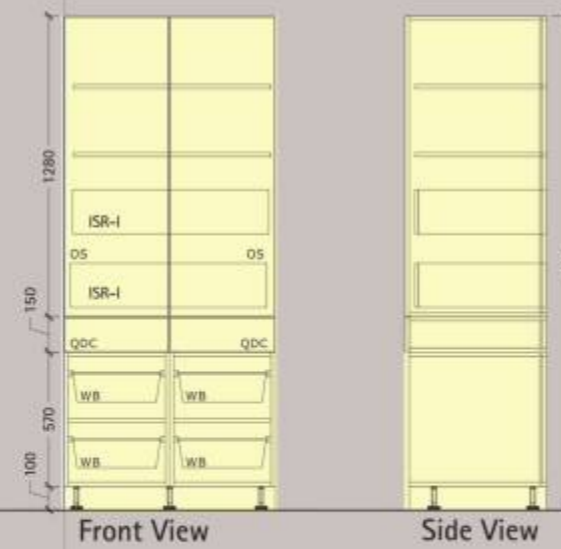

InnoTech Pot & Pan Drawer



Dish Drainer Set



Wicker Basket



Versa Inside 90 (Linear light)



CUBO

Minimal yet large

Make your dream kitchen a reality with premium Hettich fittings which not only makes your kitchen come to life but also adds a tinge of emotion to it.



SUPREME SHELVING

These shelving units provide ample surface space for all type of kitchen.

FITTINGS USED

- InnoTech Drawer System
- Cargo Carousel Corner Solution
- Cadro Shelving System

CMF USED

Grey & Wood
Matte finish

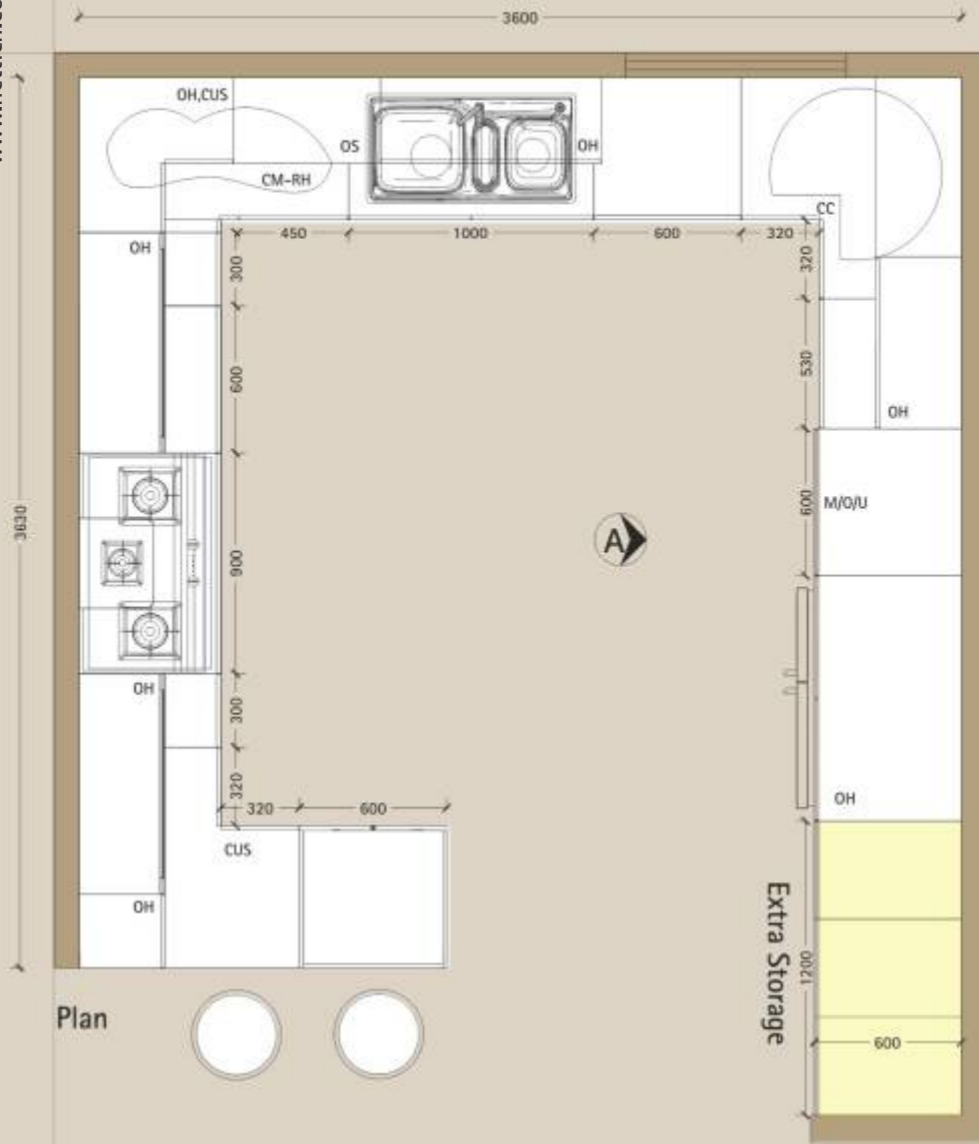

Legend

S	Sensys Hinge for Shutter
IS	Innotech powder coated steel-Silver (70/470mm)
ISR	Innotech powder coated steel-Silver with Railing(144/470mm)
IPPL	Innotech powder coated steel-Silver with Lengthwise Railing
Ot440	OrgaTray 440
CM-RH	Cargoman-450mm (RH) with Blind Corner Hinge
C200	Cargo IQ200-300mm (Bottle P/Out) with Quadro Runner
SPO	Spice Pullout- 300 mm with KA Runner
CC	Cargo Carousel (900x900mm)
M/O/U	Microwave/Oven Tall Unit-600mm
OH	Overhead Storage
LHF	Folding Flap Fitting-Lift Advanced HF

Extra Storage

LHK	Advance Lift up- LHK
OC	Open cabinet
OS	Onsys Hinge for shutter



InnoTech Pot & Pan Drawer



Sensys Hinge



Lift Advanced HK



Round Bin Holder 200 Series

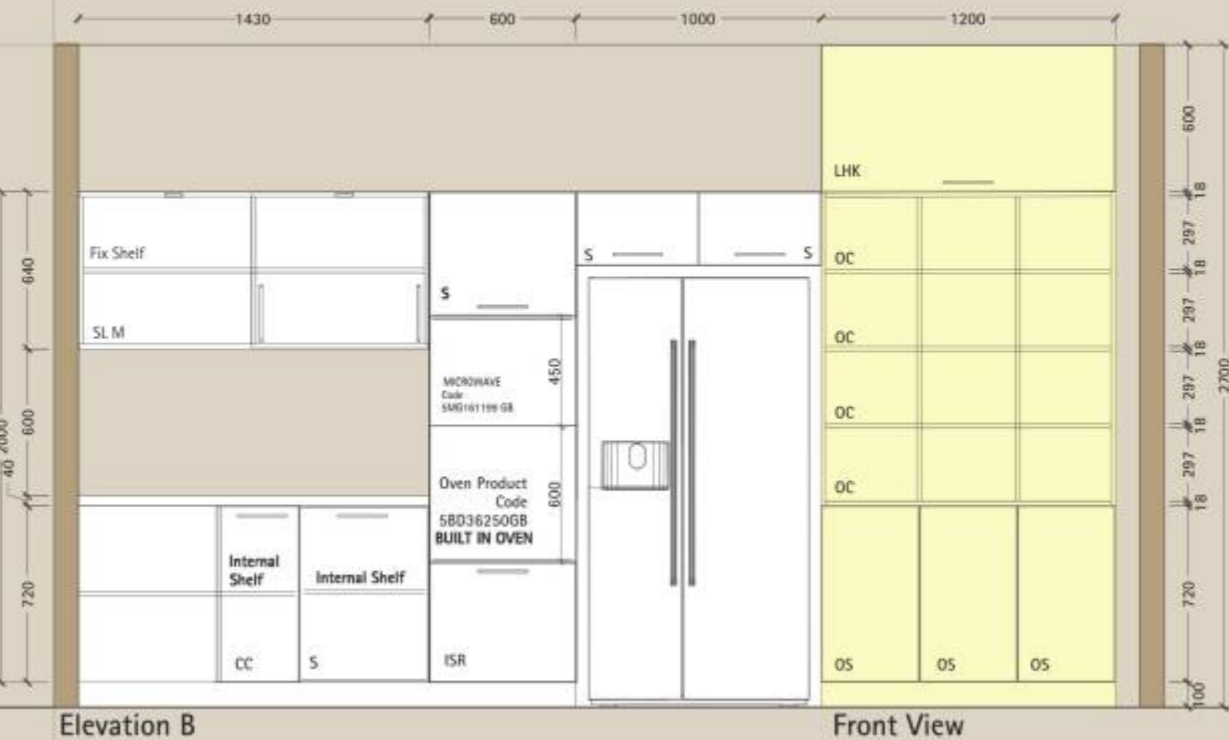



DRITTA

Amidst the calmness

Inspired from the freshness of the breeze and energy of the waves, this kitchen promises to bring a smile every time you are inside- whether you cook or you slide.



CUBE SLIDING CABINET

No matter whatever be the size of your kitchen, every little inch matter when it comes to storage. A simple cube sliding cabinet above a counter top increases your kitchen storage.

FITTINGS USED

- Atira Drawer System
- Sensys Hinge
- Squire Bin Holder

CMF USED

Blue & Wood
Matte Finish





Plan

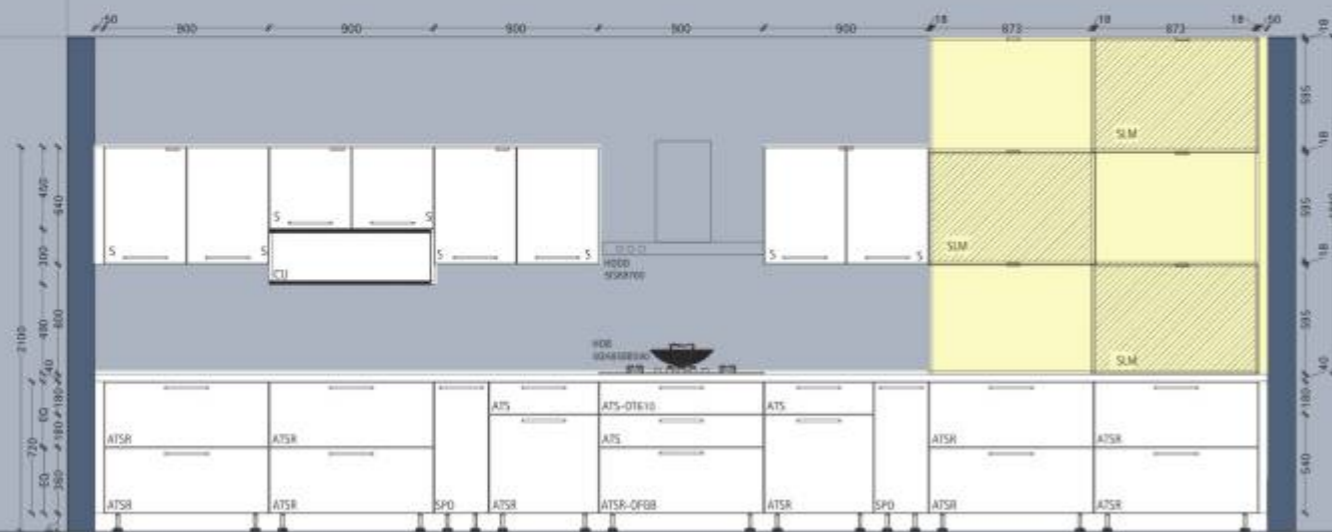

Elevation A

Front View



Side View

Legend

S	Sensys Hinge for Shutter
ATS	Innotech Atira powder coated steel-Silver (70/470mm)
ATSR	Innotech Atira powder coated steel-Silver with Railing(144/470mm)
Ot610	OrgaTray 610
OFGB	OrgaFlag Basic Set
PR	Plate Rack
C200	Cargo IQ200-300mm (Bottle P/Out) with Quadro Runner
SPO	Spice P/Out-300mm with KA Runner
SBH	Square Bin Holder Cargo Series
DH	Detergent Holder Cargo Series
WB	Wicker Basket-600mm (300mm)
ATPU	Innotech Atira Pantry Unit-900mm with Wide Angle Hinge
ATS-I	Innotech Atira powder coated steel-Silver Internal Drawer(70/470)mm
ATSR-I	Innotech Atira powder coated steel-Silver Internal Drawer with Railing (144/470)mm
M/O/U	Microwave & Oven Tall Unit-600mm
OH	Overhead Storage
DDS	Dish Drainer Set-900mm with Wide Angle Hinge

Extra Storage

CU	Cube-Black Matt with Wooden Shelf
SLM	SlideLine M



Atira Pot & Pan Drawer



SlideLine M

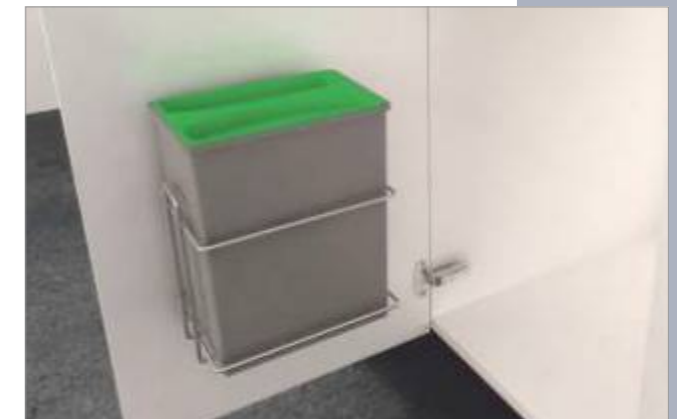

Square Bin Holder



Stabia (Handle)

Kitchen Accessories

Accessories your kitchen with Hettich's wide range of accessories ranging from organising trays to wicker baskets and everything which falls in between. They are trend-setters in their own style, creating harmony within.

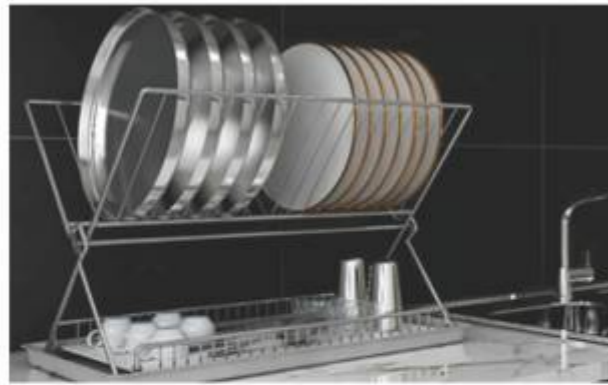



BIANCA

Tranquility at its best

Smooth and silently working kitchen fittings from Hettich create a sense of tranquility and bliss in the kitchen.



KITCHEN ORGANIZER

This creates some visual contrast without having to compromise your storage needs.

FITTINGS USED

- CargoPlus Drawer System
- Pull-Out Bin Holder W300
- WingLine L Sliding Folding Fitting

CMF USED

White & Light Brown
Matte Finish

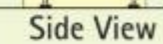
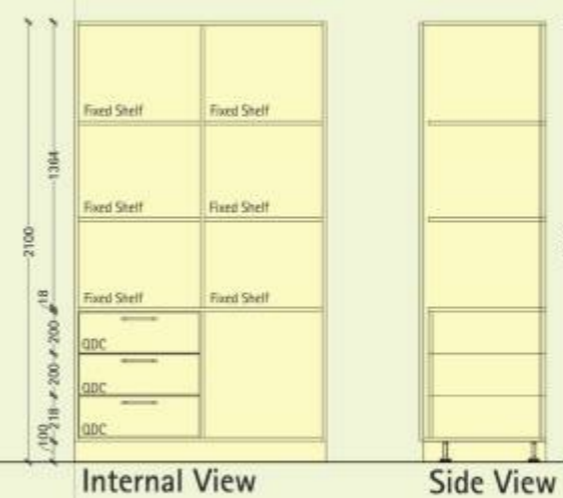
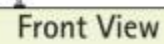
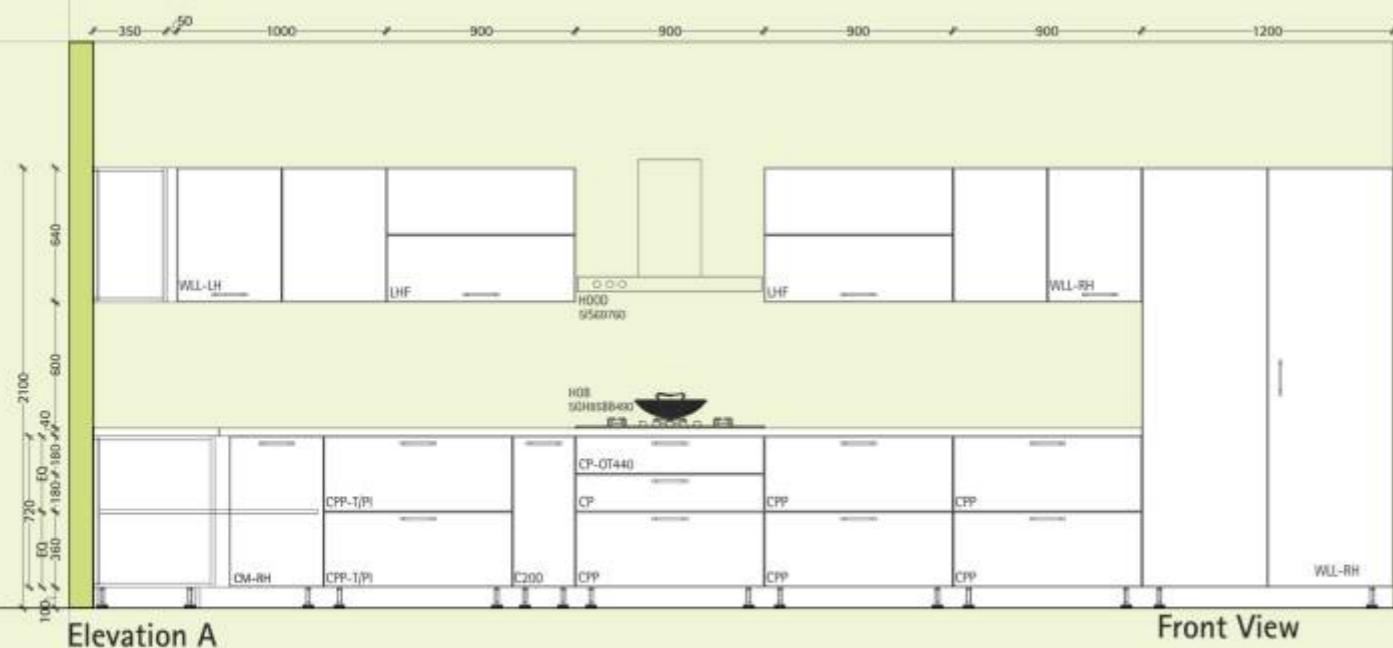
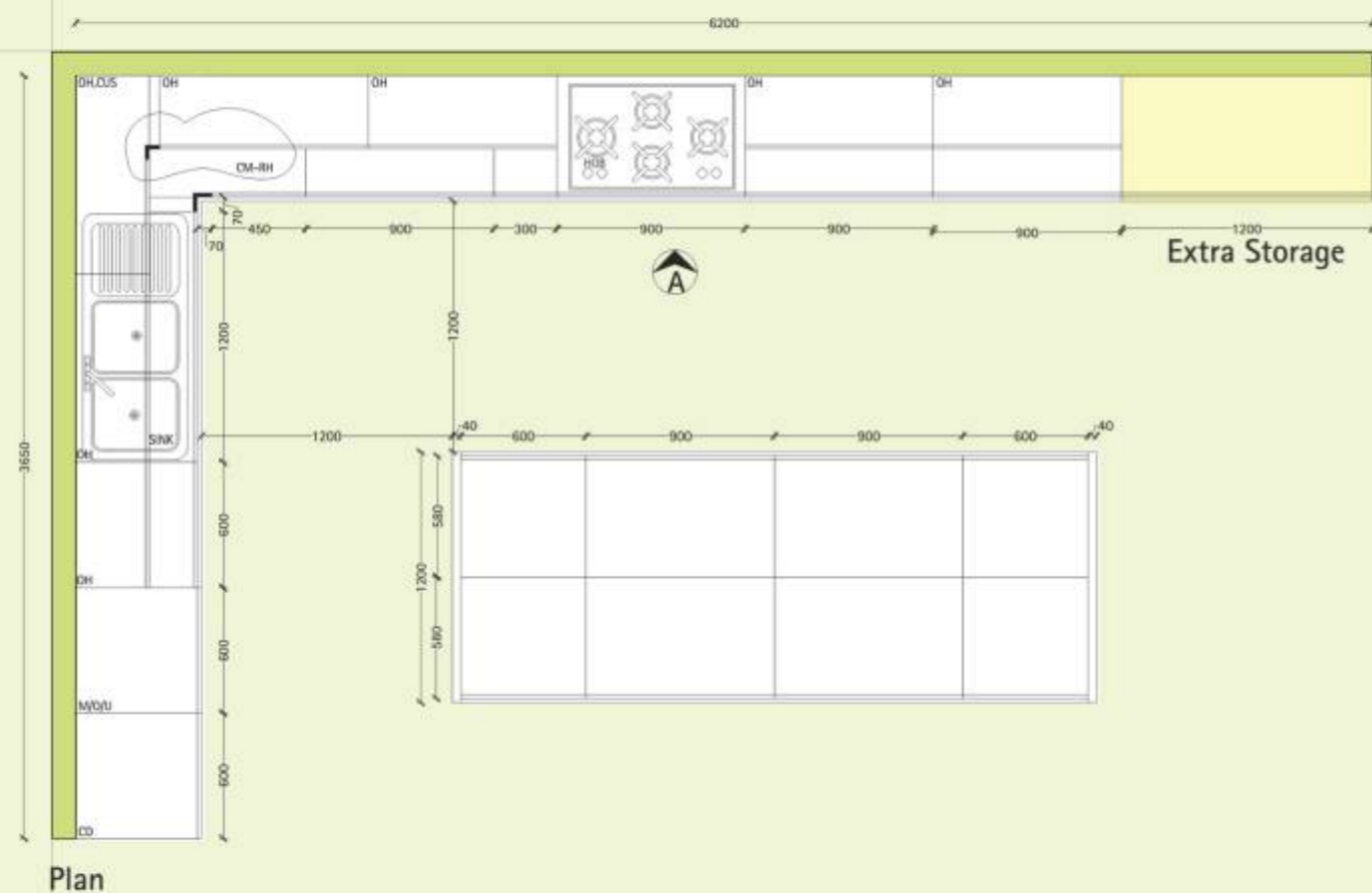

Legend

S	Sensys Hinge for Shutter
CP	CargoPlus Plain with InnoTech (900wX470dX70ht)
CPP	CargoPlus Pot Et pan with InnoTech (900wX470dX144ht)
CPP-T/PI	CargoPlus Thali/ Plate Inlet with InnoTech (900wX470dX144ht)
Ot440	OrgaTray440
CM-RH	Cargoman-450mm (RH) with Blind Corner Hinge
CTP-P/SI	CargoTech Plain with Plate Et Seperator Inlet
DH	Detergent Holder Cargo Series
SBH	Square Bin Holder Cargo Series
M/O/U	Microwave Et Oven Tall Unit-600mm
CD	Cargo Duo-600mm (6-Tier) with Wide Angle Hinge
OH	Overhead Storage
LHF	Folding Flap Fitting-Lift Advanced HF
WLL	WingLine L (Left Hand Et Right Hand)
CUS	Corner Unit with Shelf with Blind Corner Hinge
DDS	Dish Drainer Set-900mm with Wide Angle Hinge

Extra Storage

WLL	WingLine L (Right Hand)
QDC	Quadro Drawer Runner





GRIGIO

Feeling of elation

Make your kitchen a versatile and happy space with Hettich's range of innovative fittings.



UTILITY CART

This is ideal for kitchens which have a limited space. Utility Cart provides a little more storage and one can also opt for a little rolling cart.

FITTINGS USED

- Atira Drawer System
- Cadro Shelving System
- Cargo IQ 200 Bottle Pull-Out

CMF USED

Grey & Wood
Matte Finish



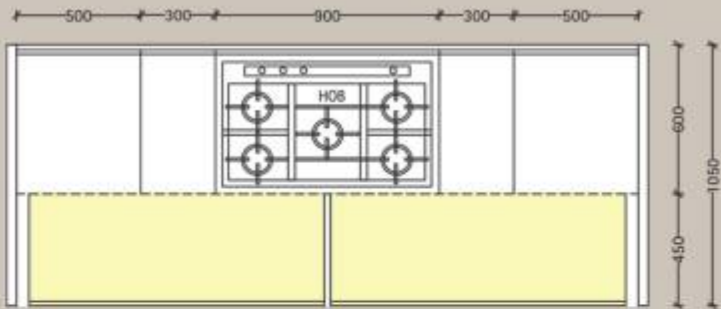
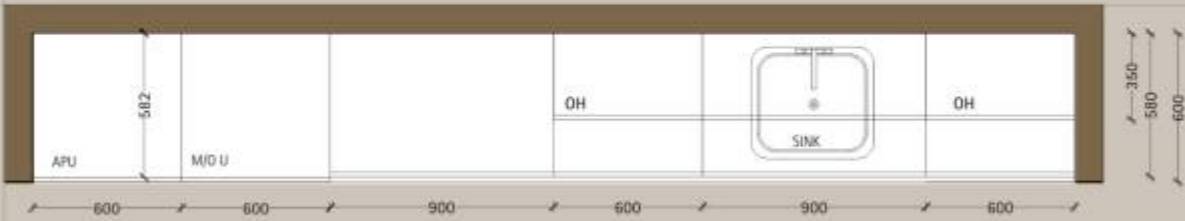

Extra Storage

Plan

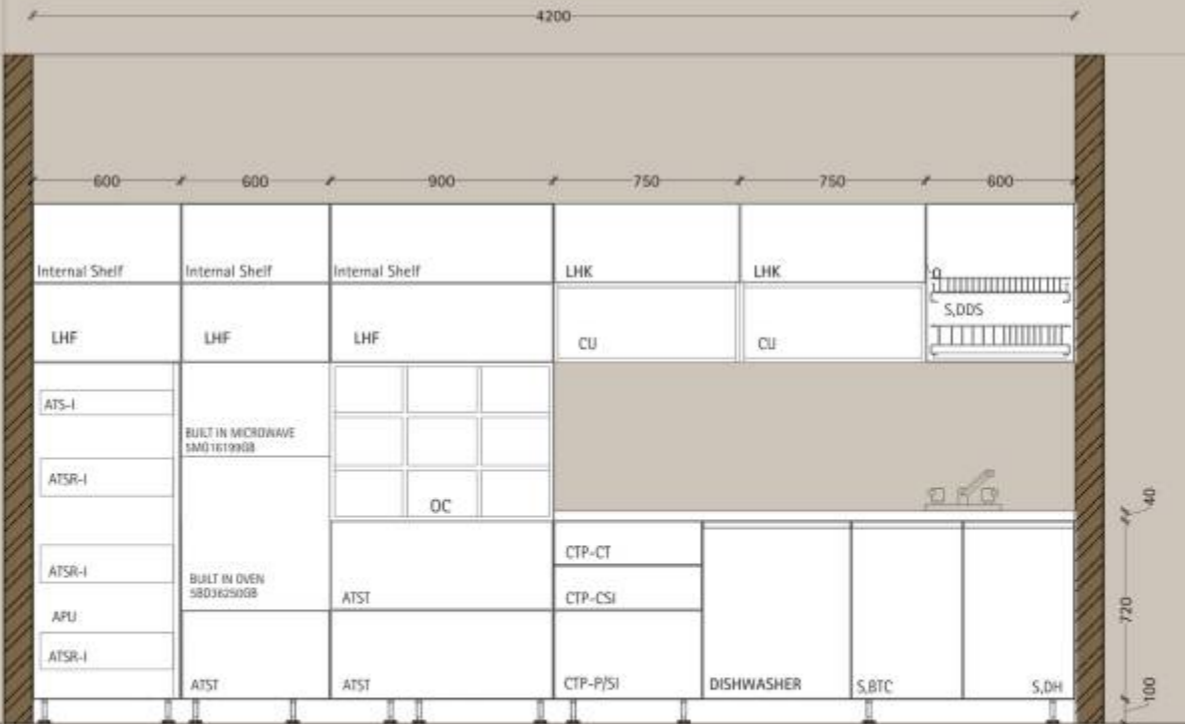

Elevation A

Legend

- S Sensys Hinge for Shutter
- ATS Innotech Atira powder coated steel-Silver (70/470mm)
- ATST Innotech Atira powder coated steel-Silver with TopSide (144/470mm)
- Ot610 OrgaTray 610
- OFGB OrgaFlag Basic Set
- CU Cube-Black Matt with Wooden Shelf
- OH Overhead Storage
- LHF Folding Flap Fitting-Lift Advanced HF
- LHK Flap Fitting-Lift Advanced HK
- BTC Bin IT. Classic - 13L (Waste bin p/out)
- DH Detergent Holder Cargo Series
- APU Innotech Atira Pantry Unit

Extra Storage

- AC Actro Channel
- Castor Swivel castor with brake

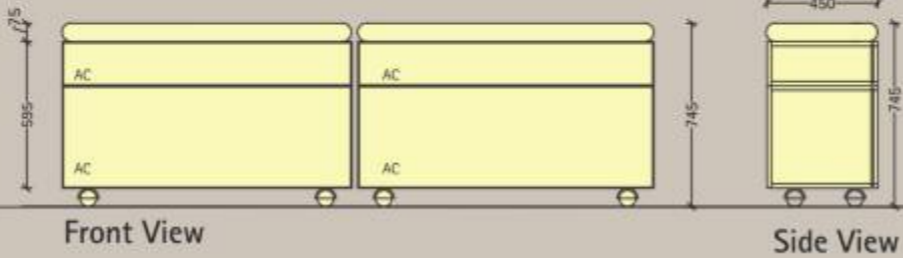

Front View

Side View



OrgaTray 610



CargoTech Plate Inlet



Versa Inside 30 (Linear light)



Island Hood (5DS 99760)



KITCHEN – EXTRA STORAGE

IDEA BOOK

