

IDEA BOOK  
SLIDING SYSTEMS  
HIGH ON PERFORMANCE  
LOW ON BUDGET



  
**Hettich**





*Ergonomics, design and functionality get people excited about sliding motion.*

*This ideabook showcases sliding concepts you'll love ☺*

IDEA BOOK  
SLIDING SYSTEMS

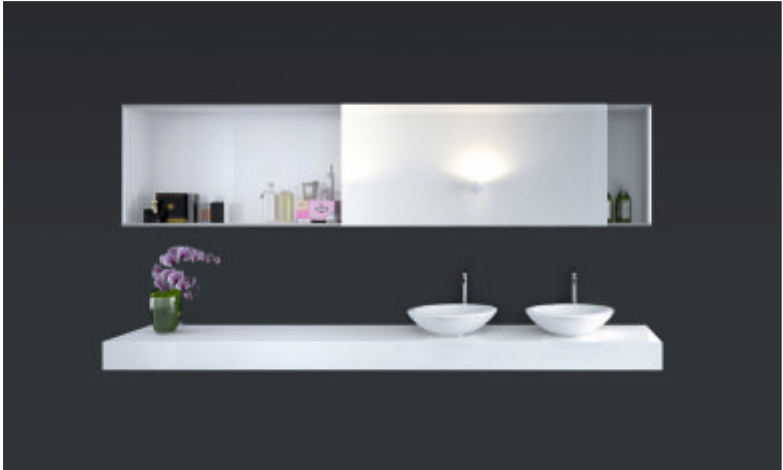



# SIGNIFICANCE OF STORAGE SPACES IN YOUR WARDROBE

Wardrobe is not just a piece of furniture used for storage; it is also a reflection of one's personality and lifestyle. In this Idea Book, we showcase sliding fittings viz. Slideline M, TopLine M and SlideLine 16, which are innovative in design and currently in vogue.



## Gender & Status

Every utilitarian furniture concept revolves around gender, and hence makes it gender-centric. The details will vary from finishes to accessories to form. A diverse range of accessories from Hettich will support the needs of men and women alike, ranging from storage of shirts to trousers to gowns and dresses to storing compact items like wallets to watches to belt and ties.



## Lifestyle

The furniture will again vary from the different trendy lifestyle each individual embodies from time to time. We are already surrounded by them in our day to day lives. For example, men who like to collect neckties and cuff-links or women fond of acquiring exquisite bags and shoes or gorgeous gowns have nothing to worry about. Innovative Hettich furniture fittings and accessories are here for you.



## Your organizing preferences

A very subjective scenario to cater to. Some people hang everything, including t-shirts. Some people prefer to fold their pants in shelves, while others fold their trousers over a hanger. Some like to use shelves, while others like drawers. Think and choose from our wide range of Hettich accessories and organizers, which resonate with your style.



## Security

Apart from the basic function of storing, wardrobe demands a sturdy locking mechanism which not only provides function but aesthetics too. Hettich provides wide range of single to multi door locking solutions to smart locks, i.e RFID lock system ensures safety in all angles.



PLUS

*Simple yet effective*

## Bed Room | Wall Unit

The centrepiece embodies a visual lightness which focuses on memorable souvenirs and artifacts. The linearity towards the whole furniture piece which is pushed back, automatically brings the oak laminated cabinet to attention.



### FITTINGS USED

- SlideLine M
- Sensys hinge
- Lift up

### CMF USED

- Oak & Gothic grey
- MDF
- Matte finish





## GRID

*A reality with different frames*

## Living Room | Showcase Unit

The bright shutters not only bring character to the piece but the environment as well. This wall hung unit showcases contemporary zines, books and items which make the art of reading fun.

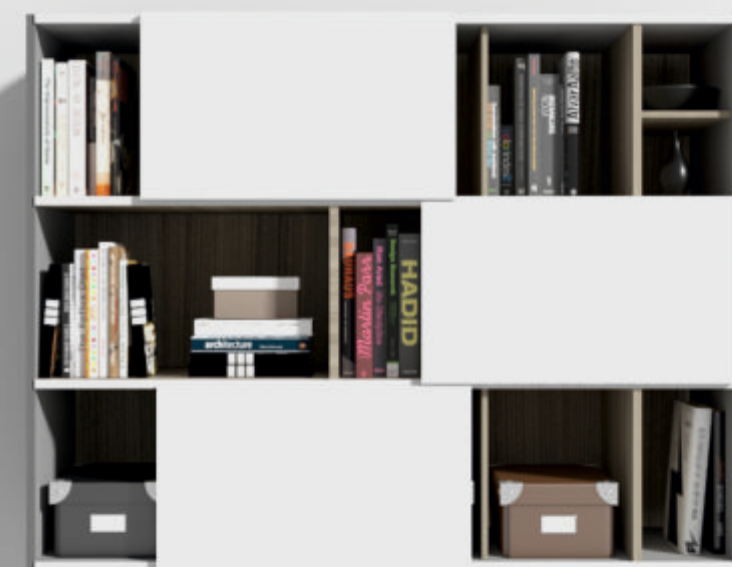

## FITTINGS USED

- SlideLine M

## CMF USED

- White & Grey
- MDF
- Matte finish





## EDGE

*A little more than yesterday,  
a little less than tomorrow*



## Hallway | Storage Unit

When the magic begins with a slight touch. The moving shelves housing small souvenirs and items which are best suited in a hallway setup with the most trending magazines. The center portion divides the depth into two sections making it easy to display objects.



## FITTINGS USED

- SlideLine M
- KA drawer runner
- Lift up

## CMF USED

- Sky blue & Walnut
- MDF & Acrylic
- Matte finish



## LUSCENT

*Reflecting perfection,  
while reflecting distinctiveness*



## Vanity | Storage Unit

This not only counts as a vanity but an essential unit for makeup and much more. The tinted plexi glass SlideLine M shutters just open up a new area and new variety of choice which brings in your own sense of comfort and liking.



## FITTINGS USED

- SlideLine M
- Quadro drawer runner

## CMF USED

- Oak & Soapstone grey
- MDF & Acrylic
- Matte finish



## NOBLE

*The more you are happy,  
the more you shine*



## Kids Room | Storage Unit

A simple yet effective storage unit which encompasses a small utility tray for your essentials and toys. Let the kids have a gala time with the fun experience of sliding. The back surface also acts as a viewing mirror for the kids ever changing expressions.



## FITTINGS USED

- SlideLine M

## CMF USED

- Mellow yYellow & Gothic grey
- MDF & Mirror
- Matte finish



## JANOT

*Talking about utility?  
Experience the limitless!*



## Utility Room | Janitor Storage Unit

Transparency is the key. A perfect combination of storage space, which allows you to keep items from toiletries to cleaning agents of various sizes. The use of glass as the back panel of the moving shelf emits an immediate lightness to the piece.



## FITTINGS USED

- SlideLine M
- Sensys hinge
- Atira

## CMF USED

- Gothic grey & Pale pink
- MDF & Acrylic
- Matte finish



# SLIDELINE M

## TECHNICAL DETAILS

- ▶ 1- 2 track, bottom-running sliding door system
- ▶ Overlay / Inset door position
- ▶ For wooden doors, aluminium-framed doors and glass doors
- ▶ Door weights up to 30 kg
- ▶ Door width 300-1800 mm
- ▶ Profiles for shelf thickness 15/16 mm,18/19 mm, 22 mm, 25 mm
- ▶ +/- 2 mm height adjustment
- ▶ Silent System with activators that can be positioned anywhere
- ▶ Tested to DIN-EN 15706, level 3

Door size and door weight

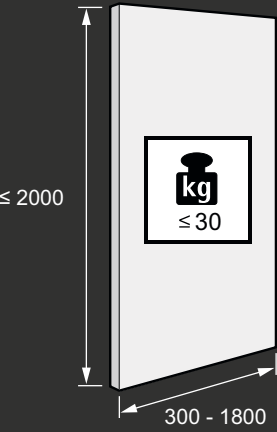

Installation Video



<https://youtu.be/VMPw68Ah24w>

Number of door wings and door position / Silent System

	Overlay		Inset		
	1-door	with several doors	1-door	2-door	3-door
Soft closing					
Soft opening					
Soft colliding					

Customize to your imagination

Free moving sliding door system for showcases

01 | 1200 x 450 x 1600

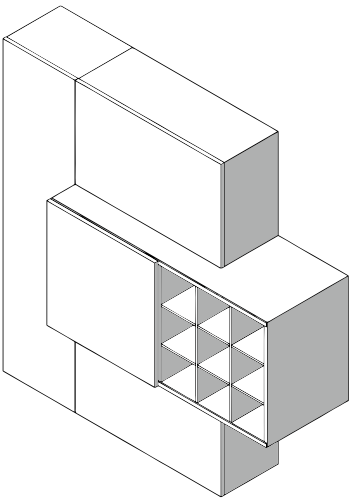

02 | 1400 x 450 x 1100

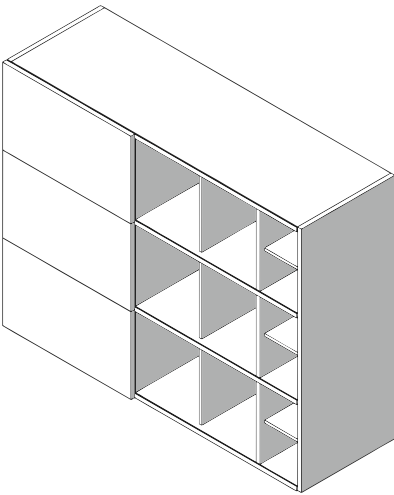

03 | 1800 x 400 x 1800

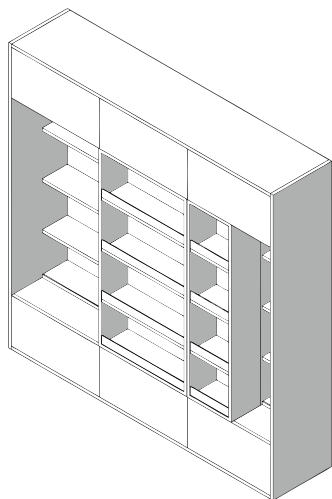

04 | 1350 x 350 x 2300

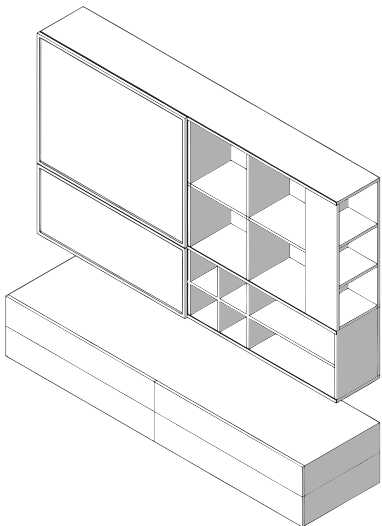

05 | 1900 x 450 x 1600

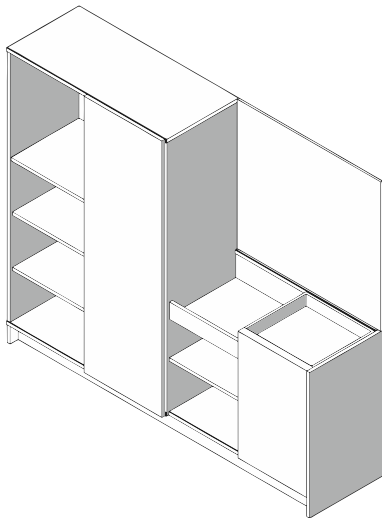

06 | 1500 x 500 x 2100

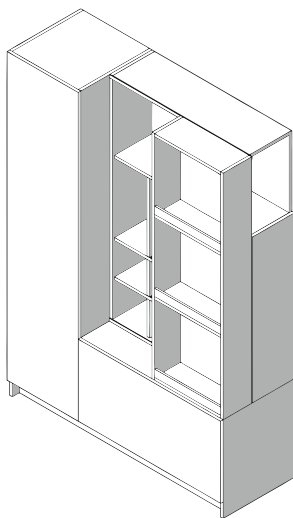



# PLANE

*In a world full of noise,  
be a voice, not an echo*



## Living Room | Entertainment Unit

A geometric yet minimal looking TV unit can make the whole space luxurious. This TV unit comes with a mesmerizing simple line composition, breathtaking style and unique in-built storage unit. It uplifts your house from a regular house to a beautiful exclusive abode.



### FITTINGS USED

- TopLine M
- Sensys hinge
- Quadro drawer runner

### CMF USED

- Chest nut & White
- MDF
- Matte finish



## SLICK

*Away with convention,  
give me freedom*



## Kitchen | Pantry Unit

Large storage area for pantry unit, which not only gives the user a pragmatic experience but a scope to view and function things with ease. Enough room has been provided in the internals with maximum storing of cutlery and jars.



## FITTINGS USED

- TopLine M
- Sensys hinge
- CargoTech

## CMF USED

- Chest nut & White
- MDF
- Matte finish



## JARVIS

*Oasis in the midst of hustle*

## Hallway | Storage Unit

A cloak room which houses your coats to muddy shoes to raincoats and more. A perfect use of horizontal linearity which slides and glides with ease, avoiding any disturbance in the passage area.



## FITTINGS USED

- TopLine M
- Sensys hinge
- Cargo shoe rack

## CMF USED

- Gothic grey & Denim blue
- MDF
- Matte finish



## FOCAL

*Busy like office,  
calm like home*



## Home Office | Workspace

A basic reflection of a cubicle which pops out white in the centre as a focus area. The use of storage has been carried out with an effective yet an easy to use sliding mechanism where you can hoard your files, rolls, books and put snapshots over the soft board, remembering the good old times.



## FITTINGS USED

- TopLine M
- Sensys hinge
- Aluminium profile

## CMF USED

- Chest nut & Grey felt
- MDF & Frosted glass
- Matte finish





## SLASH

*When you are too serious about your relaxation*



## Kids Room | Wardrobe With Seating

A play of angles which excites the young. An illuminated sitting space which brings out the character of the whole space. A generic touch to the internals and the easy and effortless gliding of the shutters, will surely bring a smile to your child's face.



## FITTINGS USED

- TopLine M
- KA drawer runner

## CMF USED

- Walnut & Brass
- MDF & Felt
- Matte finish



# SWIPE

*Things remain constant,  
ambience goes along with you*



## Bedroom | Wardrobe Cum Dressing

A sought after balance of a dressing and a wardrobe. The subtle link of different coloured panels to the sitting surface, creates a flow and does not disturb the overall ambience of the room.



### FITTINGS USED

- TopLine M
- Cargo shoe rack
- Sliding door cylinder lock

### CMF USED

- Gothic grey & Sky blue
- MDF & Mirror
- Matte finish



# TOPLINE M

## TECHNICAL DETAILS

- ▶ 2-track, top running sliding door system
- ▶ Overlay door position
- ▶ For wooden doors
- ▶ Door weight up to 35 kg
- ▶ Door height up to 2300 mm
- ▶ Door width 500 - 1250 mm
- ▶ Door thicknesses 15, 16, 18, 19 mm
- ▶ 2 opening versions: fully flush or offset when using projecting handles
- ▶ Tested to EN 15706, Level 2

Door size and door weight

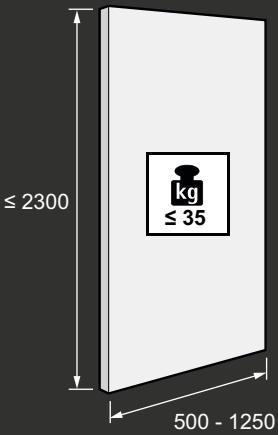

Installation Video



<https://youtu.be/8VBixkEY8QA>

Number of door wings and door position / Silent System

Soft closing

2-door



3-door



## Design Flexibility

### Top running sliding door system for wardrobes

07 | 4000 x 600 x 2100

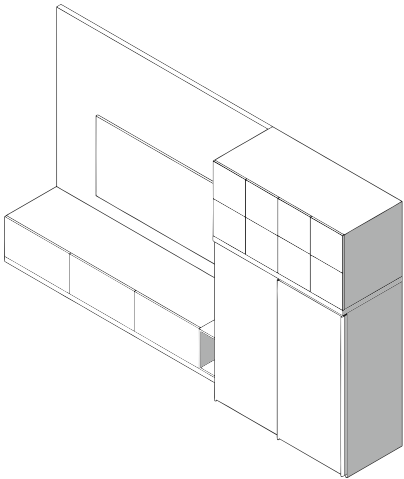

08 | 1500 x 600 x 2100

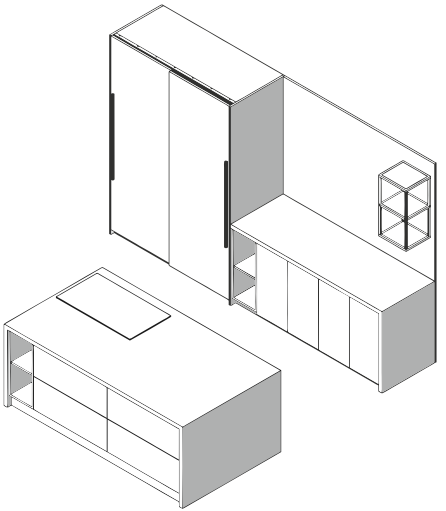

09 | 2800 x 600 x 2100

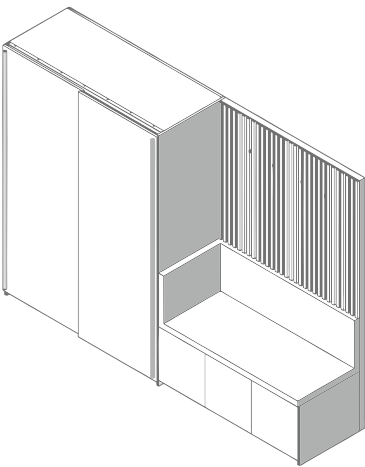

10 | 2500 x 600 x 2100

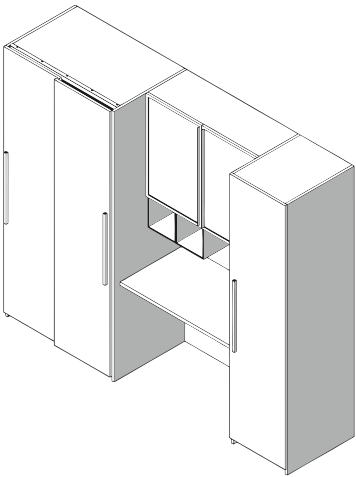

11 | 3000 x 600 x 2300

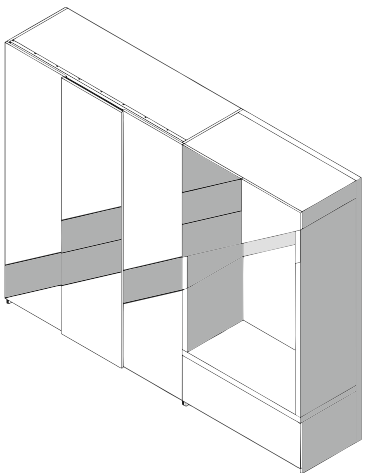

12 | 2400 x 600 x 2100

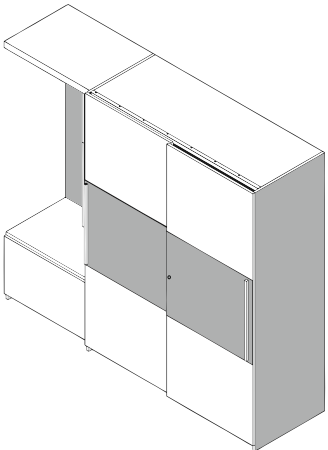



# PRIM

*Less is more. Make it simple but significant*



## Bed Room | Wardrobe

Elegance, exclusiveness and the understated luxury are the key features of this wardrobe. Its simplicity is defined by the purity of form and giving you design flexibility at max.



### FITTINGS USED

- SlideLine 16
- Sliding door cylinder lock
- Profile finish- Black

### CMF USED

- White & Gothic grey
- MDF
- Matte finish



## HIDE

*Hide it when you mean it*

## Store Room | Recessed Wardrobe

Hiding all that clutter with ease. The niche concept lets you hoard and store your belongings and keep it away from sight. The smooth functioning of the fitting lets you slide the wide span shutters with ease.



## FITTINGS USED

- SlideLine 16
- Profile finish- Silver anodised

## CMF USED

- Oak & Gothic grey
- MDF
- Matte finish



## MIST

*Reflect the dark,  
bring out the light*



## Dresser | Walk-In Wardrobe

A grand room requires a great entry. The shutters have been created in such a manner that it gives a sense of lightness and at the same time solves a purpose to view things on the other side. Here, we treat it as an entry to a walk-in Amari and vanity.

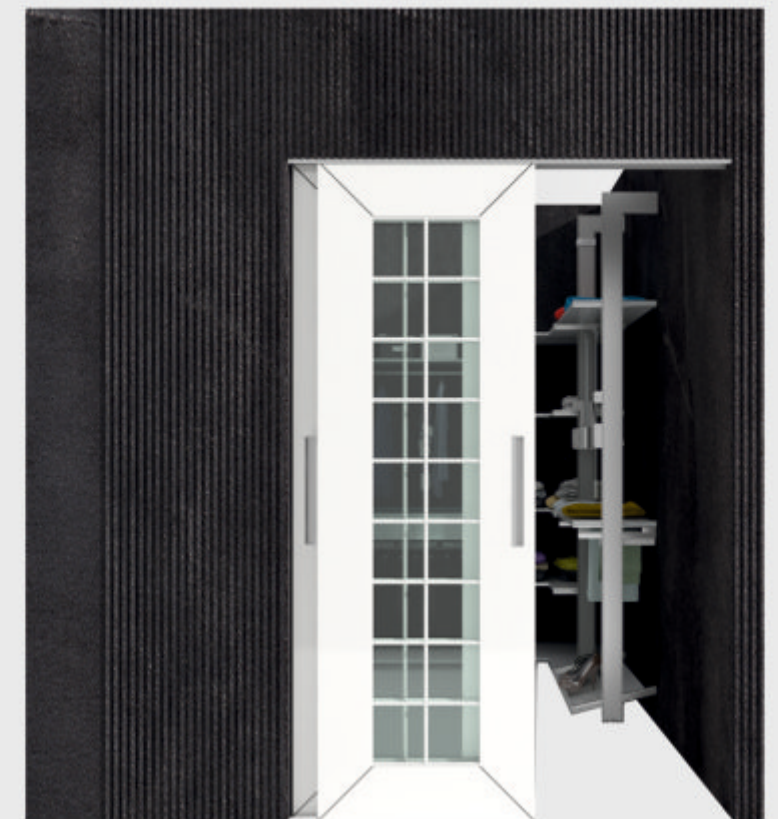

## FITTINGS USED

- SlideLine 16
- Profile finish- Black

## CMF USED

- White & Glass
- Wood & Clear glass
- Matte finish



## TETRIS

*A child's play*

## Kids Room | Storage Unit

Young kids need simple yet interesting ideas to brighten up their horizon and imagination. The shutters in itself provide a puzzle like effect, which creates different patterns of blue and yellow on the internals, when being slid to and fro.



## FITTINGS USED

- SlideLine 16
- Profile finish- Black

## CMF USED

- Chest nut & Pale blue
- MDF
- Matte finish



## BREEZE

*Discover the new you.  
Exclusive and divine!*



## Dining Room | Crockery Unit

Dividing the unit into three segments with a play of materials like mirror, glass and MDF. This sleek and symbolic unit showcases your cutlery alongside your dining. The champagne finish profile and shutter creates a uniform effect on the outside.



## FITTINGS USED

- SlideLine 16
- Profile finish- Champagne

## CMF USED

- Light pink & Gothic grey
- MDF, Mirror & Glass
- Matte finish



# ANCHOR

*Big on storage for those big on responsibilities*



## Office | Storage Unit

This versatile fitting makes it easy to blend in any environment and embrace the exterior aesthetic of the cabinetry with ample storage space. This unit exclusively helps organize your valued and official possessions, docs, chart paper rolls and a variety confidential files.



### FITTINGS USED

- SlideLine 16
- Profile finish- Black
- RFID lock

### CMF USED

- Gothic grey & Pine
- MDF
- Matte finish



# SLIDELINE 16

## TECHNICAL DETAILS

- ▶ 2 track aluminium profiles for screwing on, bottom running sliding door system
- ▶ No routing, no drilling
- ▶ Length 3000 mm, 2000 mm
- ▶ For max. door weight of 60 kg
- ▶ Soft opening / soft closing with improved version of dampener
- ▶ For wooden doors (16 - 24 mm)
- ▶ Aluminium profile finishes- Black, Silver Anodised & Champagne
- ▶ Endurance test over 20,000 cycles (EN 15706 Level 2)
- ▶ Closing test with a pulling force of 3kg (EN 15706 Level 2)
- ▶ Lift out test at 200N (EN 15706 Level 2)
- ▶ Load test in Horizontal direction at 200N (EN 15706 Level 2)
- ▶ Corrosion Test : 72 Hours Condensation Test (EN 6270)

Door size and door weight

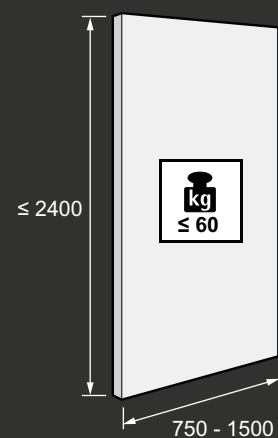

Installation Video



<https://youtu.be/5pju8DxlnfE>

Set contains fitting, profile and silent system

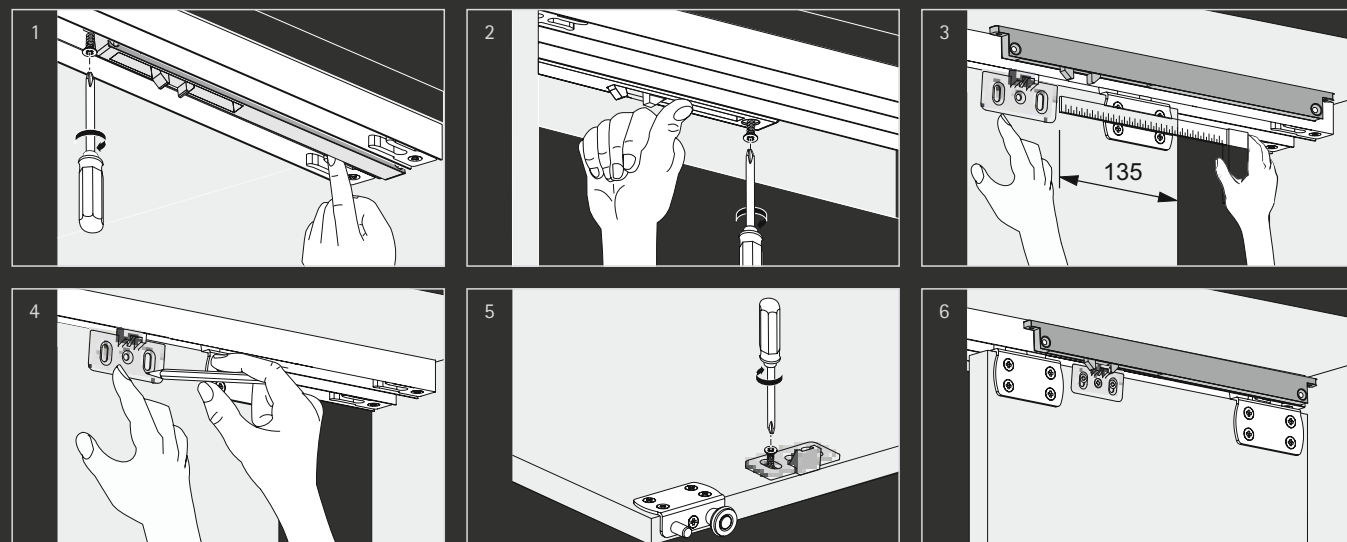

Simple & reliable with ease of installation  
Soft opening & soft closing sliding system for wardrobes

13 | 2400 x 600 x 2400

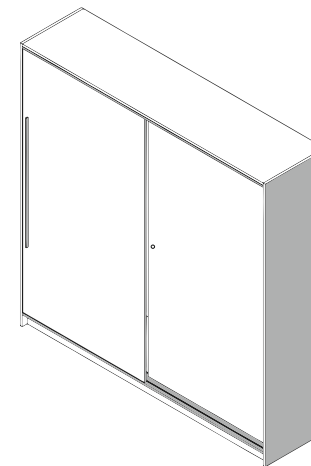

14 | 3000 x 600 x 2400

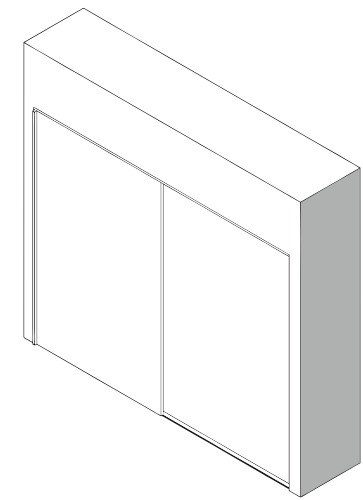

15 | 1600 x 1150 x 2400

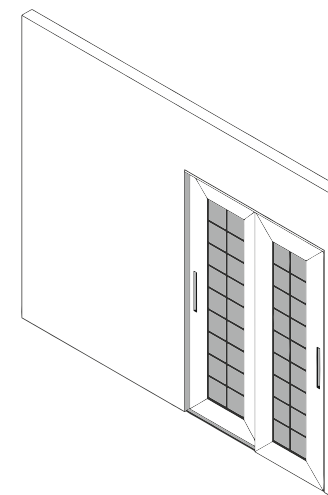

16 | 2450 x 400 x 1500

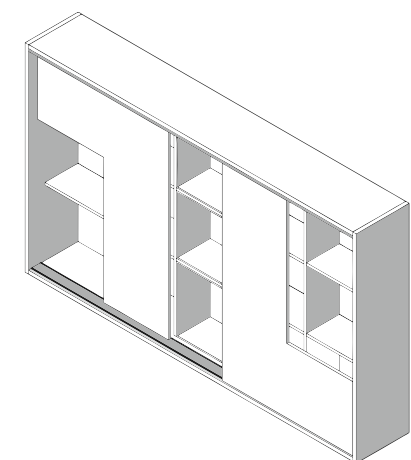

17 | 1200 x 450 x 1600

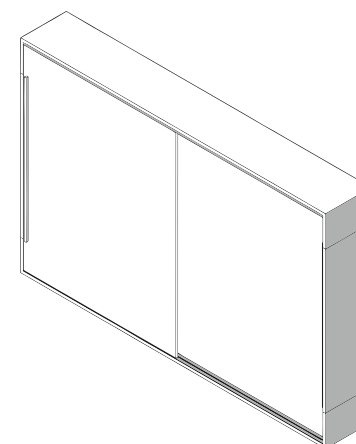

18 | 1500 x 500 x 1500

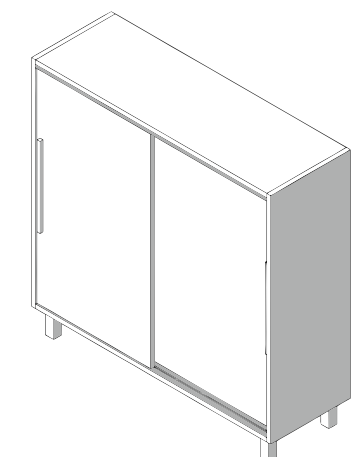



[illegible]This image shows a single sheet of white paper with horizontal ruling lines. The lines are evenly spaced and run across the width of the page. There are no margins, text, or other markings on the paper.



