

IDEA BOOK
SLIDING SYSTEMS
LUXURY
REDEFINED



Ergonomics, design and functionality get people excited about sliding motion.

This ideabook showcases sliding concepts you'll love ☺

IDEA BOOK SLIDING SYSTEMS



LUXURY IS REALLY A STATE OF MIND

Till very recently, the concept of luxury housing was limited to location and size. Those who could afford such homes were high net worth individuals who wanted to live in large bungalows in premium locations. The size and location were directly related to the wealth the individual had.

With urban India changing fast - a younger population with rising disposable incomes and exposure to global trends, the concept of a luxury home now encompasses various amenities and conveniences; the aim of this book is to provide a luxurious interior environment.

Taking all of the above into consideration, in today's world luxury is really a state of mind. It's what makes you happy enough to enjoy what you have rather than always seeking more. High end Hettich furniture fittings and accessories give you that and so much more. It's not a show of wealth but the enjoyment of what wealth has to offer. This is Luxury Redefined!

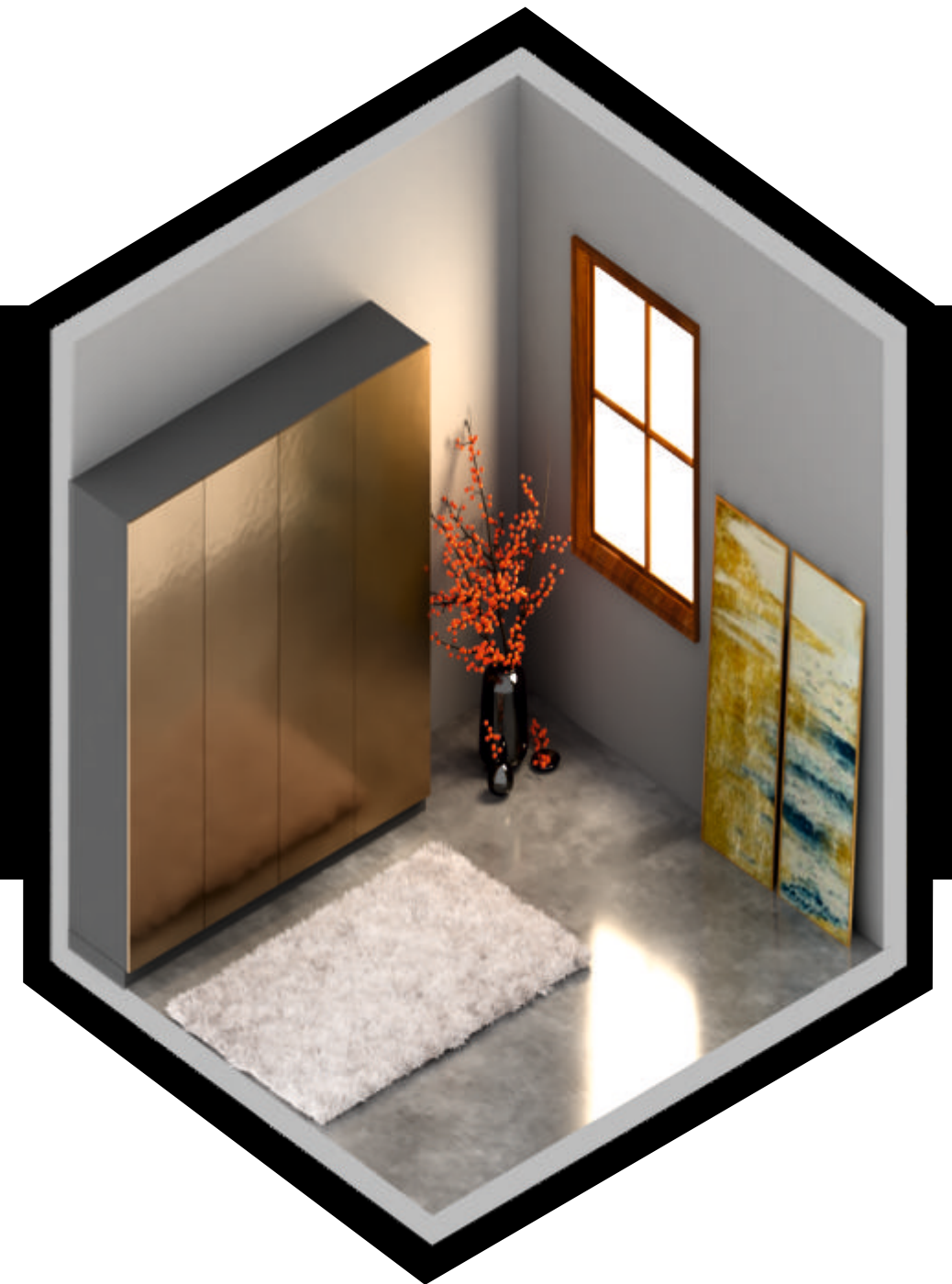

Luxury in Lifestyle

In today's world, luxury in lifestyle is having the time and money. It's like having something in your mind and the next moment, you are able to fructify the same. Luxury is a state of the mind.



Luxury in Furniture and Spaces

From styling distinct spaces, conceptualizing interior design ideas to designing luxury furniture & spaces, Hettich understands a repertoire of customized interior design solutions for residential and commercial spaces alike, we constantly endeavour to create unique pieces of art.



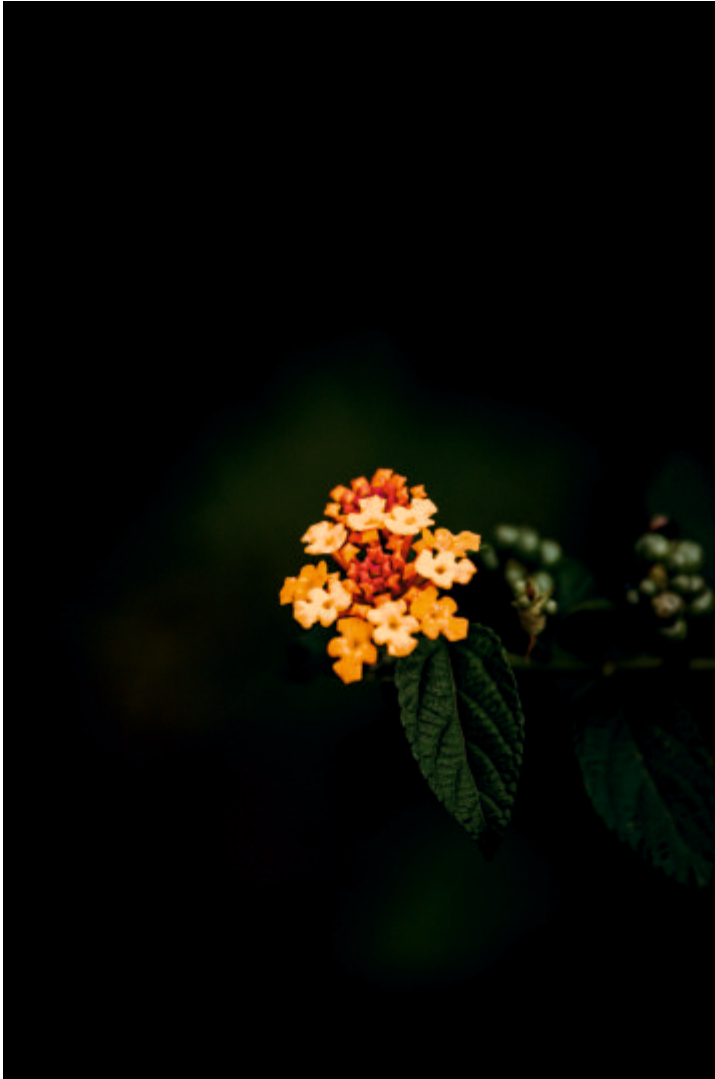

ADVANCED TECHNOLOGY, DISCREET LOOK

The system sets new standards in terms of practical convenience and straightforward installation, with a focus on exquisite design.

#luxuryredefined

'In todays life, luxury is
time and space.'



LIVERTA

A reflection of you in every dimension



luxury redefined

Living Room | Study Unit

A multi-disciplinary approach where working is fun and rhythmic with nature. This floor to ceiling concept of moving panels arouses your senses, and the experience you get is just fantastic.



FITTINGS USED

- TopLine XL K2- 2 door
- Lift mini
- ArciTech

CMF USED

- X White & Soft pine
- MDF & Acrylic strip
- Matte finish



Bed Room | Wardrobe

Floor to ceiling wardrobe units add visual opulence to the room. The synchronous movement of the shutters make you experience a theatrical display, happening right in front of you.



FITTINGS USED

- TopLine XL K2- 4 door
- ArciTech
- Calisia handle profile

CMF USED

- X White & Distressed oak
- MDF
- Matte finish



luxury redefined

Guest Room | Wardrobe

The clean sheen of the mirror reflects your beauty with the timeless approach of the interiors. Optimal storage to hide in suitcases, clothes and vanity boxes for quick access.



FITTINGS USED

- TopLine XL K2- 3 door
- ArciTech
- Lutetia handle profile

CMF USED

- Chestnut & Matt black
- MDF & Mirror
- Matte finish



Store Room | Art Storage

This versatile fitting, not only allows smooth performance but a transient approach to the space. It houses art materials, items which also should be kept under safe lock and key.



FITTINGS USED

- TopLine XL K2- 2 door
- AvanTech YOU
- Stabia handle profile

CMF USED

- Light fir & Gothic grey
- MDF
- Matte finish



luxury redefined

Living Room | Showcase

The shutters are arranged in such a way that they create an overall visual balance to the space. The use of large storage spaces allow you to showcase what you wish!



FITTINGS USED

- TopLine XL K2- 2 door
- ArciTech
- Rianza handle profile

CMF USED

- Chest nut & Dark grey
- MDF & Purple acrylic
- Glossy finish

TOPLINE XL K2

TECHNICAL DETAILS

- ▶ 2 track, top-running sliding door system
- ▶ Overlay door position
- ▶ For wooden doors
- ▶ Door weight up to 100 kg
- ▶ Door height up to 3000 mm
- ▶ Door width 600 - 2000 mm
- ▶ Door thicknesses 18-30, 22-30, 32-40
- ▶ Height adjustment +/- 3 mm, overlay adjustment +/- 10 mm
- ▶ Individually finished running components
- ▶ Fast clip on assembly with minimum screwing of runner & guide components
- ▶ Tested to EN 15706, Level 3

Door size and door weight

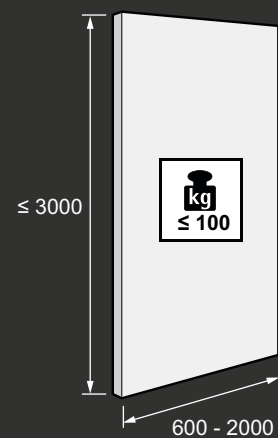

General Information

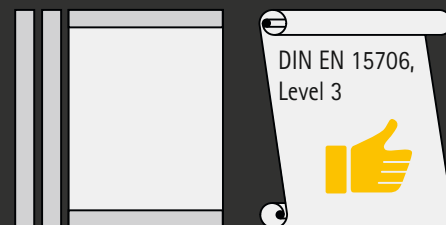

Number of door wings and door position / Silent System

Soft closing

2-door



Soft opening



3-door



4-door



Luxury like never before
Next generation sliding system for large wardrobes

01 | 3600 x 450 x 3000

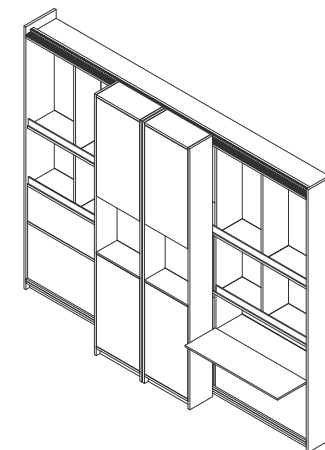

02 | 3800 x 600 x 3000

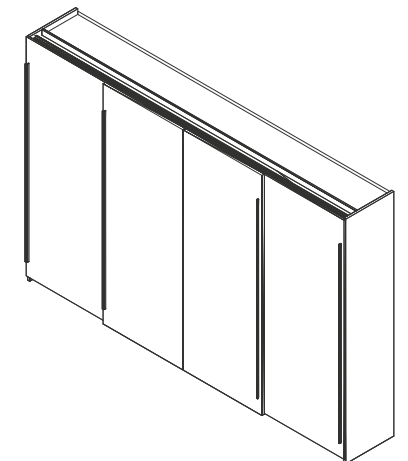

03 | 2800 x 600 x 2800

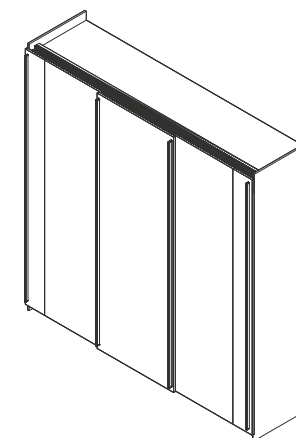

04 | 3600 x 600 x 3000

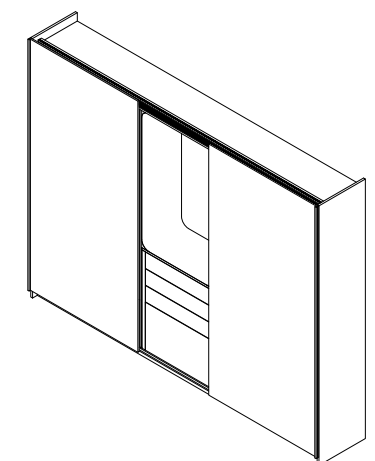

Installation Video



https://www.youtube.com/watch?v=UdnjW_GISRw

05 | 4000 x 450 x 3000

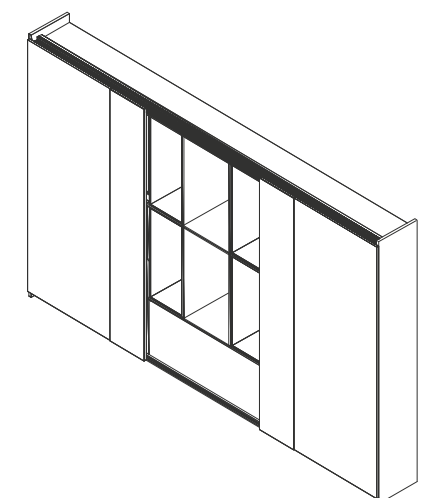



CONVENIENCE IN A NEW CLASS

Lets you create sliding doors in a new dimension: fascinatingly effortless sliding with a touch of purist perfection.

#luxuryredefined

‘Luxury lies in the richness of things, but in the absence of vulgarity.’



*Lifestyle & Inset image used are license free images from pexels.com

ADORA

Simple on the outside, luxurious on the inside



Bed Room | Wardrobe

These larger than life shutters slide and glide effortlessly. A simple touch, lets you access the insides with ease. The rough concrete with suede beige gives a touch of luxury in the making!



FITTINGS USED

- TopLine L- 3 door
- ArciTech
- Calisia handle profile

CMF USED

- Persian beige & Freckled concrete
- MDF
- Suede finish



luxury redefined

Kitchen | Pantry Unit

The hidden and seamless design makes it easier to adapt to the space. The interior houses, all of your kitchen groceries, appliances and snacks, which you crave for.



FITTINGS USED

- TopLine L- 2 door
- ArciTech
- Versa SuperPlus 60

CMF USED

- American chestnut & Gothic grey
- MDF
- Matte finish



Home Office | Study Unit

This Home Office overlooks a beautiful scape of high rise buildings; complementing it are the beautiful sliding shutters with maximum potential of office item storage.



FITTINGS USED

- TopLine L- 2 door
- SlideLine M
- Sliding door cylinder lock

CMF USED

- Royal beige & Walnut
- MDF
- Suede finish

LUCILLE

Head-turning in style

Bed Room | Wardrobe Cum Dresser

The bold lining of gold combines with a dresser, which further gives it meaning and function. This amethyst shade further woven with gold gives a very royal look, which pleases the senses.

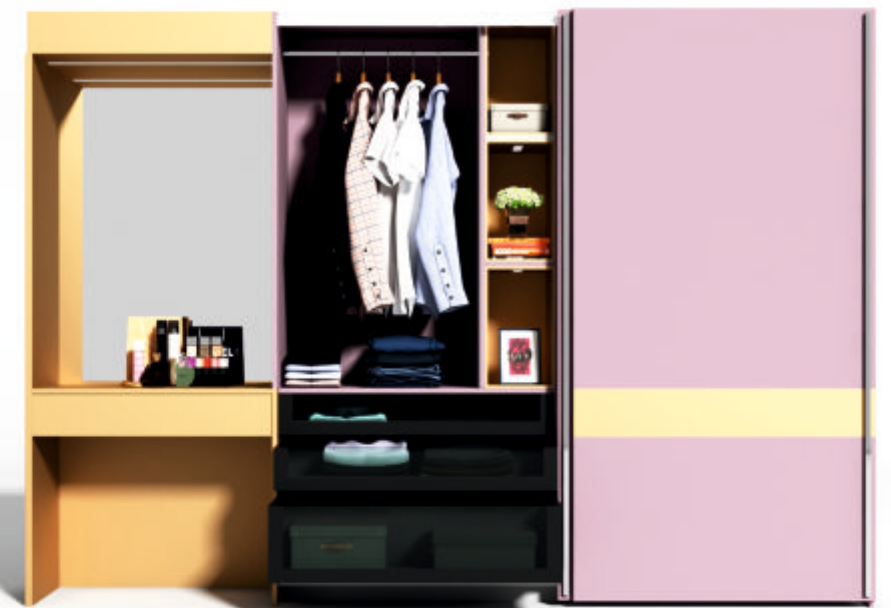

FITTINGS USED

- TopLine L- 2 door
- AvanTech YOU
- LuckyLite Pro

CMF USED

- Amethyst & Burnt gold
- MDF
- Glossy finish

luxury redefined



Kids Room | Study Cum Wardrobe

Kids want new, and new is unique! The light peach body blends well with children and complementing it is a bold purple finish, showcasing their personality.



FITTINGS USED

- TopLine L- 2 door
- AvanTech YOU
- Versa Plus 60

CMF USED

- Mellow mauve & Baby peach
- MDF
- Matte finish

TOPLINE L

TECHNICAL DETAILS

- ▶ 2 track, top-running sliding door system
- ▶ Overlay door position
- ▶ For wooden doors or wood
- ▶ Door weight up to 50 kg
- ▶ Door height up to 2600 mm
- ▶ Door width 550 - 1500 mm for 2 door & 550-1350 mm for 3 door
- ▶ Door thicknesses 10-50 mm
- ▶ Height adjustment +/- 3 mm
- ▶ Individually finished running components
- ▶ Two opening versions: flush or offset when using projecting handles
- ▶ Fast assembly of guide components
- ▶ Tested to EN 15706, Level 3

Door size and door weight

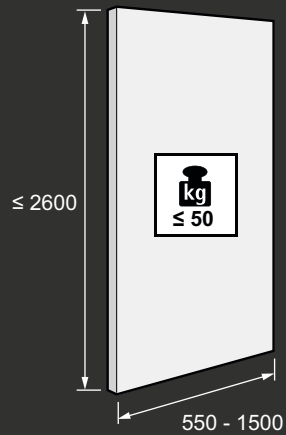

General Information

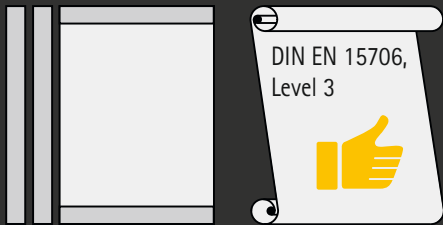

Number of door wings and door position / Silent System

Soft closing



Soft opening



Soft colliding



3-door



Comfort re-defined

Sliding system for heavy wardrobe doors

06 | 2700 x 600 x 2600

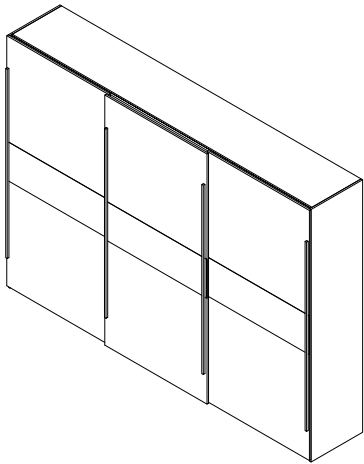

07 | 2400 x 600 x 2100

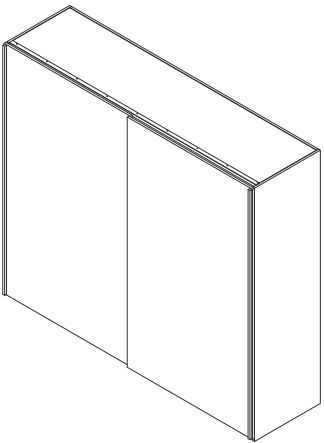

08 | 1800 x 600 x 2100

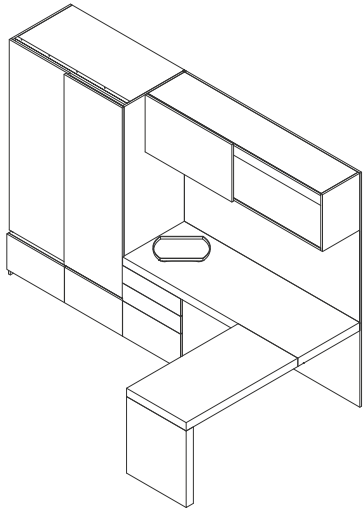

09 | 2400 x 600 x 2400

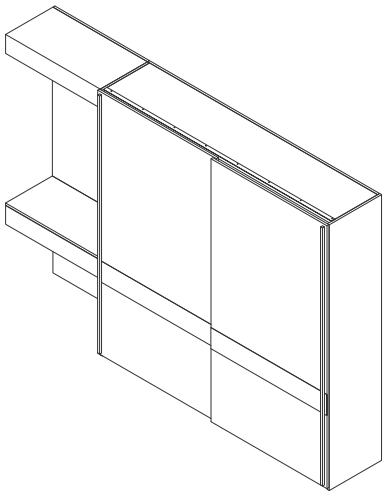

Installation Video



<https://www.youtube.com/watch?v=8VBixkEY8QA>

10 | 2100 x 600 x 2400

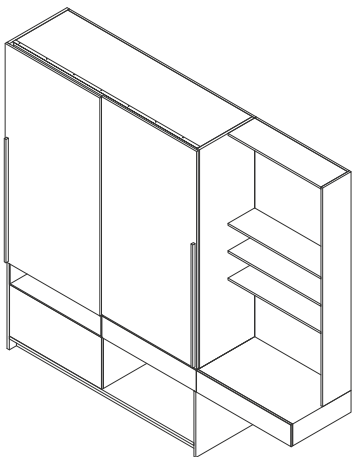



EXPERIENCE THE NEW WAY

**An impressive panorama effect!
Further highlights: optimised running
performance with design flexibility.**

#luxuryredefined

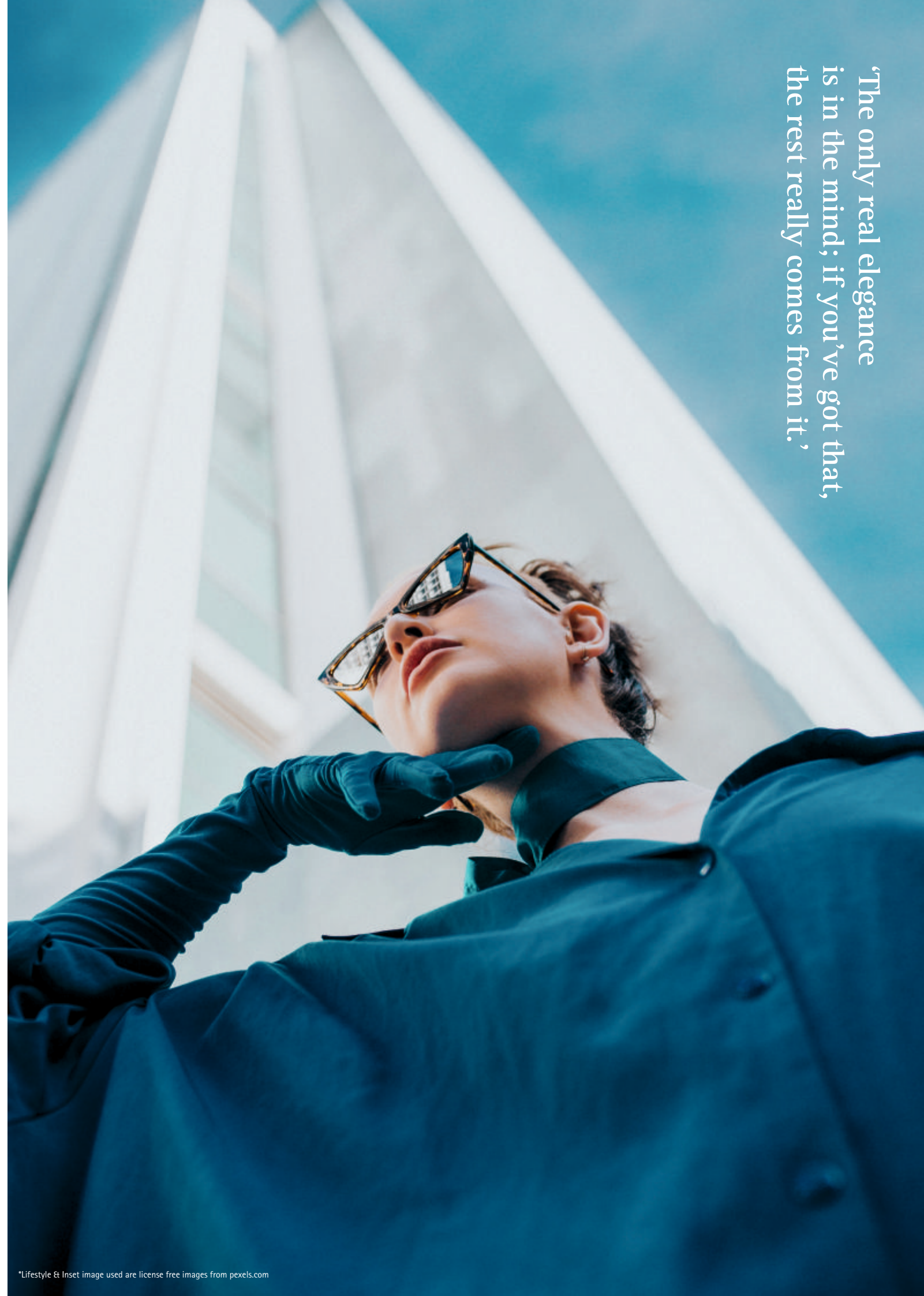

**'The only real elegance
is in the mind; if you've got that,
the rest really comes from it.'**



Bed Room | Wardrobe

These golden glazed wings mimic perfection. The panoramic view lets the user enjoy its beauty and in turn gives a pragmatic experience to the senses. The dark interiors bring a depth to the space and the cabinetry highlighting the items kept inside.



FITTINGS USED

- WingLine L, Push to move
- AvanTech YOU
- LED wardrobe tube

CMF USED

- Dutch gold & Matt black
- MDF
- Glossy finish



luxury redefined

Living Room | Storage Unit

The optimistic aura not only embodies the space but the people around it. The pure white gloss reflects the mood of a canvas, where creativity is yet to be unleashed. The subtle interiors with oak bands make the cabinetry wholesome to look at.



FITTINGS USED

- WingLine L, Push to move
- ArciTech
- Cargo pull out shelf

CMF USED

- X White & Gothic grey
- MDF
- Glossy finish



luxury redefined

Kitchen | Storage Unit

Immense storage with surprising faces, make it usable and functional from all sides. The dark exteriors blends well and makes an interesting partition concept within a kitchen. The open grids let you showcase embellished crockeries.



FITTINGS USED

- WingLine L, Push to move
- FreeSpace
- Versa Inside 60

CMF USED

- Aged oak & Matt black
- MDF
- Matte finish





luxury redefined

Vanity | Storage Unit

The simple three door arrangement let the user function with ease and patience. The internal divisions have been created in a way, where you have a hassle-free experience and rather enjoy the process as a whole.



FITTINGS USED

- WingLine L, Push to move
- ArciTech
- Cargo shoe rack horizontal

CMF USED

- X White & Gothic grey
- MDF & Mirror
- Matte finish



Staircase | Storage Unit

These gliding wings have a rather different approach than just to move. They create a cinematic effect, which not only highlights the exterior but the interior as well, letting you store your belongings with ease.



FITTINGS USED

- WingLine L, Push to move
- Obsidian hinge
- Quadro runner

CMF USED

- Star white & Matt black
- MDF & Wood
- Matte finish

WINGLINE L

TECHNICAL DETAILS

- ▶ For 1 folding door with 2
- ▶ Overlay door position
- ▶ For wooden doors
- ▶ Door panel weight up to 25 kg with 2 panels
- ▶ Door height up to 2400 mm
- ▶ Door panel width up to 600
- ▶ 3D adjustment: Height +- 3mm; Width +-2 mm; Depth +3 to -2 mm
- ▶ Tested with 40000 cycles

Door size and door weight

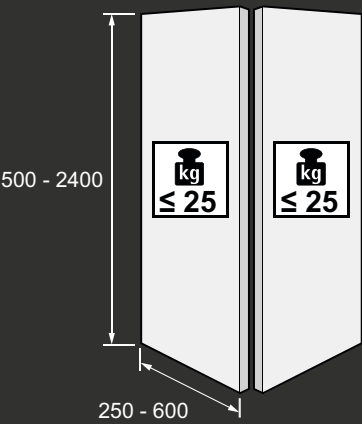

General Information

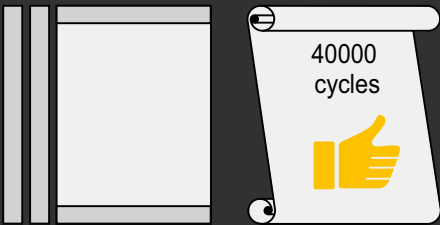

Number of door wings and door position / Opening assistance

2-door

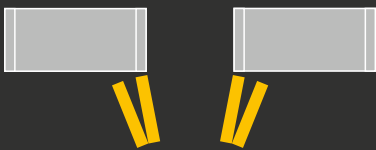

4-door

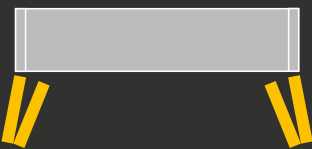

Push to move

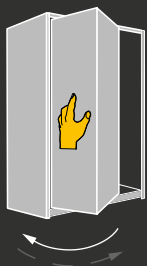

Pull to move

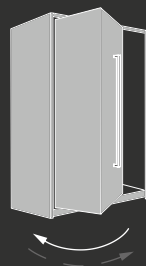

Pull to move silent

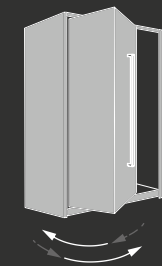

Panoramic convenience. Handleless perfection.

Sliding folding system for wardrobes with 2.4 metre wide opening

11 | 2400 x 600 x 2400

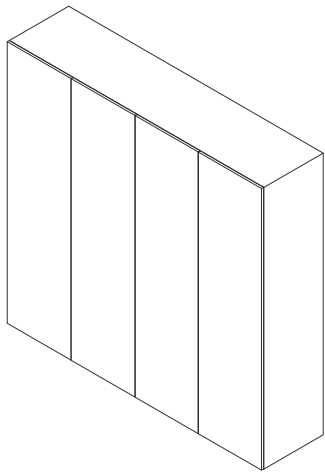

12 | 1800 x 600 x 2100

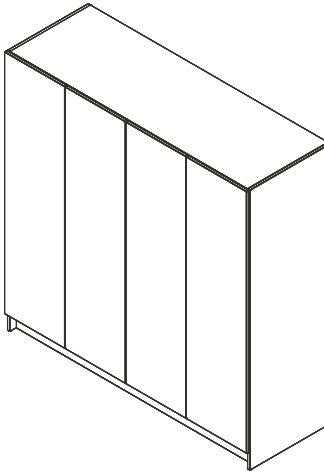

13 | 2000 x 600 x 2100

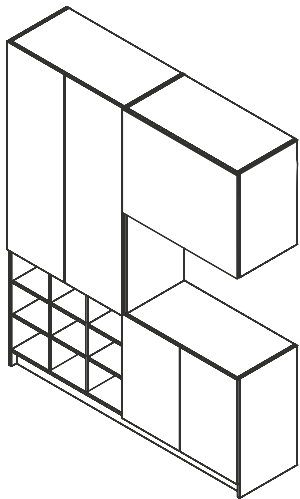

14 | 1800 x 600 x 2400

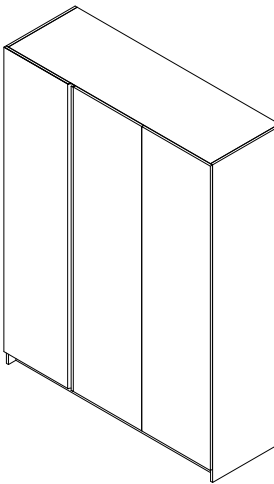

Installation Video



https://www.youtube.com/watch?v=CgsKo_6bKpc

15 | 1800 x 900 x 1800

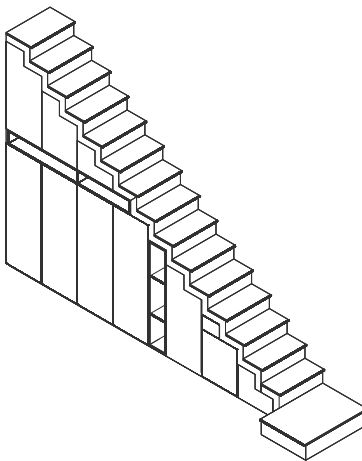



GENTLE IN LOOKS, QUIET IN ACTION

Retro fitting that can be used with
combination of different material
panels and a customisable approach.

#luxuryredefined

‘The end of a confusion,
premium is not luxury.’



*Lifestyle & Inset image used are license free images from pexels.com



Dining Room | Crockery Unit

A crockery unit is a spotlight and is one of its kind! The drinks and crockery compliment each other behind the all-glass shutters with a detail to delicacy and balance.



FITTINGS USED

- Grant 400 Neo- 3 door
- Versa Inside 120
- Actro runner

CMF USED

- Pale cantaloupe & Matt white
- Backpainted glass & Clear glass
- Matte finish



Living Room | Room Partition

The easy gliding floor to ceiling partition slides passionately with a smile on your face.. The large marble like shutters with black profiles gives a royal touch to the connecting space as well.

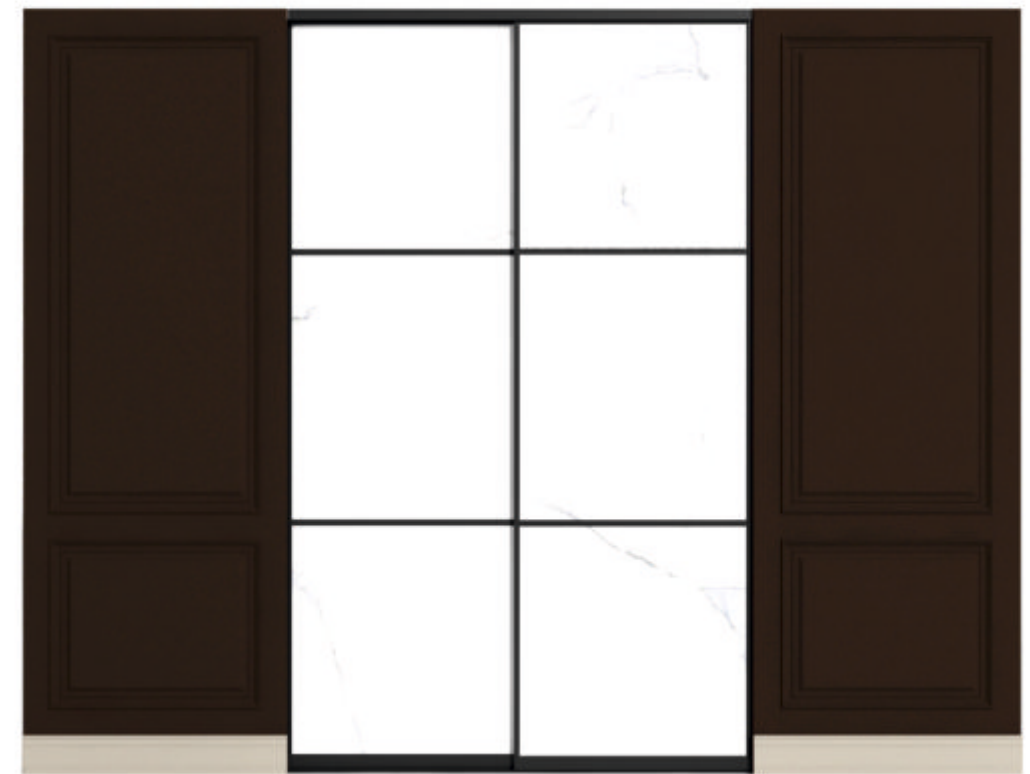

FITTINGS USED

- Grant 400 Neo- 2 door

CMF USED

- Staturio marble
- PVC laminate on MDF
- Glossy finish



Bed Room | Wardrobe

When elements and colour go hand in hand. The space complements the black profile used on the carcass, which gives the interiors a whole new look, feel and depth.



FITTINGS USED

- Grant 400 Neo- 3 door
- LED wardrobe tube
- AvanTech YOU

CMF USED

- Terra rosa & Matt black
- MDF & Mirror
- Glossy finish

CARTIER

Sophistication & luxury



Kids Room | Wardrobe

The sophistication of the pale blue panels bring out the center panel & adds depth and meaning to the interiors, which are used to store abundant toys, books and other essentials.



FITTINGS USED

- Grant 400 Neo- 3 door
- LED wardrobe tube
- Laundry basket

CMF USED

- Pale blue & Matt black
- MDF & Mirror
- Matte finish

GRANT 400 NEO

TECHNICAL DETAILS

- ▶ Twin track bottom running sliding partition door system
- ▶ Inset door position
- ▶ Max. door height 3500 mm
- ▶ Max, door width. 1200 mm
- ▶ Space required for profile installation 83 mm
- ▶ Max. door weight 50 kg/per door
- ▶ Soft opening & soft closing

Door size and door weight

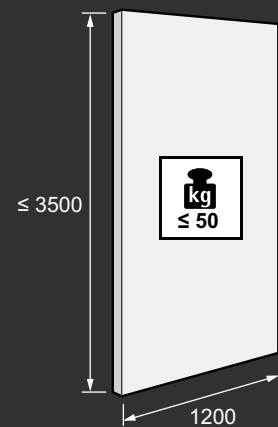

Door inset panel distribution (Vertical)

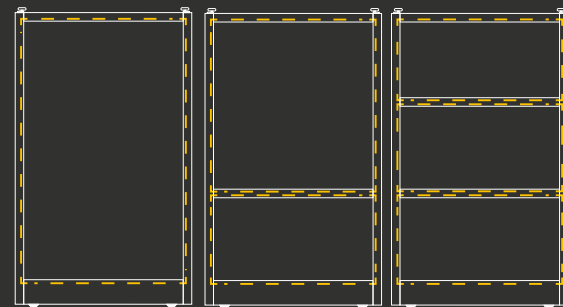

Number of door wings and door position

1-door

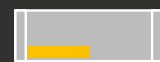

2-door



3-door

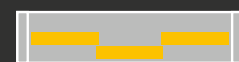

Designed for versatility & creative flexibility
Versatile floor to ceiling sliding system with soft opening & soft closing

16 | 2400 x 500 x 3500

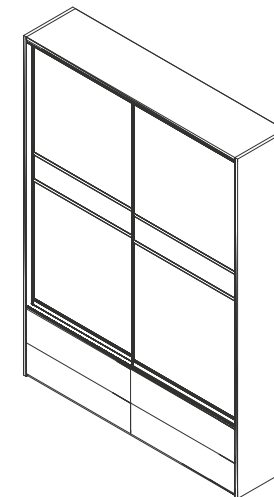

17 | 2700 x 600 x 3000

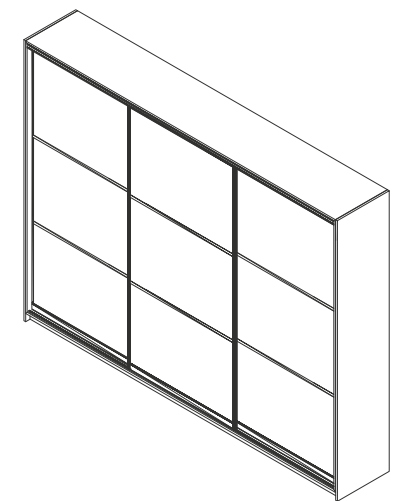

18 | 1800 x 115 x 3500

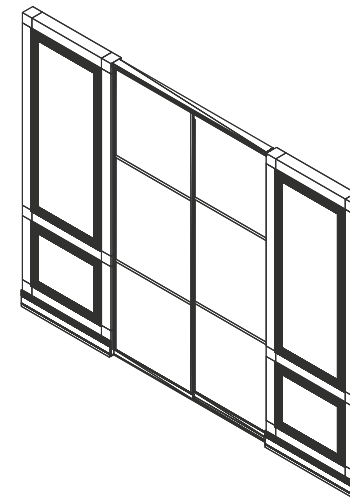

19 | 2700 x 600 x 3000

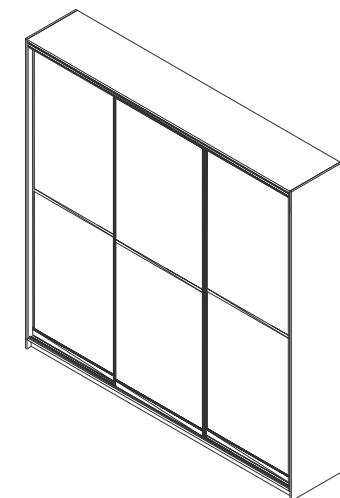

Installation Video



https://www.youtube.com/watch?v=kQ0R9VWk_so

20 | 2700 x 600 x 3000

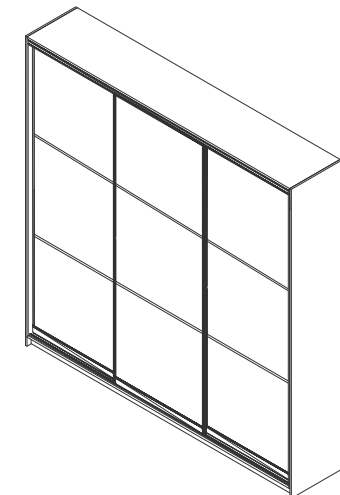

This image shows a full page of blank graph paper. The grid consists of thin, light gray horizontal and vertical lines that intersect to form small squares across the entire surface. There are no margins, text, or other markings on the paper.

This image shows a single page of white paper with horizontal ruling lines. The lines are evenly spaced and run across the width of the page. There are no margins, text, or other markings on the paper.

