

IDEABOOK
SlideLine M





Warranty

For Warranty
please refer to website.
www.hettich.com/in



Free Design Service:

Looking for Designs to liven up your Living Room, Bedroom, Bathroom & Kitchen. A dedicated team of highly qualified Interior Designers is at your service to provide customised design solution to suit every taste and budget at zero cost to you.

Free Consultation at your doorstep:

Looking for perfect Furniture Fittings solution. A dedicated team of highly qualified professionals is at your service to provide the perfect furniture fittings solution to suit your need and budget at zero cost to you.

Hettich Customer Care Service:

In today's fast paced and technologically advanced era, most of the organizations succumb to the pressure of staying ahead in the competition and often, end up neglecting the most critical aspect of business i.e. CUSTOMERS. Hettich, being a CUSTOMER CENTRIC organization, is very sensitive towards this tendency; hence, we constantly try to provide the best and quality driven products and services.

For Enquiry & Customer Services

Toll Free : 1800 209 2096 (office hours)
Email: sales_enquiry@in.hettich.com
customer_services@in.hettich.com
www.hettich.com



Free Training Services:

Free Training Services for carpenters of trade partners and customers

Training Center Address:

Hettich Poddar Wood Work Institute
Plot No.2, First Floor,
DLF Industrial Estate - 1
Near NHPC Metro Station
Faridabad, Haryana

Email: info@hpwwi.com
Ph: 0129 - 4203888

Hettich – an Indian success story

Hettich started operations in India with the dawn of the new millennium. Within a span of 18 years, the company has gained the undisputed leadership position in the Indian furniture fittings & hardware industry.

Hettich India prides itself on having most of the major hardware dealers in India as its trade partners across the country. These dealers are spread over all the important cities and towns, so that they are within easy reach of the customer. Hettich India delivers complete "peace of mind" to the Indian furniture manufacturing industry.

We have a strong reputation for providing high quality and high tech products. Our products are backed by pre- and after-sales service and on-time deliveries, and by value adding services like design and installation support.

The company's origins date back to 1888, when Karl Hettich began making the new clock component he had invented. By 1930, his descendants had diversified into furniture fittings, setting up production in East Westphalia – a center of the German furniture industry.



Hettich Manufacturing Unit at Indore, India

Prolouge

It's your ideas that decide SlideLine M turns simple shelf units into attractive pieces of practical furniture with a look that can be varied all the time: moving the doors to different positions creates ever changing constellations of open and closed elements. This gets things moving in furniture design. And never fails to please. It's your ideas that decide. Discover the wealth of applications for SlideLine M.

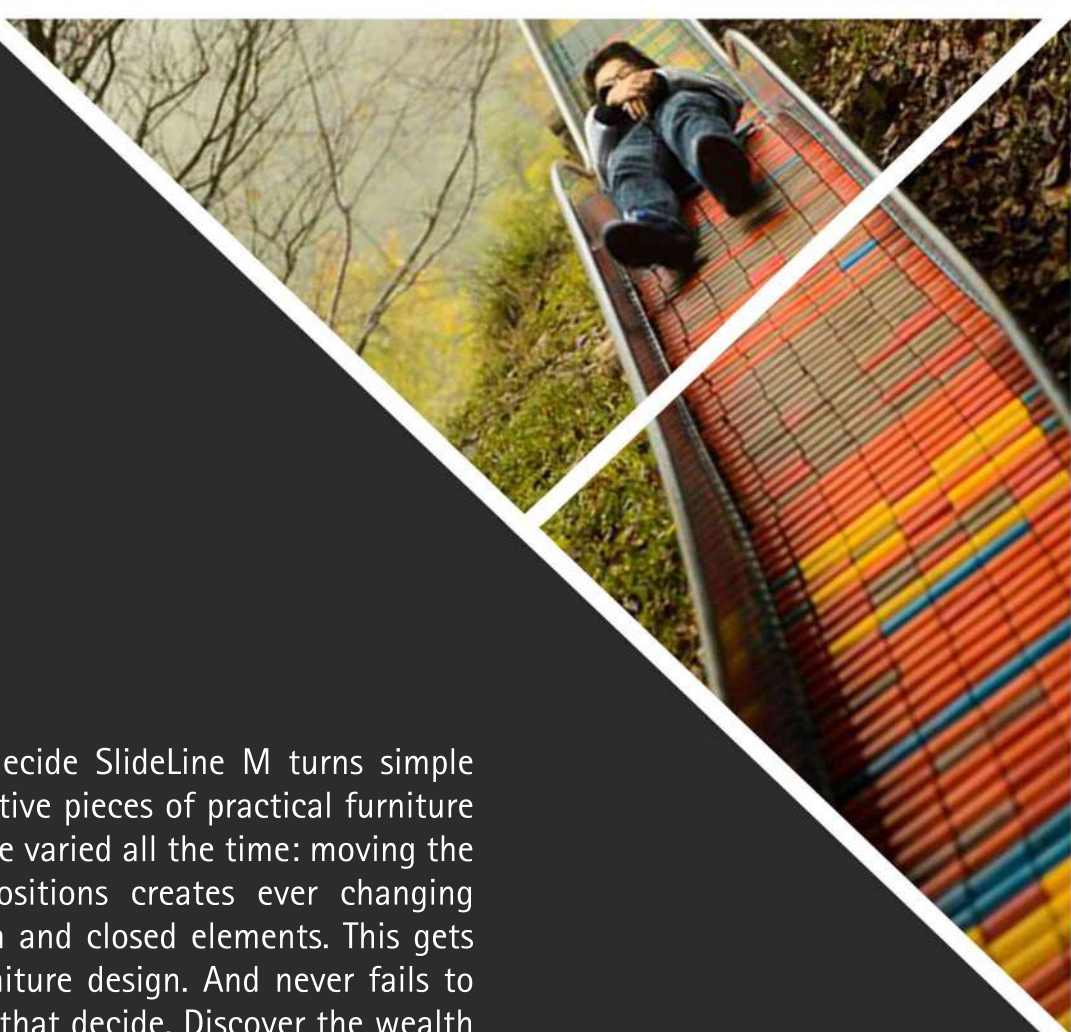

SLIDE IT

LOVE IT

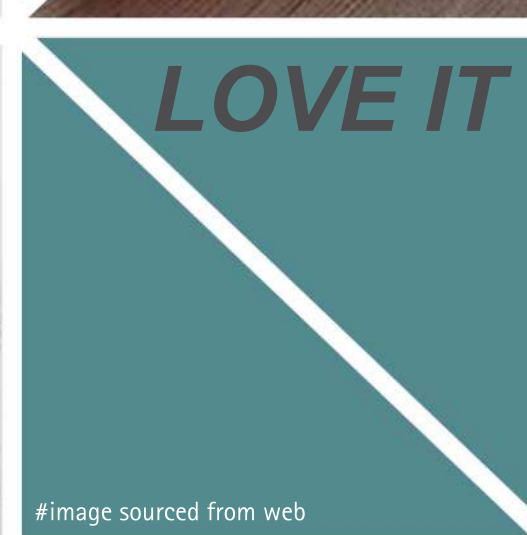

#image sourced from web



Slide it. Love it.

People like to keep it simple. On their tablet PCs. On their smart phones. The revolutionary aesthetic appeal of virtual sliding fascinates millions: gentle, flowing movement, simply at the touch of a finger.

But sliding in the real world is captivating more and more people: cars that provide real practical value come with a sliding door; a sliding sunroof creates a sensation of openness and space, and at home there we are sliding panel curtains and doors, whether as room dividers or on furniture.

The trend towards sliding is also opening new doors for you: Hettich gives you sliding door systems that go perfectly with your furniture ideas. For bedroom, living room, office and kitchen furniture





Design in motion

SlideLine M upgrades the practical value and design of furniture: living room units and shelf systems, kitchen wall units, bathroom furniture and office cabinets. The versatile system is ideal for all common furniture constructions. Wooden / glass or aluminium framed door weighing up to 30 kg can be installed quickly and easily. Profiles are available for several shelf thicknesses.

Letting doors slide past each another in one profile isn't a problem either. The Silent System is integrated in the running component and slows doors down in closing, opening and colliding direction.



SlideLine M-Overlay

Door format and door weight

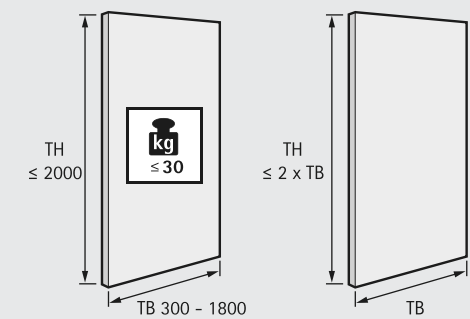

TB	300	400	500	600	700	800	900	1000	...	1800
TH ≤	600	800	1000	1200	1400	1600	1800	2000	...	2000

Technical details:

- ▶ 1-track, bottom running sliding door system
- ▶ Wooden, glass or aluminum framed doors
- ▶ Door weight up to 30 kg
- ▶ Door height up to 2000 mm
- ▶ Door width from 300 - 1800 mm
- ▶ Shelf thicknesses 15, 16, 18, 19, 22, 25 mm
- ▶ +/- 2 mm height adjustment
- ▶ Silent System in closing, opening and colliding direction
- ▶ Tool-less fast installation of the front panel

Number of door wings and door position



SlideLine M-Inset

Door format and door weight

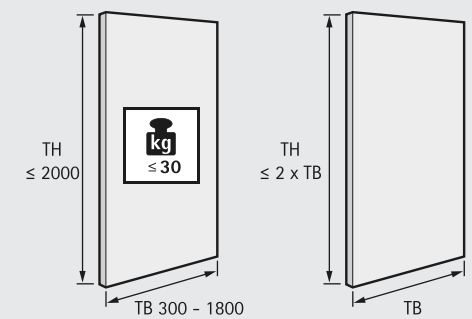

TB	300	400	500	600	700	800	900	1000	...	1800
TH ≤	600	800	1000	1200	1400	1600	1800	2000	...	2000

Technical details:

- ▶ 1-track or 2-track bottom-running sliding door system
- ▶ Wooden, glass or aluminium framed doors
- ▶ 2-door or 3-door application
- ▶ Runner and guide profile for screwing on or pressing in
- ▶ Door weight up to 30 kg
- ▶ Door height up to 2000 mm
- ▶ Door width from 300 - 1800 mm
- ▶ +/- 2 mm height adjustment
- ▶ Silent System in closing, opening and colliding direction
- ▶ Door quickly mounted without the need for tools

Number of door wings and door position

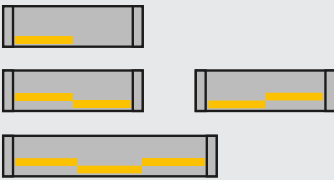

Installation- Overlay

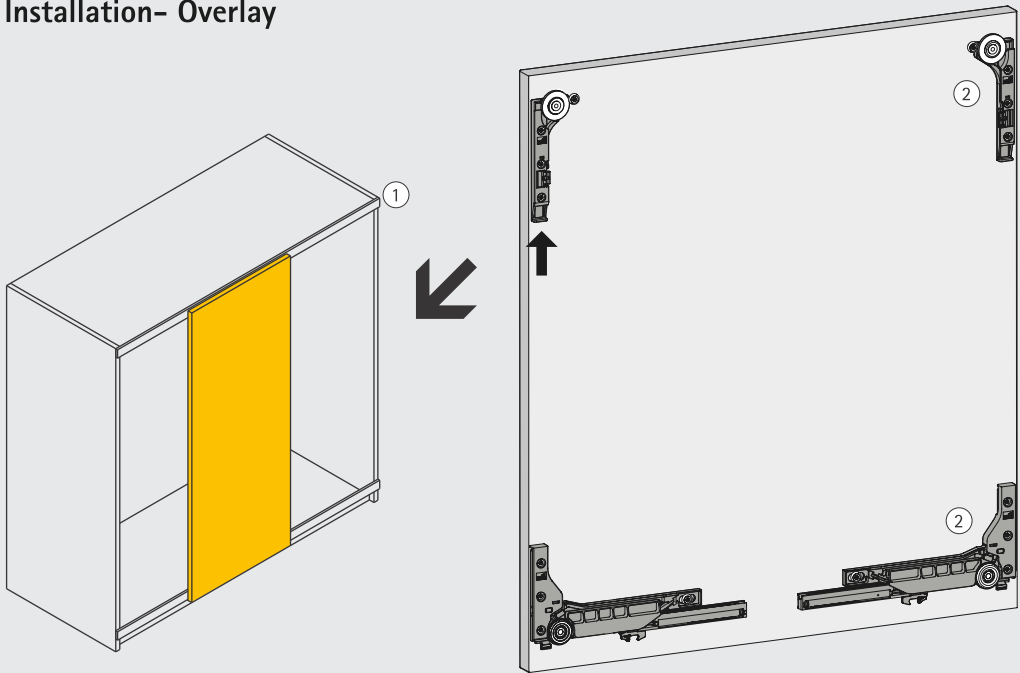

Scan QR to get precise technical details of overlay

1. Runner profile set
2. Set of fittings for doors with Silent System

Installation- Inset

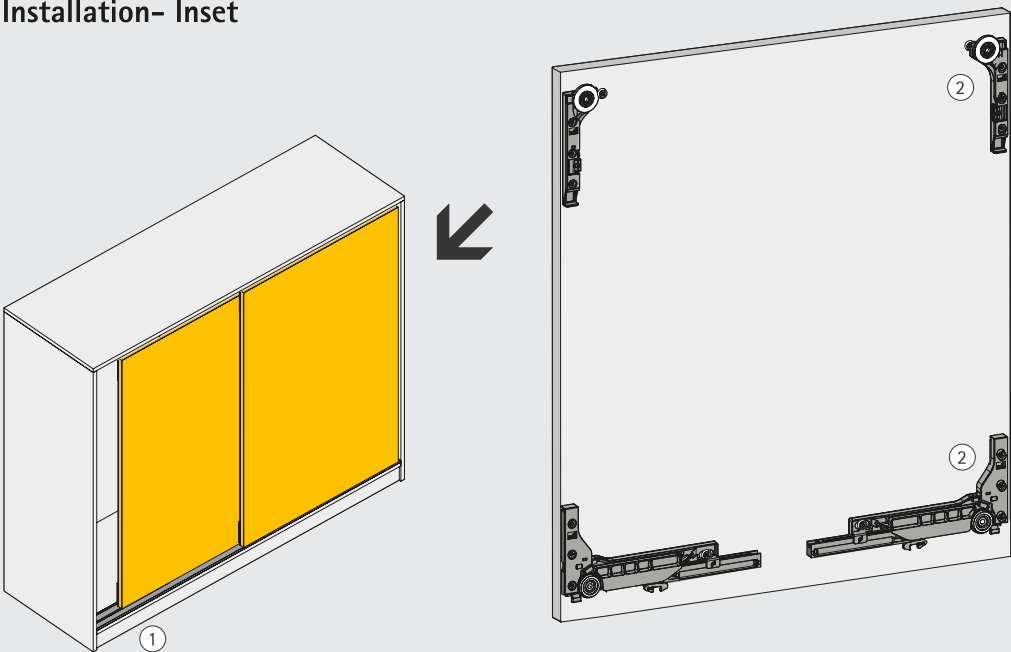

Scan QR to get precise technical details of inset

1. Runner profile set- 2 track
2. Set of fittings for doors with Silent System





Secret Love

Center piece of the room with several benefits and hidden space.

#livingroom #centretable



CONCEPT

Our mood is the source of our happiness, it decides what to do at what moment. Simply change your mood by sliding mechanism. Now the bar will be the center of attraction of all the guests.

ADVANTAGES

- Hidden space.
- Create ambience.
- Dual functioning.

FITTING USED

- SlideLine M
- AvanTech YOU

CMF USED

- Black
- Wood & Glass
- Glossy finish



#studyroom #workingcorner



CONCEPT

Work from home! It's the best feeling in the world. Having loved ones around us, good cooked food and a healthy environment which will give your productivity a boost.

ADVANTAGES

- More accessibility.
- Everything at one place.
- See only, what you need.

FITTING USED

- SlideLine M
- CUBE

CMF USED

- Black
- Wood
- Matte finish



Time Savior

A great companion with varied options which are light & spacious.

Friends Forever

Innovative storage space,
comfortable and convenient
for more spacious bathroom.



#washroom #vanity



CONCEPT

Washroom is not just to bath but, its a relaxing space, for little more care and more time to look at your self and decide what to do make your day better, when all you need is at one place.

ADVANTAGES

- Two sided uses.
- Eye catching design.
- More space.

FITTING USED

- SlideLine M
- Glass Hinge

CMF USED

- Grey
- Wood & Glass
- Matte finish



#hallway #decorunit



CONCEPT

It's well said, the first impression is the last impression, give everyone a everlasting experience of your home in their first meeting.

ADVANTAGES

- Organized space.
- Use what u need.
- Minimal design.

FITTING USED

- SlideLine M
- CUBE

CMF USED

- Black & Yellow
- Wood
- Matte finish



Pretentious

An innovative idea for your home
which gives a great
first impression & utility.



Ling Bushel

Reflect your style with intelligent and personalized solutions well organized.



#livingroom #bookshelf



CONCEPT

The uniqueness of this design is, its lines and Z pattern as its sleek and Fluent which in turn allows a single pattern with sliding the shutter and enhances the ease of working with SlideLine M in bookshelf.

ADVANTAGES

- Sleek bookshelf.
- Smooth sliding.
- Enough storage and counter.

FITTING USED

- SlideLine M

CMF USED

- Grey & Green
- Wood
- Matte finish



#studyroom #sideboard



CONCEPT

Combining lines and shapes within a unit with storage and seamless design with geometrical patterns which itself serves as multi functional unit at space for study room with sliding and hiding feature in the side board.

ADVANTAGES

- Seamless side board.
- Smooth functioning.
- Storage and decor.

FITTING USED

- SlideLine M

CMF USED

- White & Green
- Wood
- Matte finish



Drive Element

A useful piece of furniture with functional & visual benefits and more organized.





Azimuth Study

Space saver and
flexibility with
interactive.

#kidsroom #storageunit



CONCEPT

The minimal geometric lines are played in a manner that it gives the perfect combination of aesthetic and functional design well single shape has been played within a table and a with sliding function for a playful and convenience activity at kids room.

ADVANTAGES

- Sleek symmetrical table.
- Smooth functioning.
- Playful and interactive furniture.

FITTING USED

- SlideLine M

CMF USED

- Blue
- Wood
- Matte finish



#hallway #decorunit



CONCEPT

The entryway is first impression for your guests which impacts an impression of design in straight bright lines within the hide and seek concept of storage and décor with sliding functioning.

ADVANTAGES

- Seamless shelf for hallway.
- Smooth functioning.
- Enough storage and aesthetic appeal.

FITTING USED

- SlideLine M

CMF USED

- Green & Blue
- Wood
- Matte finish



Glide Hide

Feel comfortable with
pretty and practical
functional perfect.



Impressive WFH Office

Well organized and
creating an uncluttered
workspace.

#homeoffice #studyunit



CONCEPT

This workstation is a perfect buddy for your work needs. Create a convenient workspace with study tables which add a touch of style to your home and office with sliding system comfortable study and work station.

ADVANTAGES

- More accessibility.
- Everything at one place.
- See only, what you need.

FITTING USED

- SlideLine M
- CUBE

CMF USED

- White
- Wood
- Matte finish



#bedroom #dressing



CONCEPT

One can use SlideLine M in their dressing area as its move on track horizontally without disturbing any other space and it looks esthetically beautiful.

ADVANTAGES

- Sleek look.
- Seamless finish.
- Enough storage.

FITTING USED

- SlideLine M
- Quadro Push to open runner

CMF USED

- Grey & White
- Wood & Glass
- Glossy finish

Mirror Lover

Extra bedroom storage with luxurious addition and completely organized.



Simple & Significant

Highly functional
with easily portable
and flexible.



#livingroom #sidetable



CONCEPT

Everyone want their livingroom to look neat and usually tries to hide the things which the use a lot but don't want to mess their livingroom beauty.

ADVANTAGES

- Hidden space.
- Create ambience.
- Dual functioning.

FITTING USED

- SlideLine M
- LuckyLite Pro

CMF USED

- Black
- Wood & Glass
- Glossy finish



#livingroom #displayunit



CONCEPT

Functionality and aesthetics are main key elements of a trendy and perfect display cabinet for residential purpose. Minimal geometric shapes and colors played in a manner that it gives the perfect combination of function and design.

ADVANTAGES

- Maximum utility.
- Simple and sleek look.
- Smooth functioning.

FITTING USED

- SlideLine M

CMF USED

- Black & Orange
- Wood & Glass
- Matte finish



Pure Certainty

Creates storage space with aesthetically pleasing and keep your valuable belongings.





The Cocoon

Savings in time with modern furniture and storage space.



#livingroom #barcabinet



CONCEPT

A furniture which allowing your bar to be in a compact form. SlideLine M allows to hide the whole cabinet and enhance it's sleek to and beauty towards home environment.

ADVANTAGES

- Sleek look.
- Seamless finish.
- Enough storage.

FITTING USED

- SlideLine M

CMF USED

- Grey & Yellow
- Wood
- Matte finish



#homeoffice #storageunit



CONCEPT

An classic desk with storage unit ensures a home office to that is all about work and comfort.

ADVANTAGES

- Work extension.
- Sectional storage.
- Smooth functioning.

FITTING USED

- SlideLine M

CMF USED

- Grey
- Wood
- Matte finish



Moderate

Well organized with improving operational efficiency and creating an uncluttered workspace.

Perpectual Pout

Inaccessible storage with cleaner kitchen and spacious & more beautiful.



#kitchen #overhead



CONCEPT

Open doors on wall units are not likely to leave you injured. Sliding doors are also easy to open without stretching or dodging out of the way.

ADVANTAGES

- Aesthetically beautiful.
- Smooth functioning sliding door.
- More convenience.

FITTING USED

- SlideLine M
- AvanTech YOU

CMF USED

- White
- Wood
- Matte finish



#kidsroom #storageunit

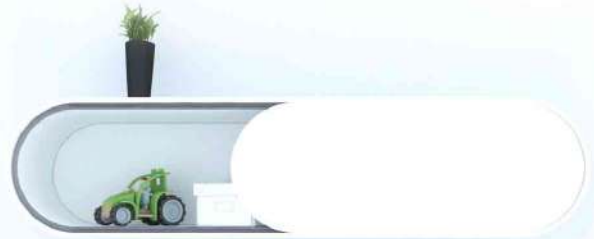

CONCEPT

An interactive wall console unit in your kids bedroom. A simple play of juxtaposition of reality and the virtual world. Inspired by the toggle switch used in our mobile applications and mobile phones.

ADVANTAGES

- Playful.
- Ample storage.
- Smooth.

FITTING USED

- SlideLine M

CMF USED

- White & Green
- Wood & Bent ply
- Glossy finish



Toggle

Space equivalents status with creativity and imagination and boundaries and organization.



Sumptuous

Display your personality
with easy to access
and great Appeal.

#livingroom #storageunit



CONCEPT

An living room furniture that comprises of complete storage space. With an extra ordinary sleek finish by SlideLine M making the doors move smoothly in one touch. Thus the best option is served to you in the best aesthetics.

ADVANTAGES

- Organized storage.
- Aesthetic appeal.
- Smooth functioning.

FITTING USED

- SlideLine M

CMF USED

- Dusty Plum
- Wood
- Matte finish



#livingroom #barunit



CONCEPT

The circle cut out depicts a moon embodied by a noisy blue tinted glass texture. Making a perfect spot for premium bottles of alcohol in your living room.

ADVANTAGES

- Spotlight area.
- Minimal aesthetics.
- Ample storage.

FITTING USED

- SlideLine M

CMF USED

- Black & Grey
- Wood & Glass
- Glossy finish

Full Moon

Storage at the forefront with versatility is top-notch and multi-utility serves for the longer time.



Lig Lag

Beautiful look with incredible flexibility and well designed shelves.



#diningroom #storageunit



CONCEPT

Wall hung unit made for the contemporary. Making perspective a bit more fun. Simple play of lines with minimal construction.

ADVANTAGES

- Ample storage.
- Different mounting options.
- Tapered access.

FITTING USED

- SlideLine M

CMF USED

- White & Brown
- Wood
- Matte finish



#livingroom #tvunit



CONCEPT

Entertainment a slide away. When its there but actually it is not there. Hide & Slide design let you make your living area aesthetically beautiful with ample storage and accessibility area using SlideLine M.

ADVANTAGES

- Strength and durability.
- A decor staple.
- Ample storage.

FITTING USED

- SlideLine M
- Quadro Push to open runner

CMF USED

- Grey
- Wood
- Matte finish



Cozy Connection

Enhance your indoor space with style statement of your home and efficient way to save floor space.



Kick

Easy accessibility with easy to access and well-arranged and clean.

#hallwayentry #shoerack



CONCEPT

Giving footwear their true place in a truly eccentric way. A new and a different take on a shoe cabinet. Utilising corners by giving ample storage space. No need to bend anymore. Just glide the shutters with a soft kick to access your most prized possessions.

ADVANTAGES

- Aesthetic.
- Ample footwear storage.
- Seating area.

FITTING USED

- SlideLine M

CMF USED

- White
- Bamboo sheet & Bent ply
- Shutter Glossy & Cabinet Matte finish





*It's your ideas
that decide!*

SlideLine M turns simple shelf units into attractive pieces of practical furniture with a look that can be varied all the time: moving the doors to different positions creates ever changing constellations of open and closed elements. This gets things moving in furniture design. And never fails to please. It's your ideas that decide. Discover the wealth of applications for SlideLine M.



Designer's Note

This idea-book we composed during covid19 lockdown period in month of April 2020. Today we are facing an unprecedented problem, having indefinable dimensions and consequences, which has never been encountered ever before. Noval Corona Virus "Covid 19" is created by the nature, the enemy is neither seen nor visible, nobody has any idea even about its DNA or antidote.

While need of the hour is to be physically distant we peacefully worked from home and still we remain socially connected with our family, friends and the loved ones by using our phone, email, video conferencing, we also come up with new idea-book for Hettich fitting SlideLine M, you witnessed.

Now way of designing and sales will change quite substantially. And we are prepared to embrace them all. Hope this idea-book will open some thought to support our customers and empowering architects and designers.

Also please take good care of your health. We wish you all and your families robust health and long life, Stay Healthy. Stay Safe.



SLIDE IT

LOVE IT

#image sourced from web



IDEABOOK

SlideLine M